

REAR CENTER SEAT INNER BELT ASSEMBLY

COMPONENTS

SB

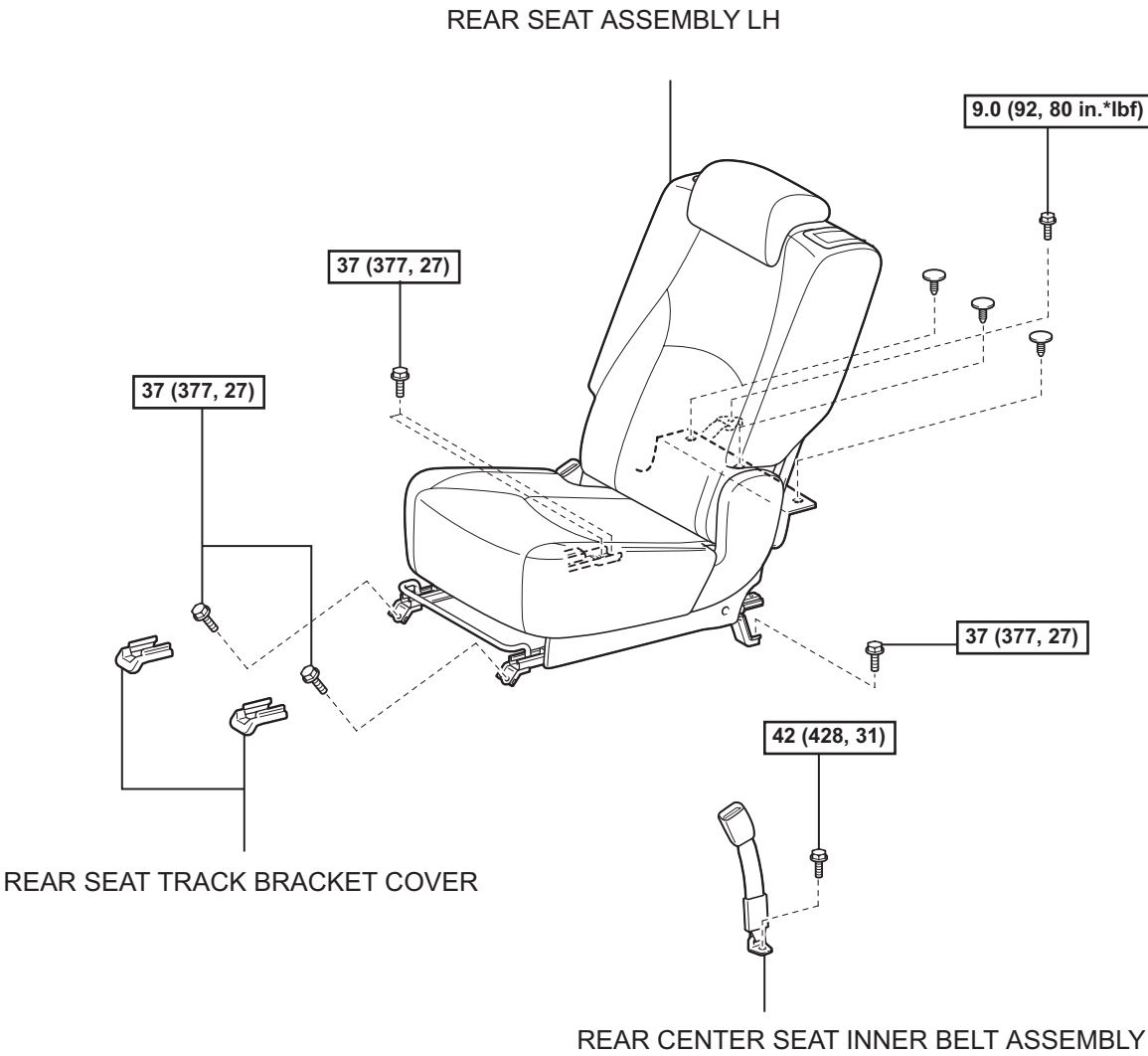

N*m (kgf*cm, ft.*lbf) : Specified torque

REMOVAL

1. REMOVE REAR SEAT TRACK BRACKET COVER
(See page [SE-50](#))
2. REMOVE REAR SEAT ASSEMBLY LH (See page [SE-50](#))
3. REMOVE REAR CENTER SEAT INNER BELT ASSEMBLY
 - (a) Remove the bolt and rear center seat inner belt assembly.

