

FRONT SEAT OUTER BELT ASSEMBLY

COMPONENTS

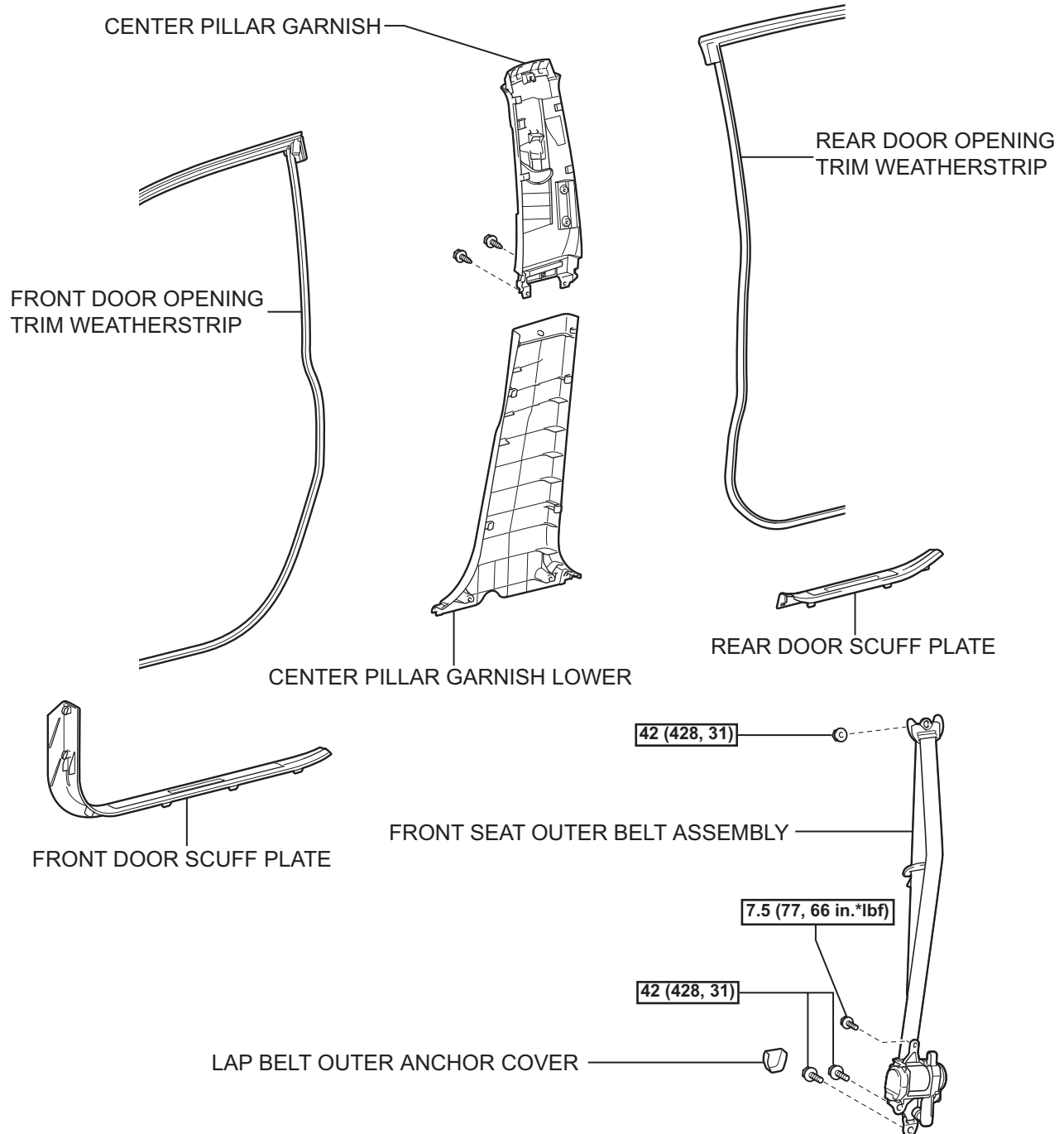

N*m (kgf*cm, ft.*lbf) : Specified torque

SB

REMOVAL

1. **DISCONNECT CABLE FROM NEGATIVE BATTERY TERMINAL**

CAUTION:

Wait for 90 seconds after disconnecting the cable to prevent the airbag working (See page [RS-1](#)).

2. **REMOVE FRONT DOOR SCUFF PLATE** (See page [IR-6](#))
3. **REMOVE FRONT DOOR OPENING TRIM WEATHERSTRIP**
4. **REMOVE REAR DOOR SCUFF PLATE** (See page [IR-6](#))

5. **REMOVE REAR DOOR OPENING TRIM WEATHERSTRIP**

6. **REMOVE LAP BELT OUTER ANCHOR COVER**
 - (a) Disengage the 2 claws and remove the lap belt outer anchor cover.

7. **DISCONNECT FRONT SEAT OUTER BELT ASSEMBLY**

- (a) Remove the bolt and disconnect the floor side of the front seat outer belt assembly.

8. **REMOVE CENTER PILLAR GARNISH LOWER** (See page [IR-7](#))

9. **REMOVE CENTER PILLAR GARNISH** (See page [IR-7](#))

10. **REMOVE FRONT SEAT OUTER BELT ASSEMBLY**

- (a) Turn the ignition switch to the Lock position.
 - (b) Remove the nut and disengage the shoulder side of the front seat outer belt assembly.

- (c) Using a screwdriver, pull out the locking button in the direction shown by the arrow to release the lock, and disconnect the pretensioner connector.

HINT:

Tape the screwdriver tip before use.

- (d) Disconnect the tension reducer connector.

- (e) Remove the 2 bolts and front seat outer belt assembly.

SB

