

Fuel Gauge

Gauge Test

NOTE: Refer to page 16-77 for wiring description of the fuel gauge circuit.

1. Remove the maintenance access cover in the luggage area.

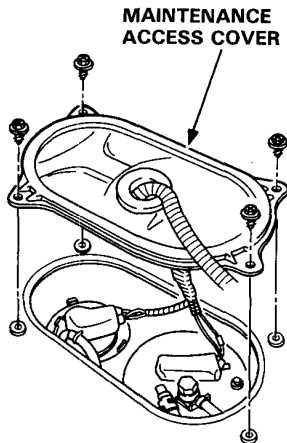

2. Disconnect the 3-P connector from the sending unit.

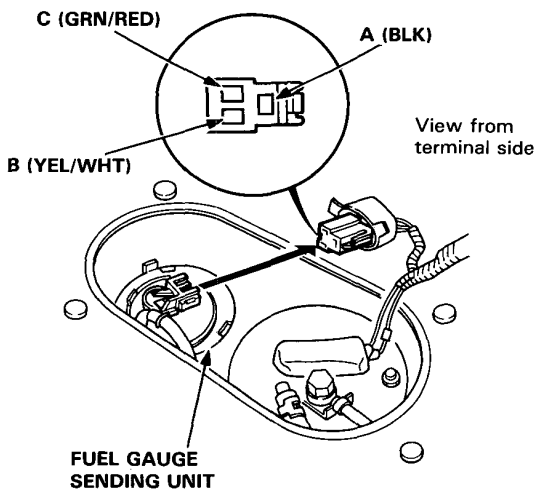

3. Connect the voltmeter positive probe to the B (YEL/WHT) terminal and the negative probe to the A (BLK) terminal, then turn the ignition switch ON. There should be battery voltage.

- If the voltage is specified, go to step 4.
- If the voltage is not specified, check for:
 - Blown No.13 (7.5 A) fuse in the dash fuse box.
 - An open in the YEL, YEL/WHT or BLK wire.
 - Poor ground (G404 or G701).

4. Turn the ignition switch OFF. Attach a jumper wire between the B (YEL/WHT) and A (BLK) terminals.
5. Turn the ignition switch ON. Check that the pointer of the fuel gauge starts moving toward "F" mark.

CAUTION: Turn the ignition switch OFF before the pointer reaches "F" mark on the gauge dial. Failure to turn the ignition switch OFF before the pointer reaches the "F" mark may cause damage to the fuel gauge.

NOTE: The fuel gauge is a bobbin (cross coil) type, hence the fuel level is continuously indicated even when the ignition switch is OFF, and the pointer moves more slowly than that of a bimetal type.

- If the pointer of the fuel gauge does not swing at all, replace the gauge.
- Inspect the fuel gauge sending unit if the gauge is OK.



Sending Unit Test/Replacement

WARNING Do not smoke while working on fuel system. Keep open flame away from work area.

1. Remove the maintenance access cover in the luggage area.
2. Check that the ignition switch is off, then disconnect the 3-P connector and the breather hose from the fuel gauge sending unit.
3. Remove the fuel gauge sending unit.

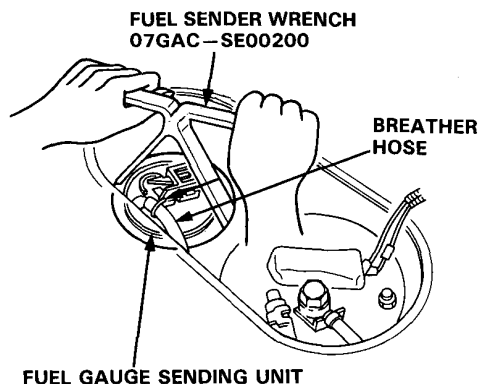

4. Measure the resistance between the A and B terminals at E (EMPTY), 1/2 (HALF FULL) and F (FULL) by moving the float.

Float Position	E	1/2	F
Resistance (Ω)	105–110	25.5–39.5	2–5

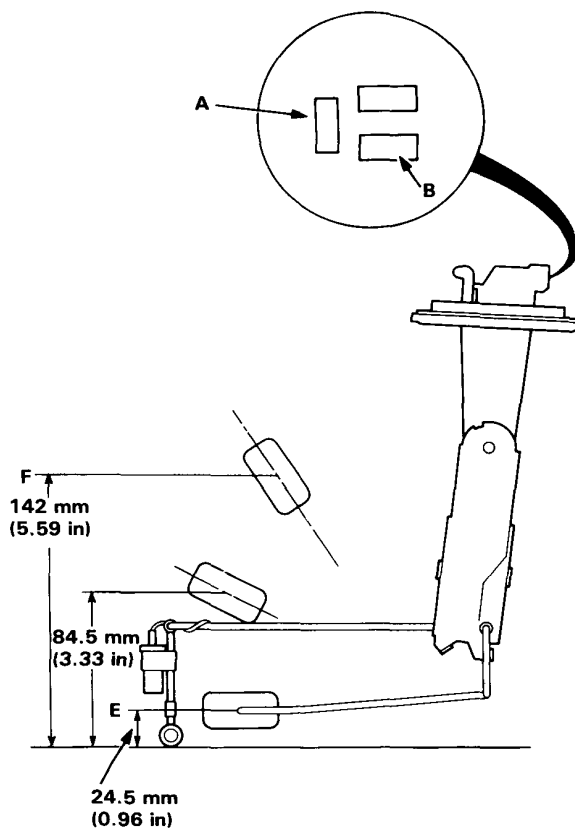

5. If unable to obtain the above readings, replace the fuel gauge sending unit.