

Stereo Sound System

Component Location Index

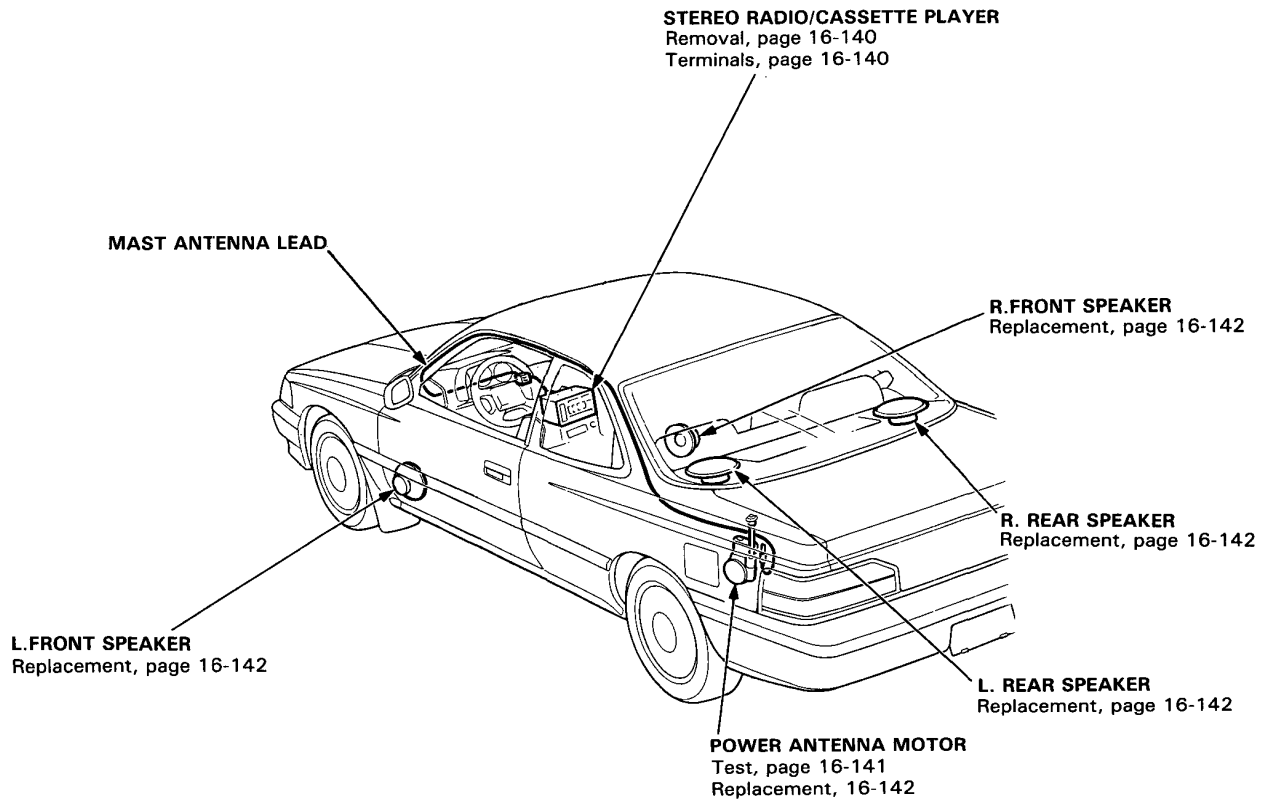



Circuit Diagram

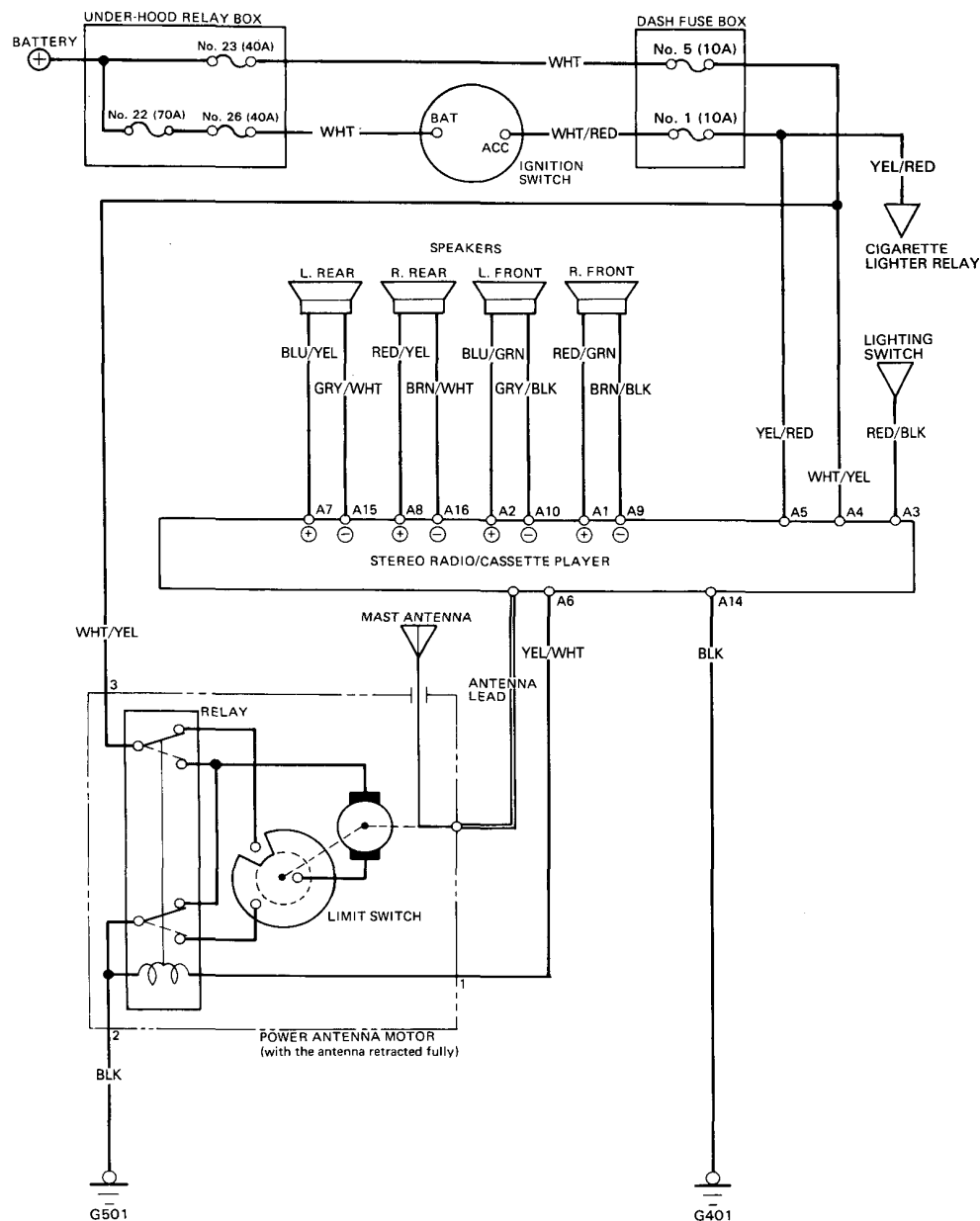

Stereo Sound System

Unit Removal

A-Type:

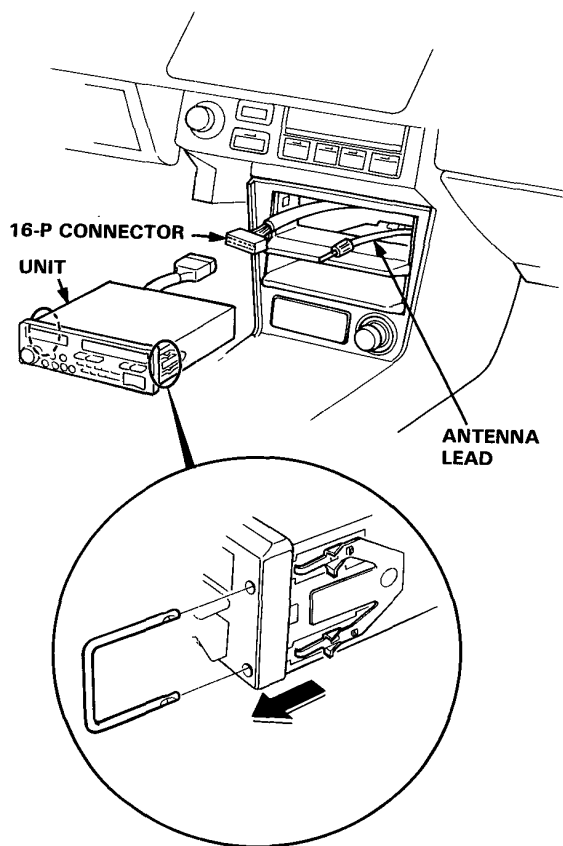

B-Type: Remove the front console to loose the screws.

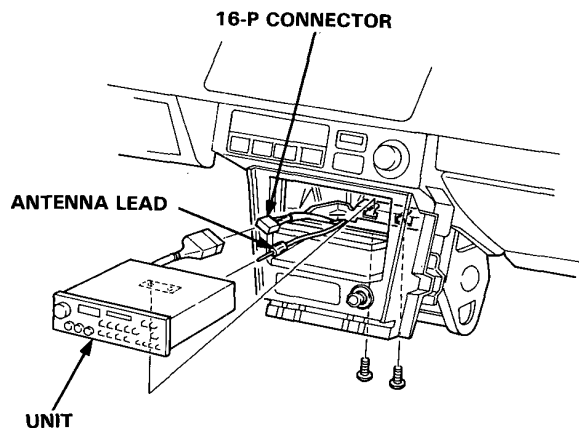

Unit Terminals

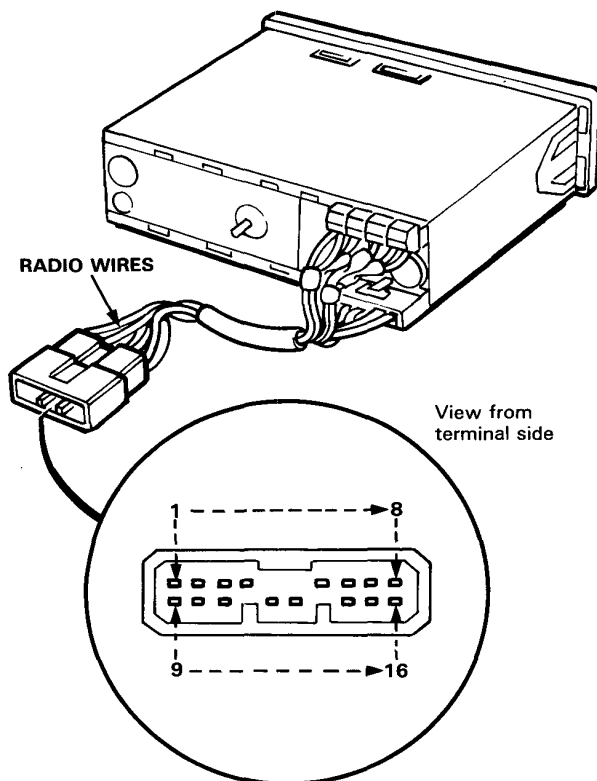

Terminal	Wire	Destination
1	RED/GRN	Right front speaker ⊕
2	BLU/GRN	Left front speaker ⊕
3	RED/BLK	Light-on signal
4	WHT/YEL	Memory power (hot at all time)
5	YEL/RED	Switched power (hot with key on)
6	YEL/WHT	Power antenna
7	BLU/YEL	Left rear speaker ⊕
8	RED/YEL	Right rear speaker ⊕
9	BRN/BLK	Right front speaker ⊖
10	GRY/BLK	Left front speaker ⊖
11	—	(Not used)
12	—	(Not used)
13	—	(Not used)
14	BLK	Ground
15	GRY/WHT	Left rear speaker ⊖
16	BRN/WHT	Right rear speaker ⊖

NOTE: The wire color of No. 4 terminal (WHT/YEL) changes to WHT/BLU in case of the radio wires.



Power Antenna Motor Test

1. Remove the trunk side trim panel.
2. Disconnect the 3-P connector from the motor and remove the connector from its clamp.
3. First check power to the motor at the harness pins:
There should be battery voltage between the WHT/YEL (+) and BLK (-) terminals all the time.
There should be battery voltage between the YEL/WHT (+) and BLK (-) terminals only with the ignition and radio switched ON.
4. Test motor operation:

FULL EXTEND: Connect battery positive to the No.3 and No.1 terminals and negative to the No.2 terminal.

RETRACTED: Then disconnect battery positive from the No.1 terminal.

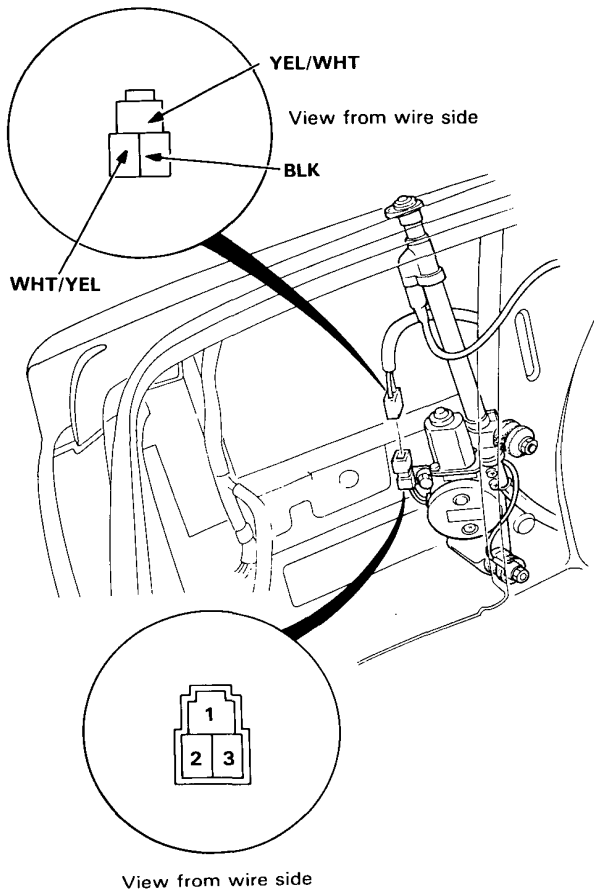

5. If the motor fails to operate properly, replace it.

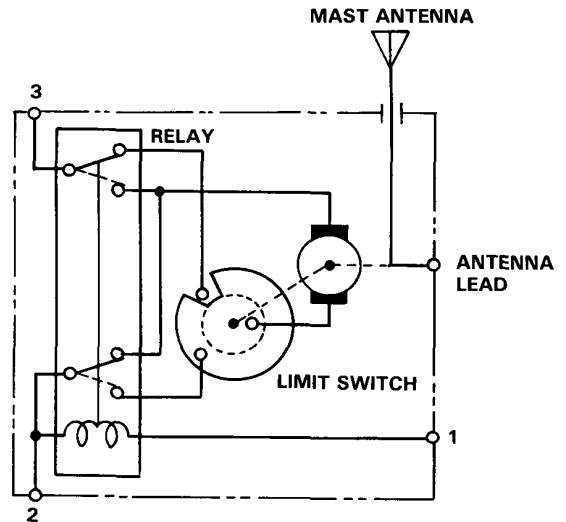

Stereo Sound System

Power Antenna Motor Replacement

1. Remove the trunk side trim panel.
2. Disconnect the 3-P connector and antenna lead from the motor, then remove the special nut and 2 mount nuts to take out the motor with the mast antenna.

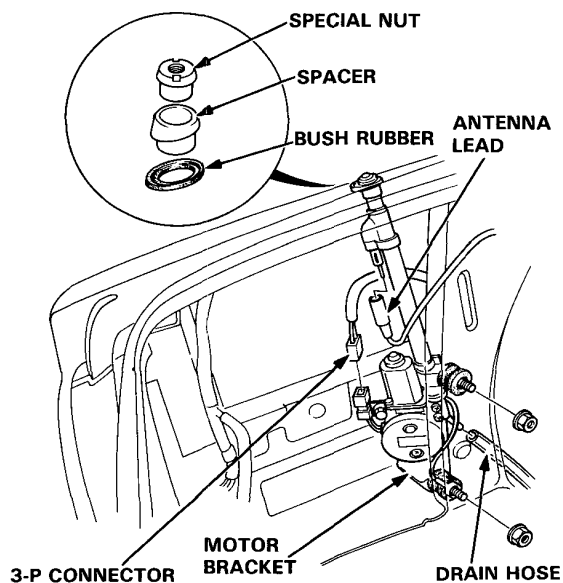

Speaker Replacement

Front Speakers:

1. Remove the door trim panel.
2. Remove the 5 screws, then disconnect the 2-P connector from the speaker assembly.

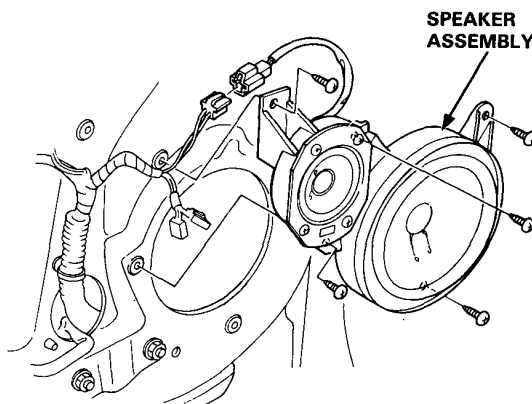

Rear Speakers:

1. Remove the speaker cover.
2. Remove the 3 screws, then disconnect the wires from the speaker.

