

Turn Signal/Hazard Flasher System



Component Location Index

TURN SIGNAL INDICATOR LIGHTS
(in the gauge assembly)
Gauge Assembly, page 16-76

HAZARD WARNING LIGHT
(EC only)
(in the gauge assembly)
Gauge Assembly, page 16-76

HAZARD SWITCH
Removal, page 16-132
Test, page 16-132

LIGHTING/TURN SIGNAL SWITCH
Test, page 16-114
Replacement, page 16-114

TURN SIGNAL/HAZARD RELAY
Input Test, page 16-131

DASH RELAY HOLDER
(Located under dash, driver's side)

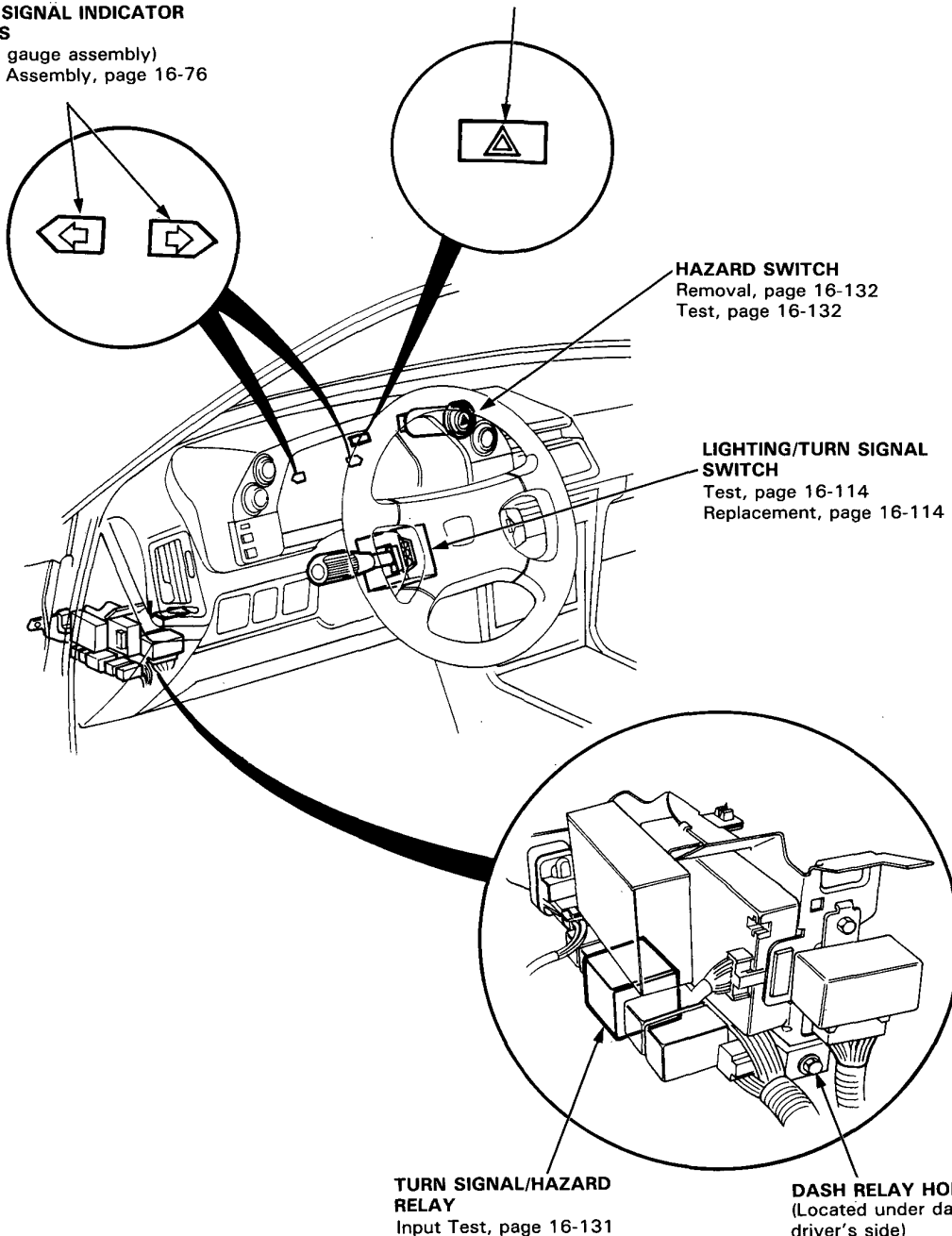

Turn Signal/Hazard Flasher System

Circuit Diagram

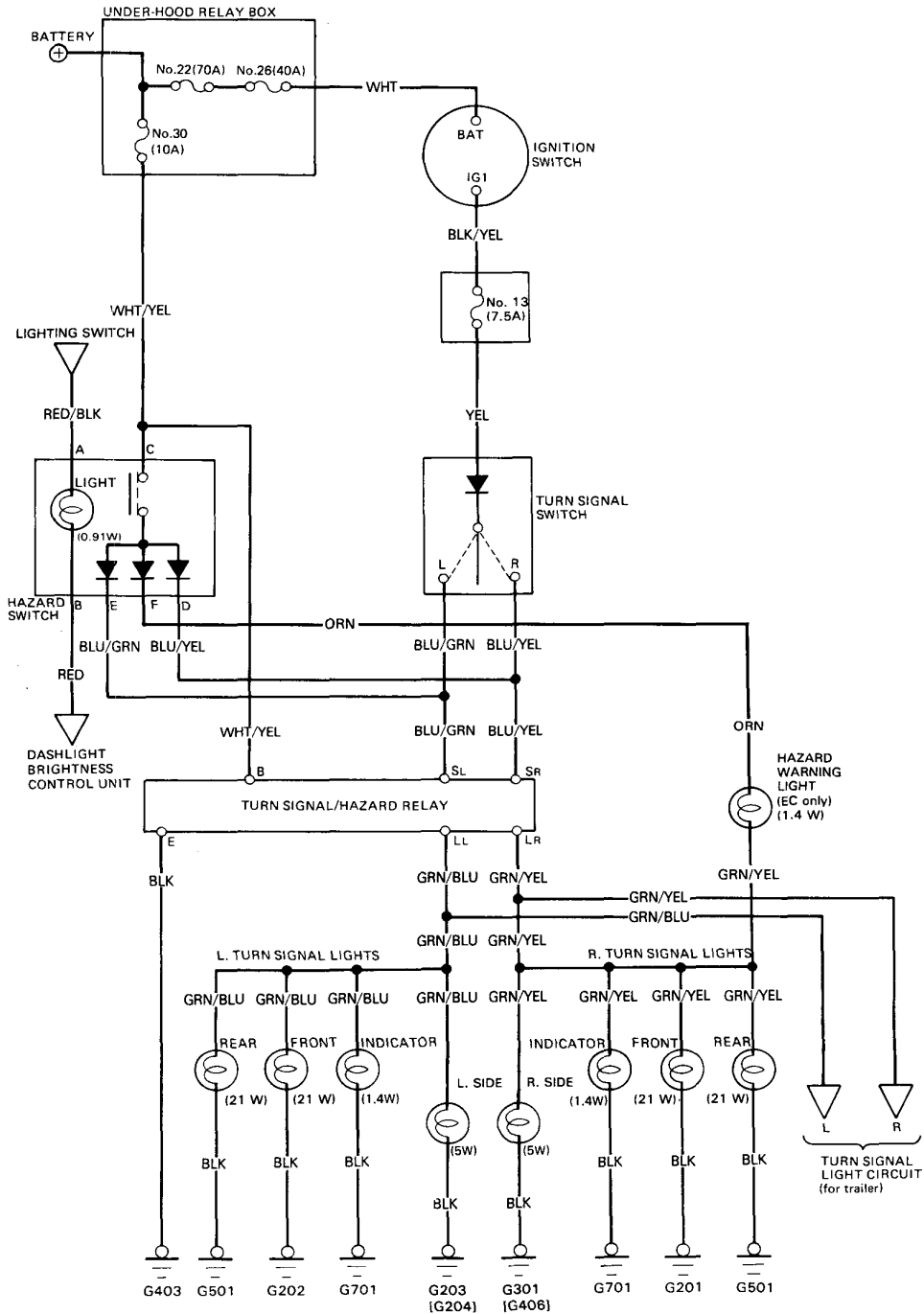

[]: RHD



Turn Signal/Hazard Relay Input Test

Remove the dashboard lower panel, and the dash relay holder from the bracket to facilitate the input test, then remove the turn signal/hazard relay from the dash relay holder.

Make the following input tests at the relay holder pins. If all tests prove OK, but the relay fails to work, replace the turn signal/hazard relay.

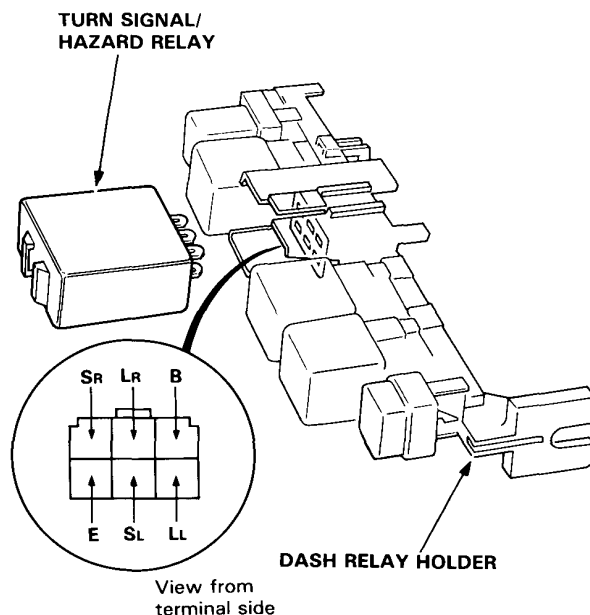

No.	Terminal	Test condition	Test: desired result	Possible cause (if result is not obtained)
1	E	Under all conditions.	Check for continuity to ground: should be continuity.	<ul style="list-style-type: none"> • Poor ground (G403). • An open in the BLK wire.
2	B	Under all conditions.	Check for voltage to ground: should be battery voltage.	<ul style="list-style-type: none"> • Blown No. 30 (10 A) fuse. • An open in the WHT/YEL wire.
3	SR	Ignition switch ON and turn signal switch in R.	Check for voltage to ground: should have battery voltage.	<ul style="list-style-type: none"> • Blown No. 13 (7.5 A) fuse. • Faulty turn signal switch. • An open in the YEL, BLU/GRN or BLU/YEL wire.
	SL	Ignition switch ON and turn signal switch in L.		
4	SR	Hazard switch ON.	Check for voltage to ground: should be battery voltage.	<ul style="list-style-type: none"> • Faulty hazard switch. • An open in the BLU/GRN or BLU/YEL wire.
	SL			
5	LR	Connect the B terminal to the LR terminal.	R. Turn signal lights should come on as the battery is connected.	<ul style="list-style-type: none"> • Blown bulb. • Poor ground. (G201, G301 [G406], G501 or G701) • An open in the GRN/YEL wire.
6	LL	Connect the B terminal to the LL terminal.	L. Turn signal lights should come on as the battery is connected.	<ul style="list-style-type: none"> • Blown bulb. • Poor ground. (G202, G203 [G204], G501 or G701) • An open in the GRN/BLU wire.

[]: RHD

Turn Signal/Hazard Flasher System

Hazard Switch Removal

1. Remove the 4 screws, then remove the instrument panel from the dashboard.

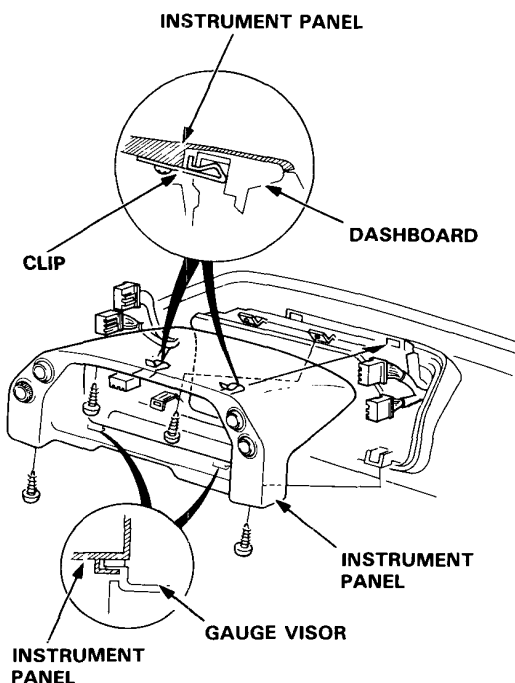

2. Remove the screw from the rear of the instrument panel, then remove the switch.

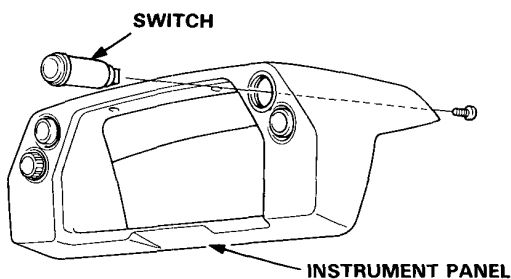

3. Turn the socket 45° counterclockwise to remove it.

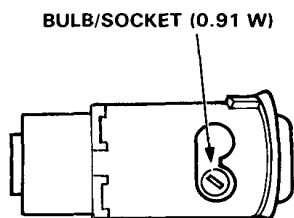

Hazard Switch Test

1. Remove the instrument panel from the dashboard.
2. Check for continuity between the terminals in each switch position according to the table.

Terminal	C	D	E	F	A	B
Position						
OFF						
ON	○ →	○ →	○ →	○ →	○ →	○ →

