

# Seat Belts

## Rear Replacement

**CAUTION:** Check the seat belts for damage (page 14-51), and replace them if necessary. Be careful not to damage them during removal and installation.

1. Remove the rear seat.
2. Remove the quarter trim panel.
3. Remove the upper anchor bolt, the lower anchor bolt and retractor bolt with a 17 mm socket or box-end wrench.

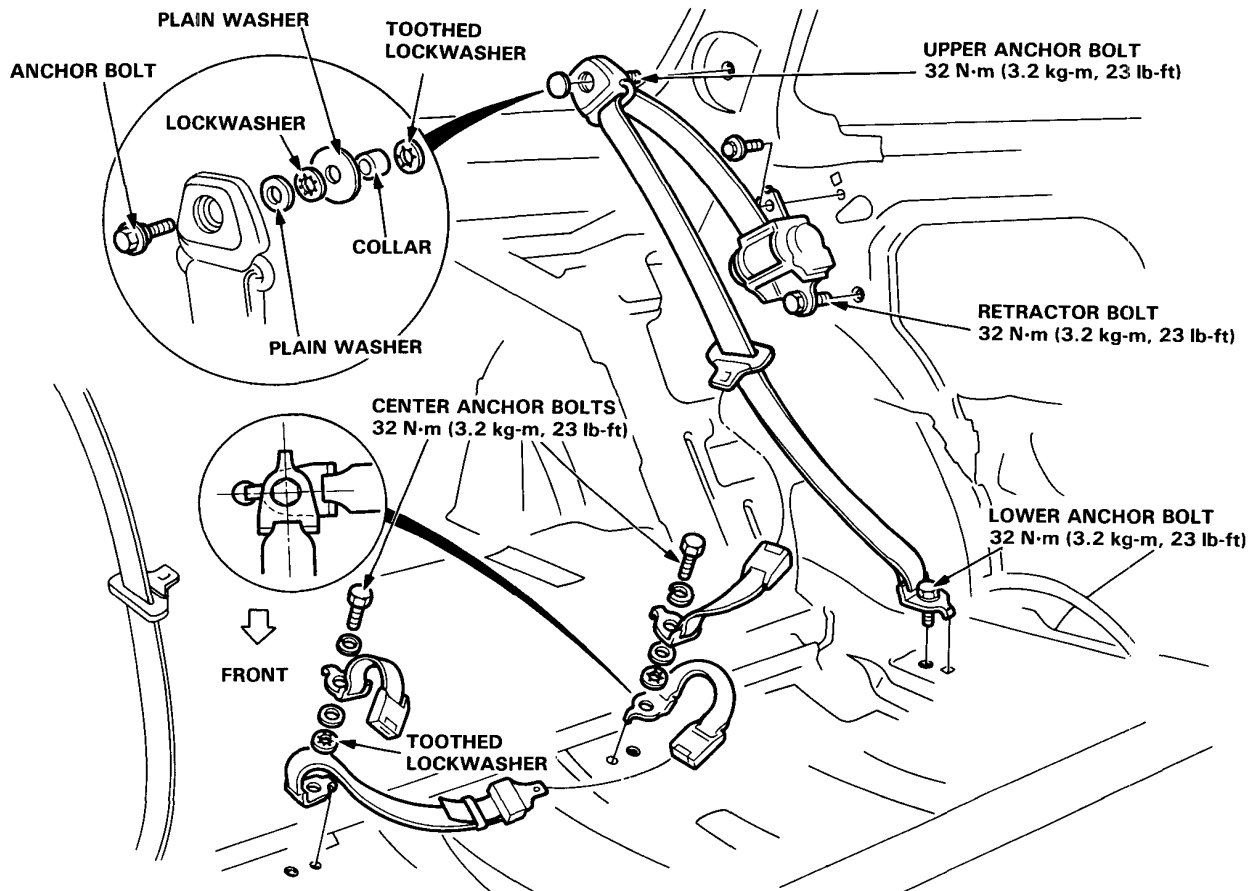

4. Install the seat belt in the reverse order of removal.