

# Seat Belts

## Belt Presenter Removal

1. Remove the front seat (page 14-44).
2. Remove the lower anchor bolt, then remove the rotary arm.
3. Remove the screws, lifter handle and adjuster knob, then remove the seat side cover.

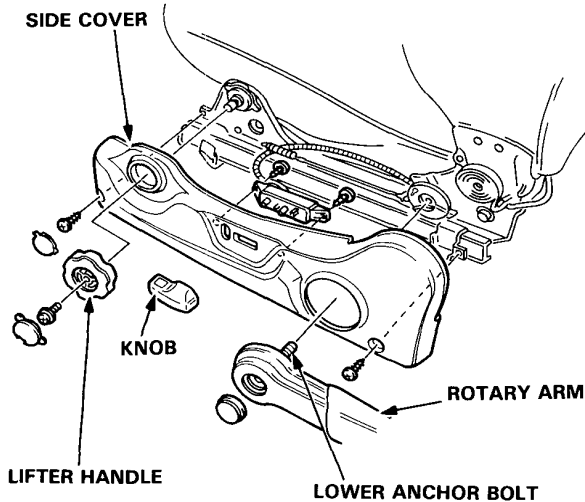

4. Remove the circlip.
5. Remove the return spring, then separate rotary plate B and spring stopper.
6. Remove the return cable end and damper spring.
7. Remove the rotary plate A and rotary cable.

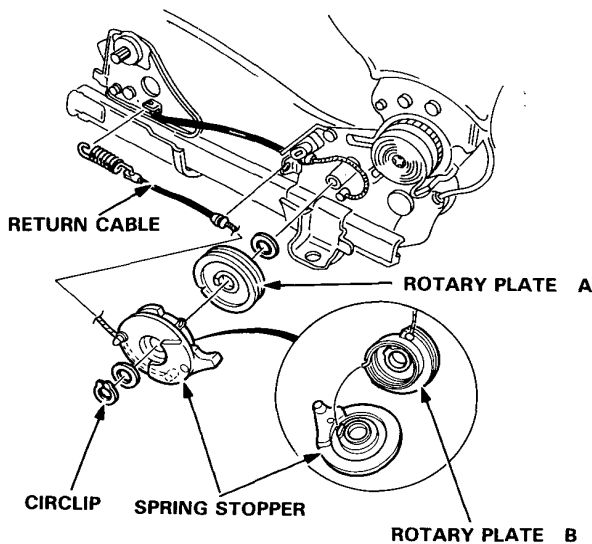

8. Remove the bolts, then remove the power unit from under the seat cushion.

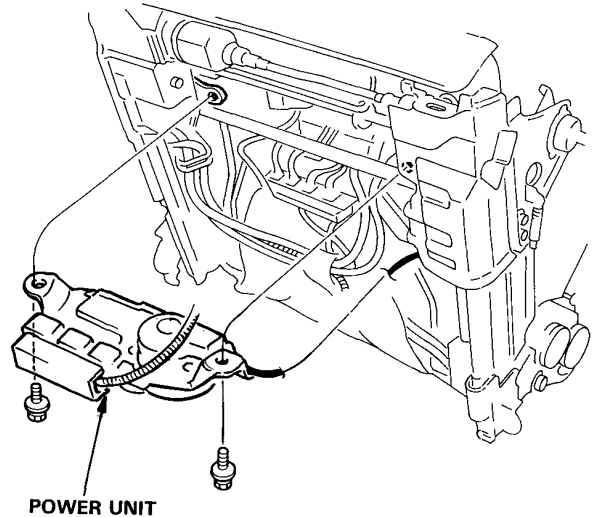

9. Remove the screws, then remove the rotary plate cover.
10. Loosen the lock nut and remove the rotary cable from the bracket.
11. Remove the cable end from the rotary plate C.

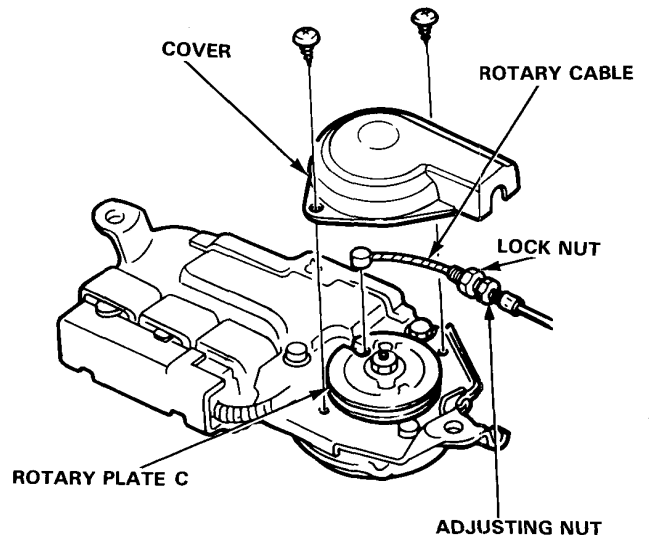



12. Remove the nut, retainer, and rotary plate C.
13. Remove the mounting bolts and drive motor.

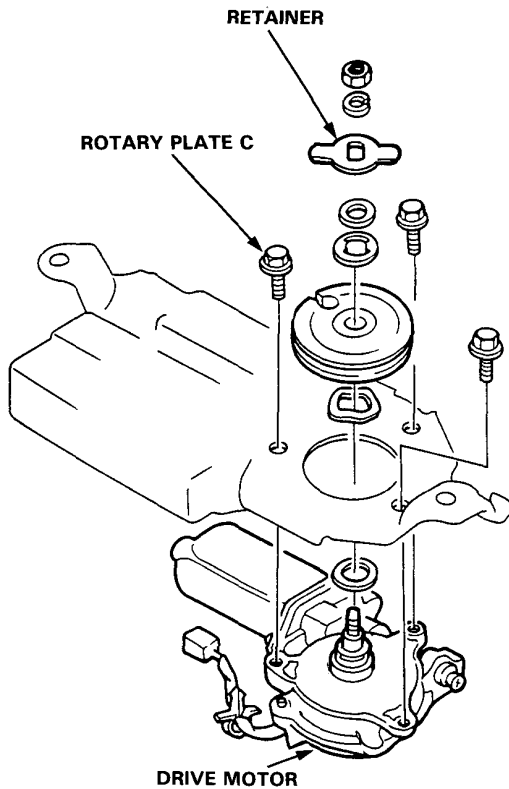

## Installation

To install, reverse the removal procedure.

1. Grease all moving surfaces.
2. Install the spring stopper onto rotary plate B and turn plate B clockwise to make sure that it is seated firmly.

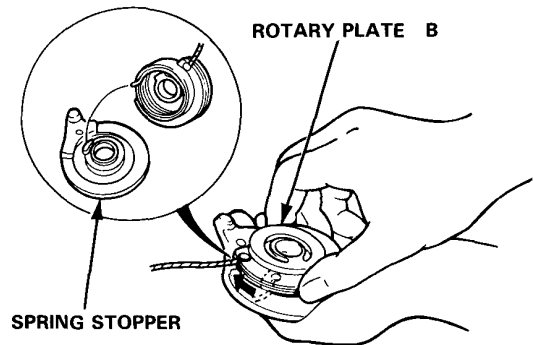

3. Install the rotary plate A aligning the hole of plate B with the dowel pin of plate A.

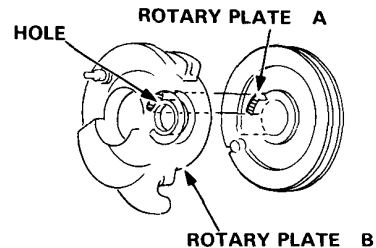

4. Check that the spring stopper has moved to contact the rubber cushion after assembly.
5. Adjust the free play of the rotary cable at the adjusting nut on the drive motor side.

