

Quarter Glass

Disassembly (cont'd)

16. Align the slider with the hole, then remove the cable end and cable guide.

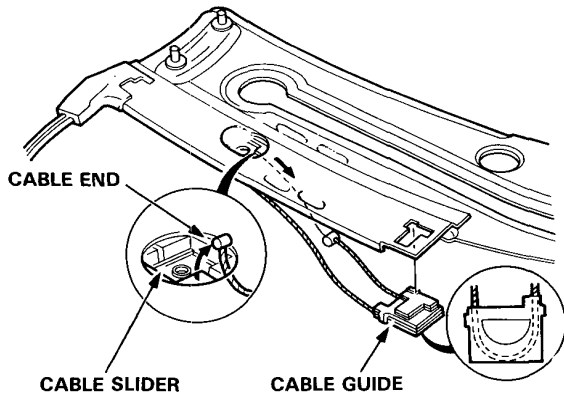

17. Remove the cable joint.

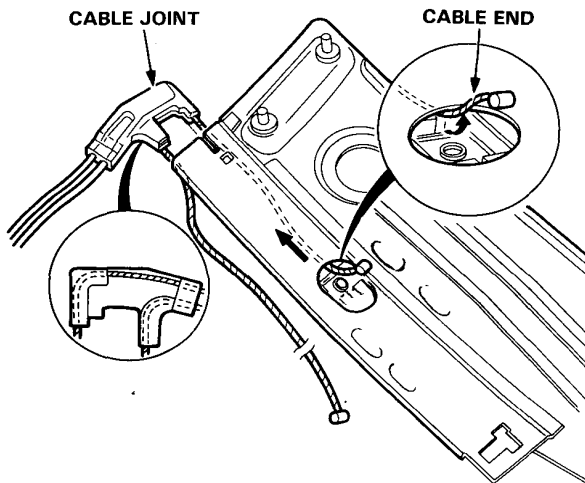

18. Slide the roller plate off the regulator.

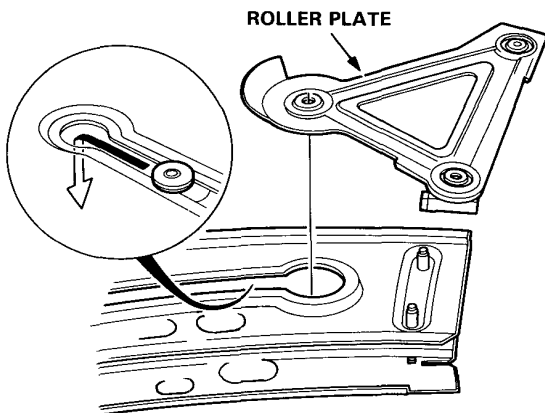

Assembly

Assemble the quarter glass and regulator in the reverse order of disassembly and:

1. Grease all the sliding surfaces of the regulator where shown.

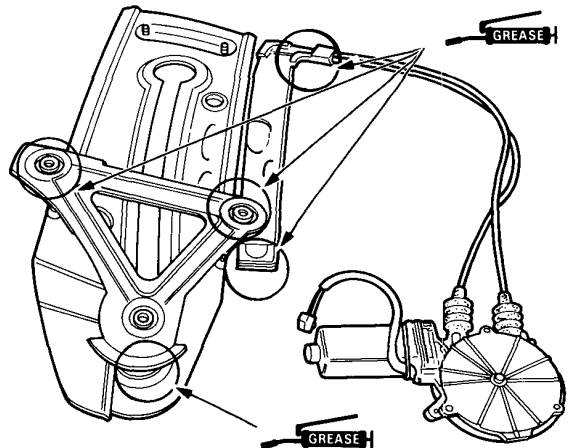

2. Insert the glass slowly into the quarter panel.

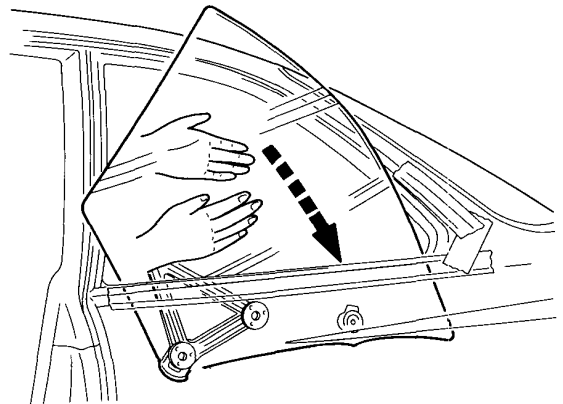



3. Suspend the glass in the fully closed position, using heavy-duty adhesive tape, or have an assistant hold the glass in place.

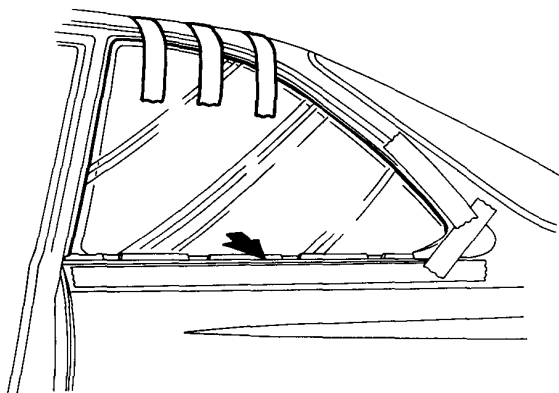

4. Carefully raise the roller plate until you can align the mounting holes with the glass setting holes.
5. Install the roller plate aligning it with the glass mounting holes. Tighten the 3 mounting bolts.

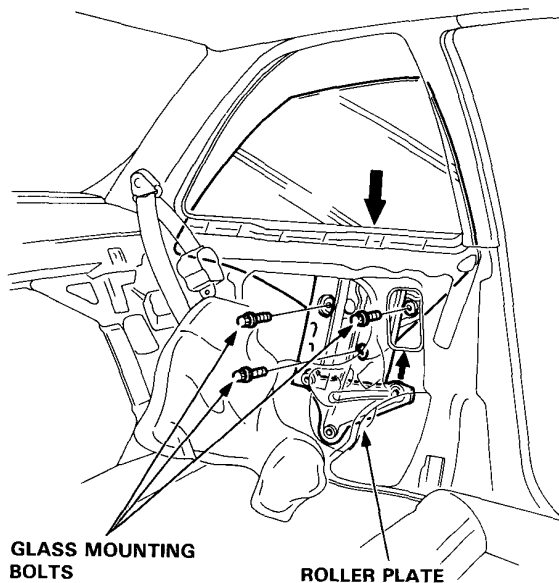

Glass Adjustment

1. Inclination Adjustment (page 14-20).
2. Glass-to-Weatherstrip Adjustment (page 14-21).

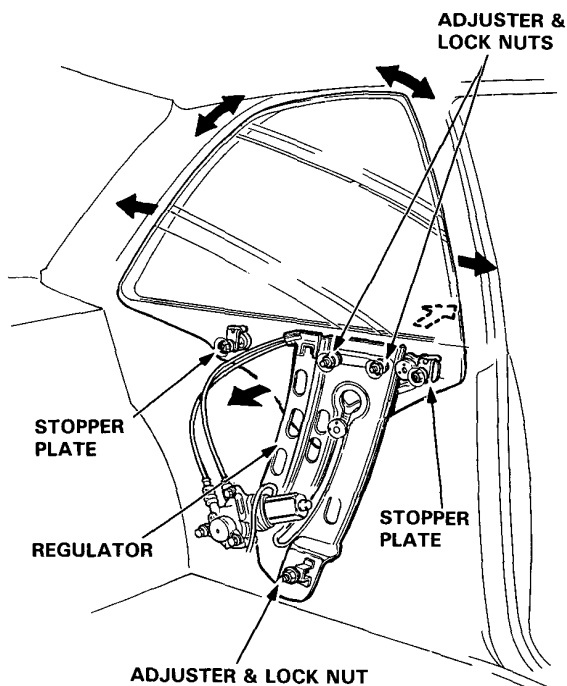

(cont'd)