

Bleeding

Air Bleeding

NOTE: Do not depress the brake pedal while using the ALB checker to bleed air from the system.

1. Fill the modulator reservoir with brake fluid up to the MAX level.
2. Disconnect the 6P coupler (PNK) from the cover mounted in front of the console and connect it to the ALB checker.

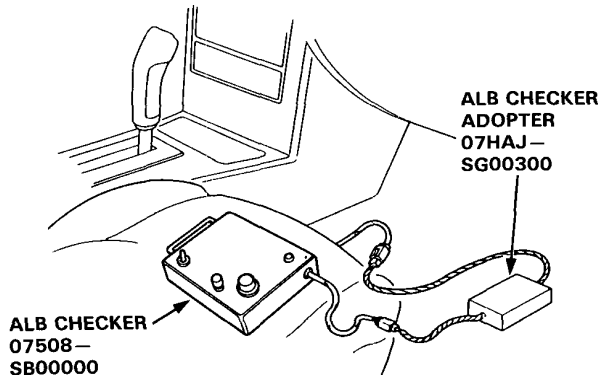

CAUTION: Place the car on level ground with the wheels blocked. Shift the transmission to P or Neutral.

3. Start the engine.
4. Release the parking brake.
5. Turn the power switch of ALB checker ON.

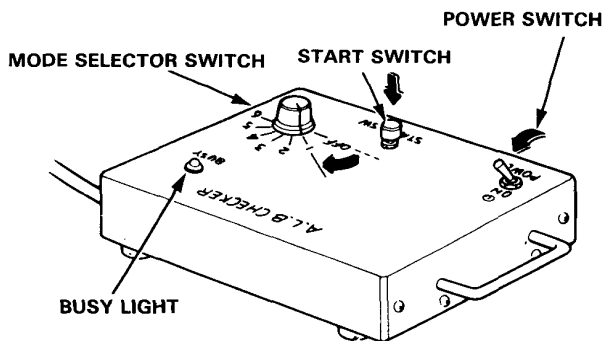

6. Turn the mode selector switch to 1.
7. Press the start switch.
8. Make sure that the motor runs.
9. Wait for the motor to stop.

10. Turn the mode switch to 2.

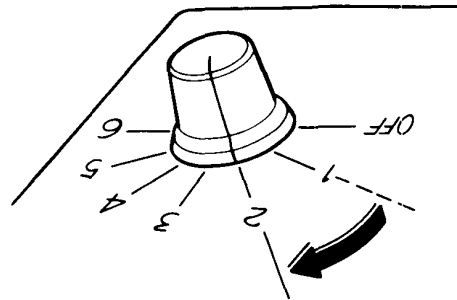

11. Press the start switch.
12. Brake fluid in the reservoir will bubble briskly for 20 seconds after the switch is pressed. Wait for 4 to 5 minutes until the brake fluid stops bubbling.
13. Turn the mode switch to 6.
14. Repeat steps 11 and 12.
15. Repeat steps 10 through 14 two or three times.
16. Fill the reservoir with brake fluid up to the MAX level.

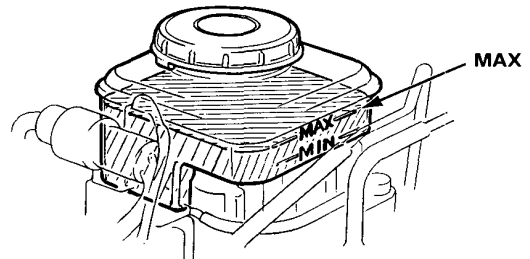

17. Install the cap.
18. Check the ALB function in all modes (page 13-44). There should be kickback in modes 2 through 6.

CAUTION: If the kickback is weak, re-bleed air from the system.