



Valve Body Unit Assembly

1. Thoroughly clean the disassembled parts shown below.
2. Coat the plungers, cut-off valve and reaction control valve surfaces with power steering fluid.
3. Reassemble the parts in reverse order of disassembly.

CAUTION:

- Replace the O-rings and seals with new ones.
- Do not dip the O-rings and seals in solvent.
- Apply grease in the port seal grooves to keep the seals in place.
- Apply grease to the 45.5 x 2 mm and 11 mm O-rings to keep them in place in the valve ports.

●  **STEERING GREASE.....Part Number 08740-99969**

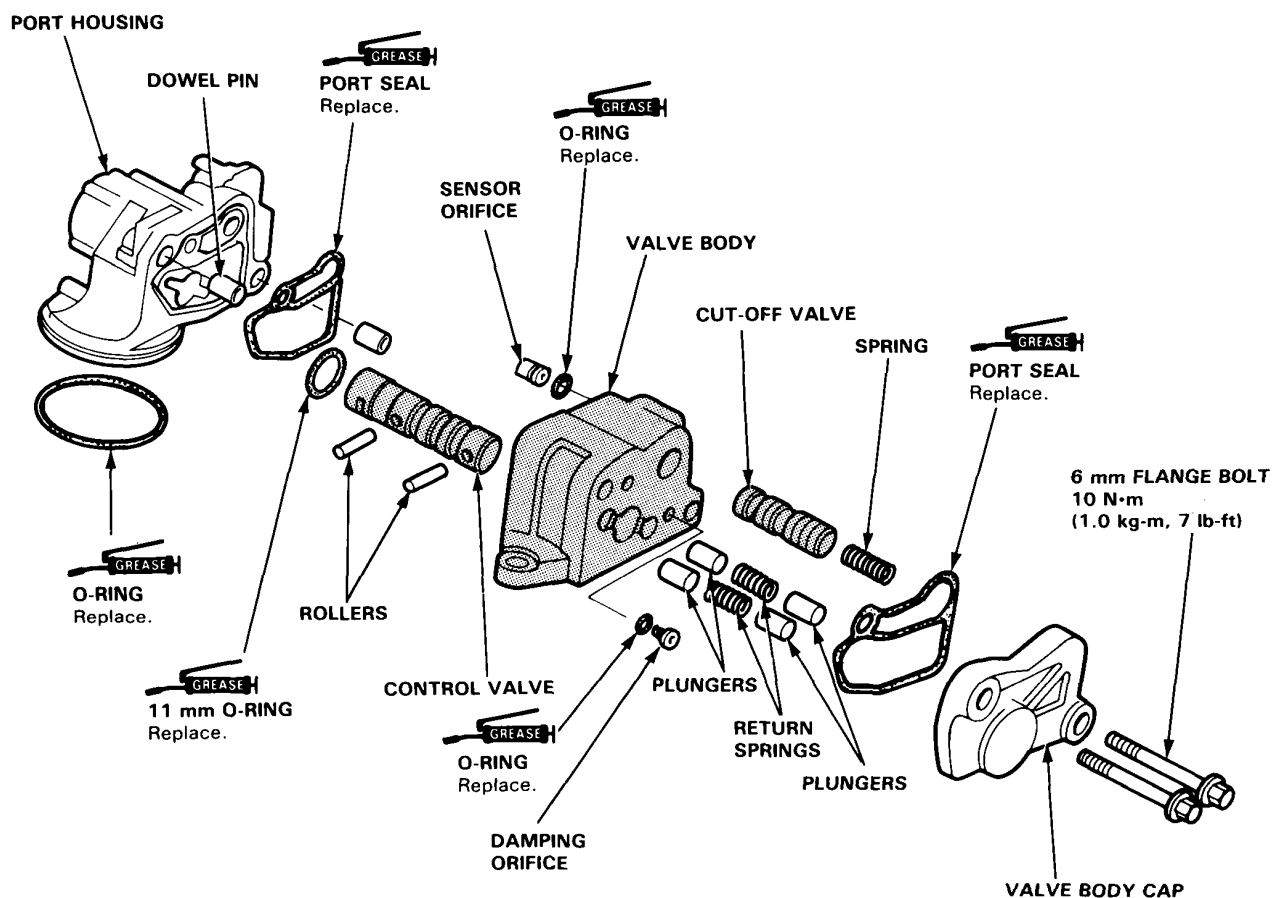

NOTE: If the Valve Body is damaged, it must be replaced as a set, with the Cut-off Valve and Control Valve (shaded parts).

(cont'd)

Gearbox

Valve Body Unit Assembly (cont'd)

4. Install and tighten the 6 mm flange bolts in the control valve body unit.

CAUTION: Make sure the mating surface of the valve body and cap are flush at the upper side.

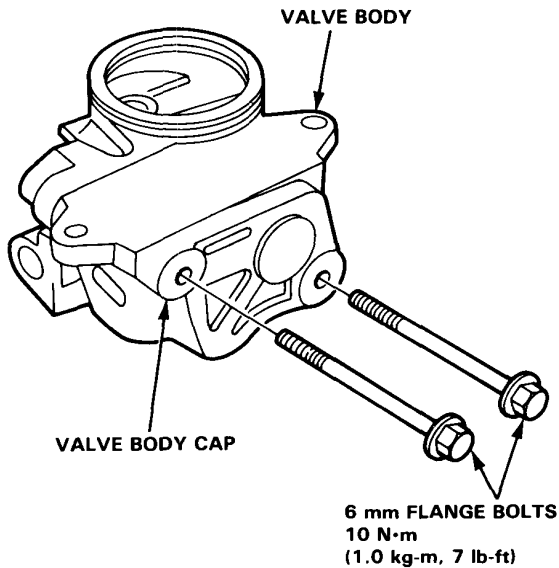

5. Make sure the control valve moves smoothly, and returns to neutral position.

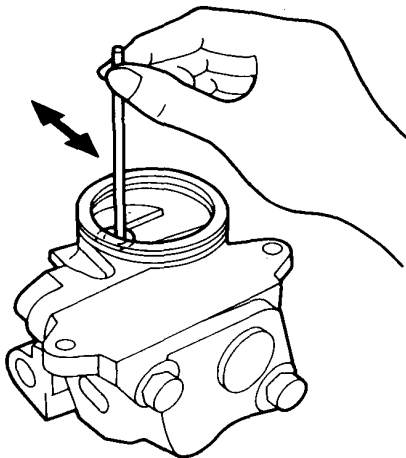

6. Coat the 7.8 x 1.9 mm O-rings with grease, and install them together with orifices.
7. Install the valve body unit on the gear housing with the two 6 mm bolts.

CAUTION:

- When installing, be careful not to hit the pinion holder pin.
- Make sure the O-rings are in place and not pinched.

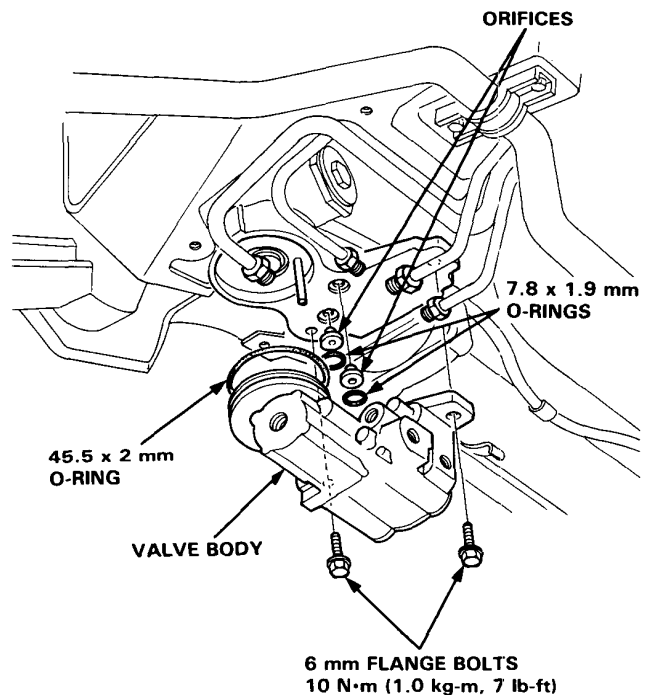



8. Connect the four lines to the control unit, using flare nut wrenches.

- A: From pump: 14 mm wrench
38 N·m (3.8 kg-m, 28 lb-ft)**
- B: To speed sensor: 12 mm wrench
13 N·m (1.3 kg-m, 9 lb-ft)**
- C: To reservoir: 12 mm wrench
13 N·m (1.3 kg-m, 9 lb-ft)**
- D: To oil cooler: 17 mm wrench
29 N·m (2.9 kg-m, 20 lb-ft)**

