

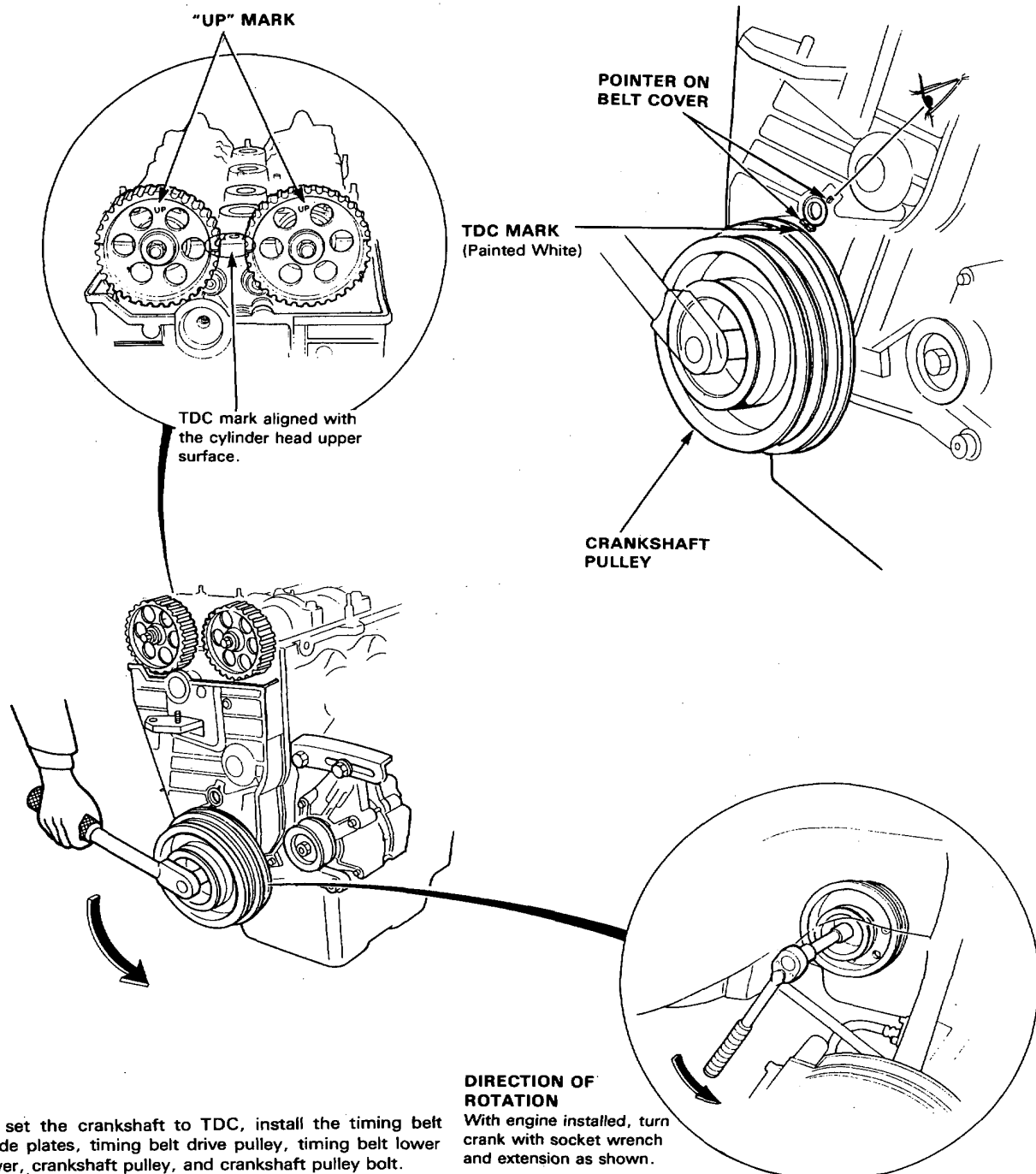

Positioning Crankshaft Before Installing Timing Belt

NOTE:

- Install the timing belt with the No. 1 piston at TDC (Top Dead Center) on the compression stroke.
- If pulley bolt broke loose while turning the crank, retorque it to 165 N·m (16.5 kg-m, 119 lb-ft).



NOTE:

- To set the crankshaft to TDC, install the timing belt guide plates, timing belt drive pulley, timing belt lower cover, crankshaft pulley, and crankshaft pulley bolt.

DIRECTION OF ROTATION

With engine installed, turn crank with socket wrench and extension as shown.