

Steering

Index

NOTE: The tilt steering column is shown; the conventional steering column is similar except for the tilt mechanism.

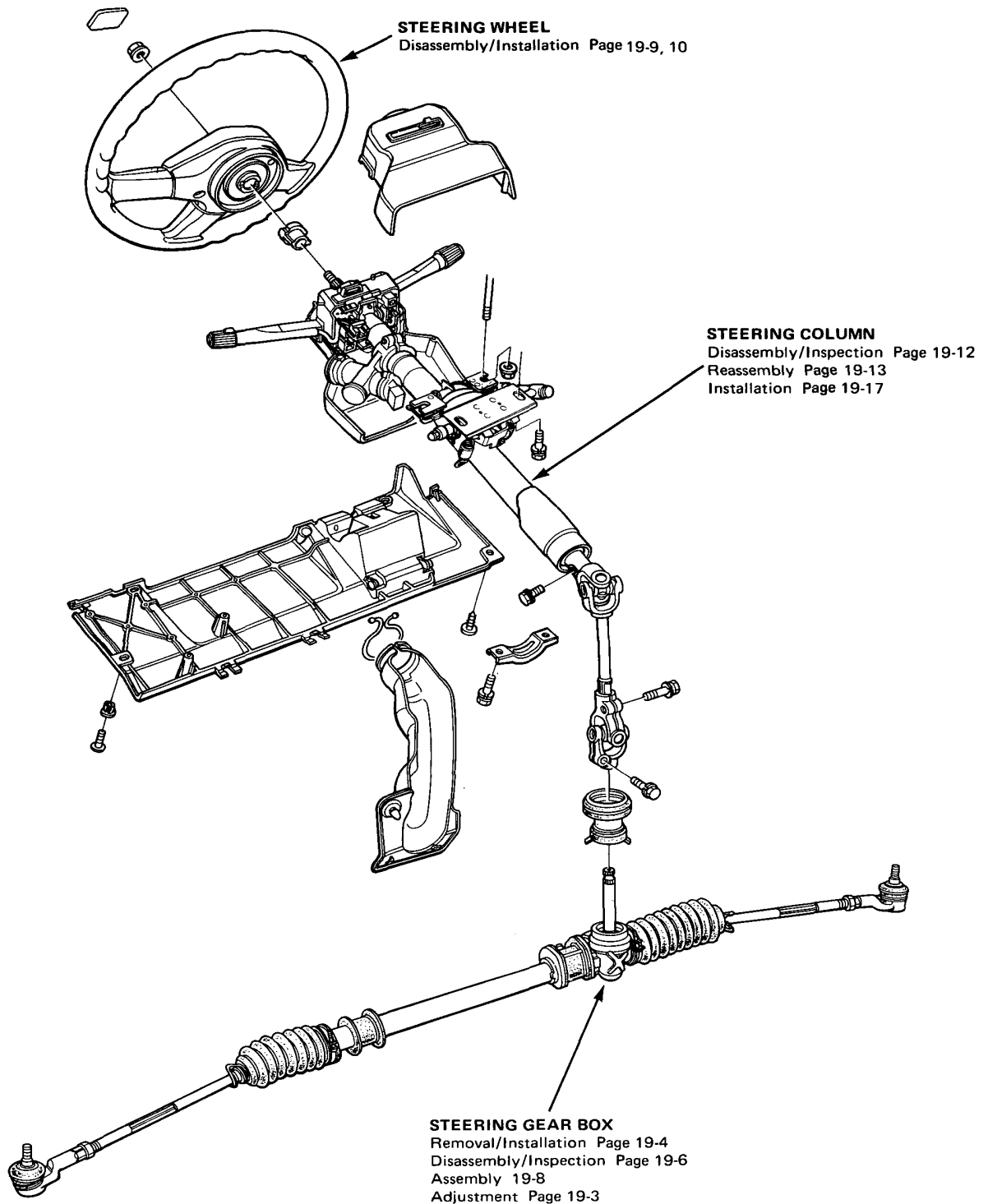

Inspection



Steering Wheel Rotational Play

1. Place the front wheels in a straight ahead position and measure the distance the steering wheel can be turned without moving the front wheels.
2. If the play exceeds the service limit, check all steering components.

Service Limit: 10 mm (0.4 in.)

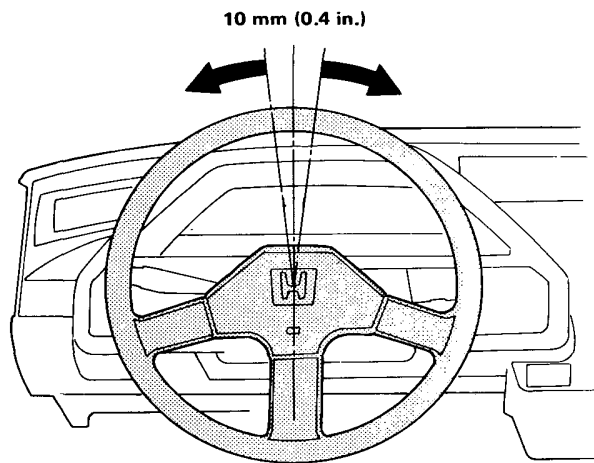

Steering Effort Check

1. Raise the front wheels off the ground.
2. Turn the steering wheel with a spring gauge and check its reading.
3. If the reading exceeds the service limit, adjust the steering gearbox as shown below.

Service Limit: 15 N (1.5 kg, 3.3 lbs)

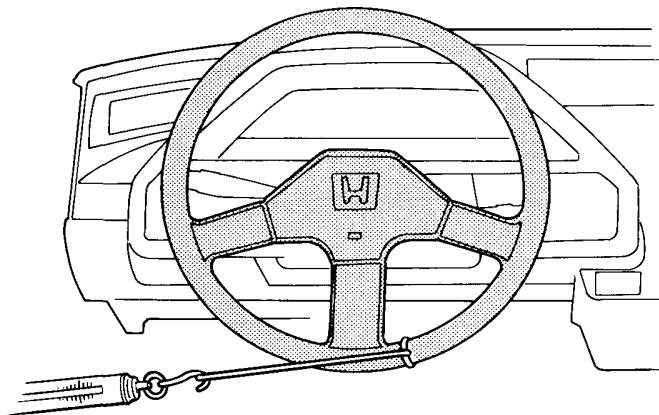

Steering Gearbox Adjustment

1. Loosen the rack screw locknut.
2. Torque the rack guide screw to 4 N·m (0.4 kg·m, 3 lb·ft).
3. Back off the screw approximately 1/10 of a turn from the bottomed (torqued) position and tighten the lock nut to 25 N·m (2.5 kg·m, 18 lb·ft).
4. Check for tight or loose steering through the complete turning travel.
5. Recheck steering effort as shown above.

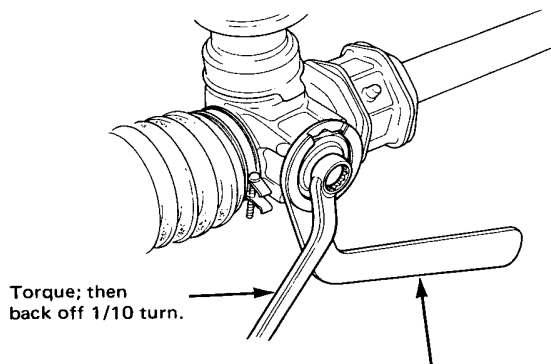

**STEERING GEARBOX LOCK NUT WRENCH
07916-6920100 or 07916-SA50001**