

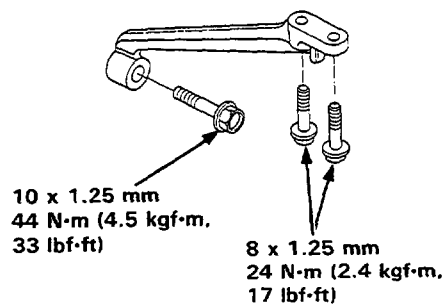

Installation

Bracket Bolts/Nuts Torque Specifications:

REAR STIFFENER (D16Y2, D16Y3 engines)



ALTERNATOR BRACKET

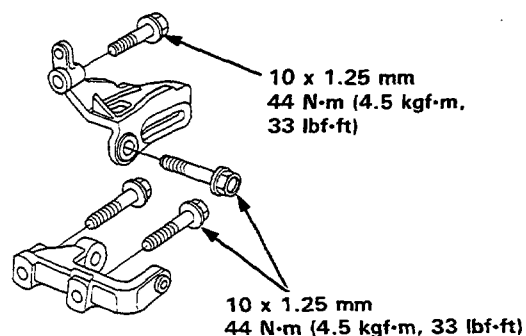

SIDE ENGINE MOUNT BRACKET

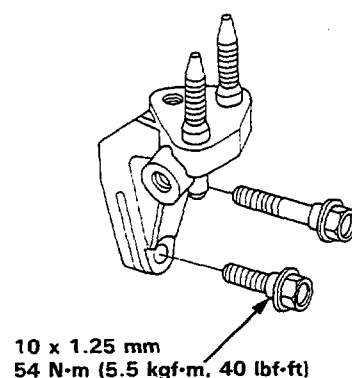

P/S PUMP BRACKET

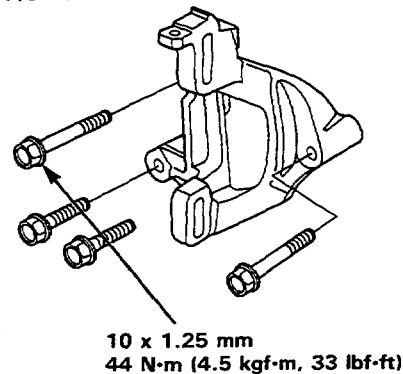

FRONT STIFFENER (D16Y2, D16Y3 engines)

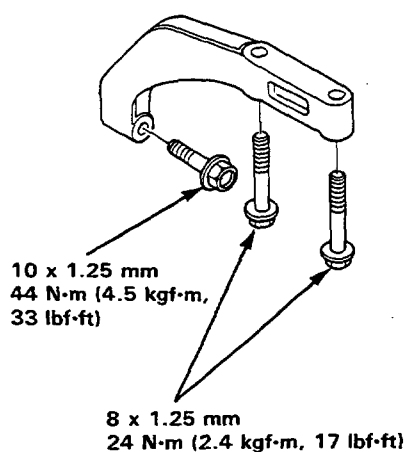

A/C COMPRESSOR BRACKET

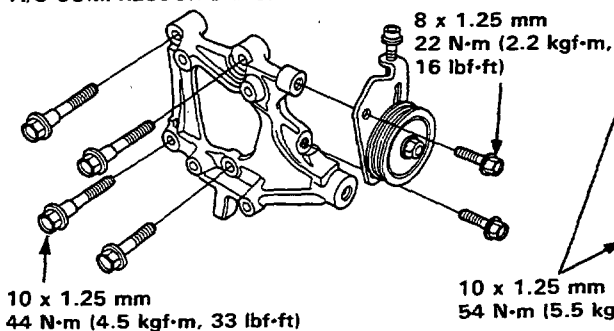

CARS NOT EQUIPPED A/C

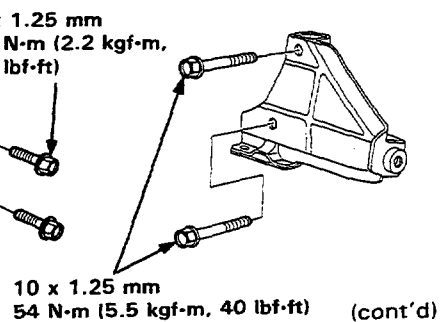

Engine Removal/Installation

Installation (cont'd)

Engine Installation

Install the engine in the reverse order of removal. Reinstall the mount bolts/nuts in the following sequence. Failure to follow these procedures may cause excessive noise and vibration, and reduce bushing life.

1. Install the side engine mount, then tighten the bolt/nuts on the engine side. Leave the mount bolt loose.

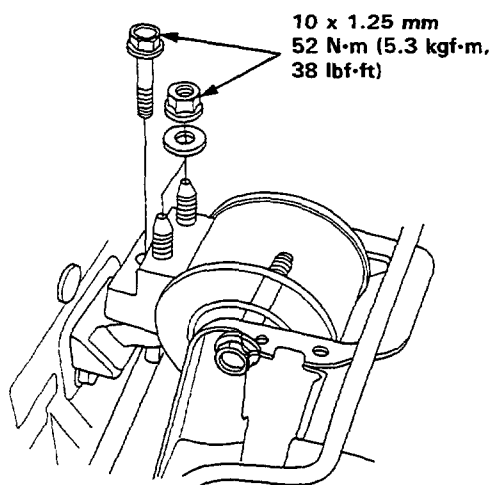

2. Install the transmission mount, then tighten the bolt/nuts on the transmission side. Leave the mount bolt loose.

A/T:

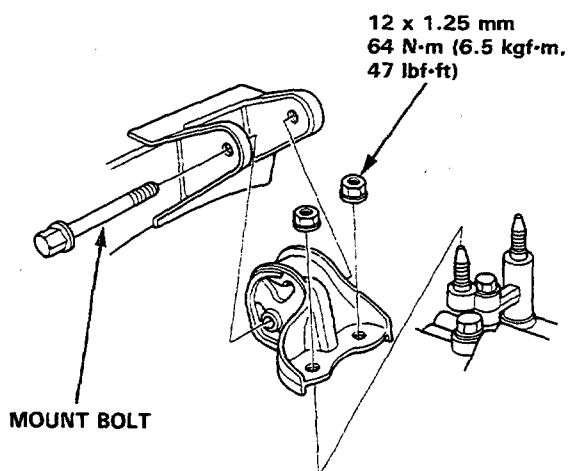

M/T:

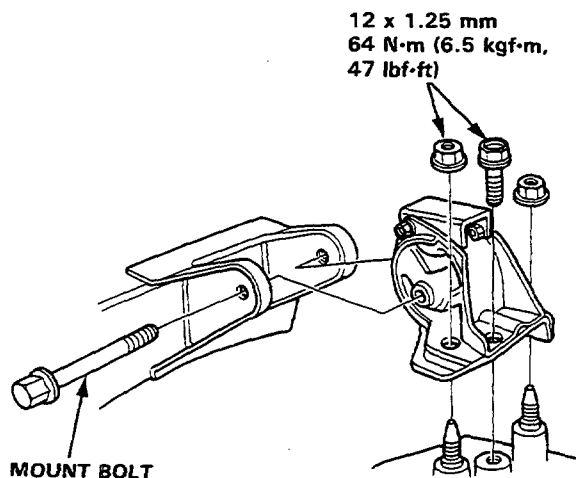

3. Tighten the mount bolt on the side engine mount.

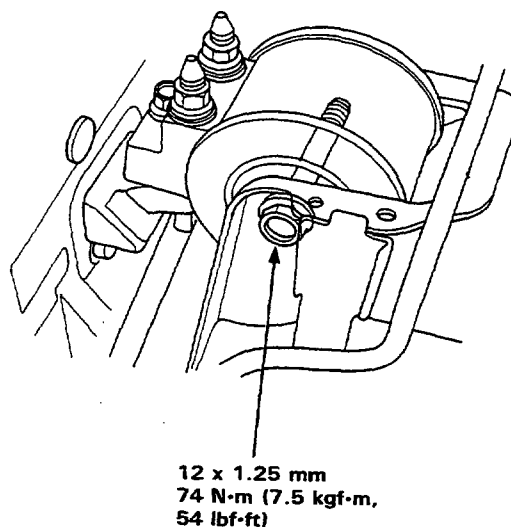



4. Tighten the mount bolt on the transmission mount.

A/T:

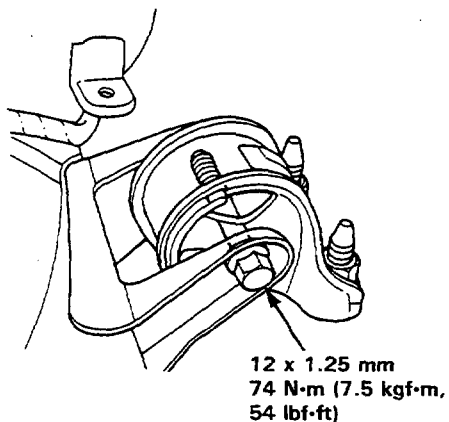

M/T:

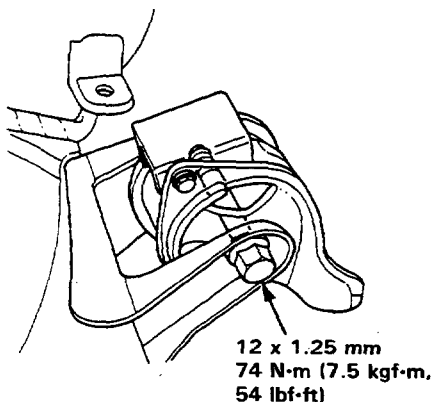

5. Install the rear mount bracket, then tighten the bolts in the numbered sequence as shown (①—③).

- ② 14 x 1.5 mm
83 N·m (8.5 kgf·m, 61 lbf·ft)
Replace.

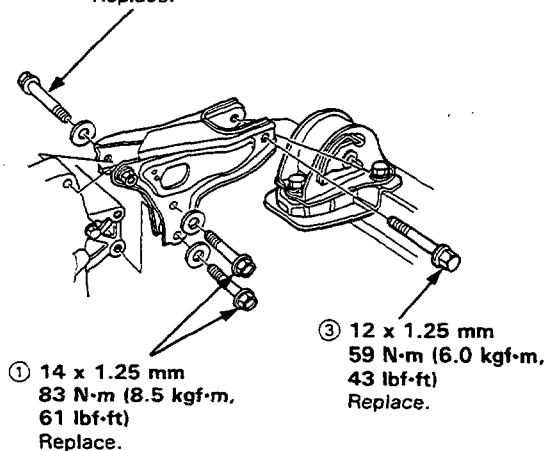

6. Install the right front mount/bracket, then tighten the bolts in the numbered sequence as shown (①—②).

A/T:

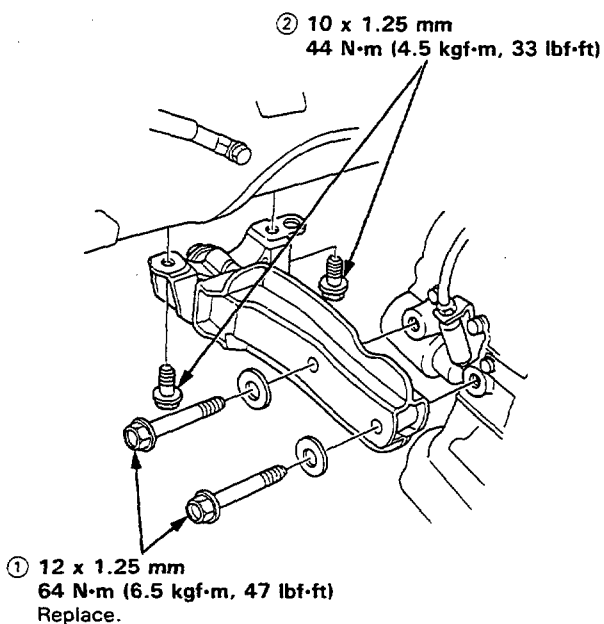

M/T:

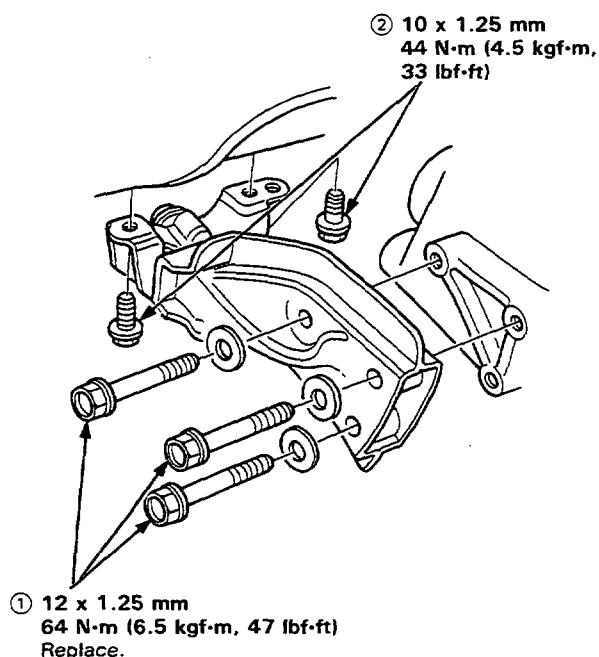

(cont'd)

Engine Removal/Installation

Installation (cont'd)

7. Install the left front mount, then tighten the bolts in the numbered sequence as shown (①—③).

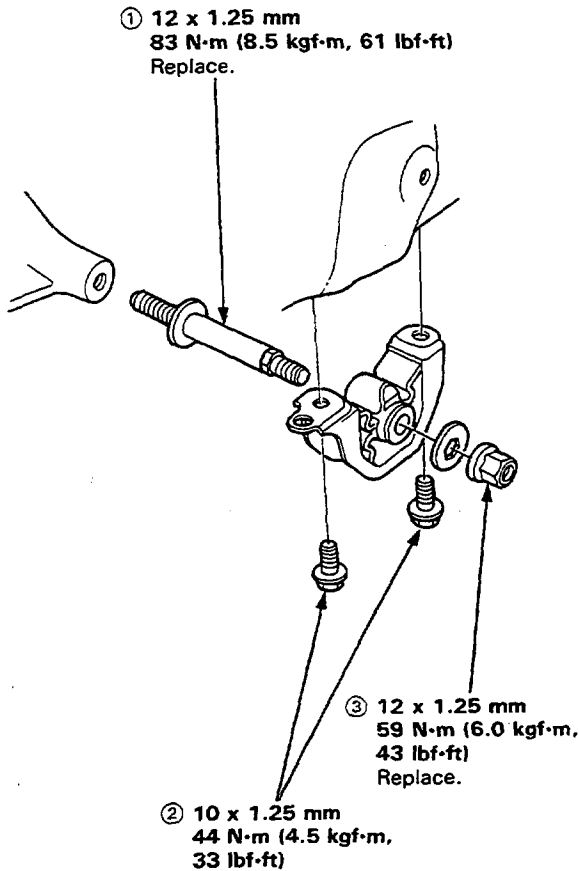

- Check that the spring clip on the end of each driveshaft clicks into place.

CAUTION: Use new spring clips.

- Bleed air from the cooling system at the bleed bolt with the heater valve open (see page 10-4).
- Adjust the throttle cable (see section 11).
- Check the clutch pedal free play (see section 12).
- Check that the transmission shifts into gear smoothly.
- Adjust the tension of the following drive belts.
 - Alternator belt (see section 23).
 - P/S pump belt (see section 17).
 - A/C compressor belt (see section 22).
- Clean battery posts and cable terminals with sandpaper, assemble, then apply grease to prevent corrosion.
- Inspect for fuel leakage (see section 11).
 - After assembling fuel line parts, turn on the ignition switch (do not operate the starter) so that the fuel pump operates for approximately two seconds and the fuel line pressurizes. Repeat this operation two or three times, and check for fuel leakage at any point in the fuel line.



Mount and Bracket Bolts/Nuts Torque Value Specifications:

TRANSMISSION MOUNT:

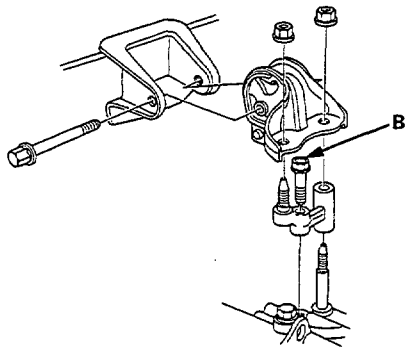

REAR MOUNT:

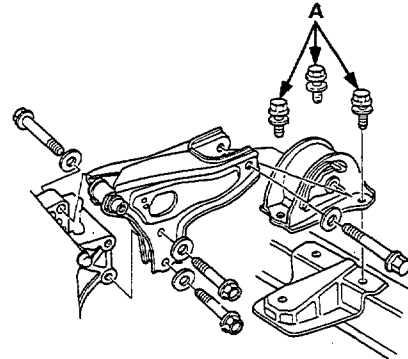

RIGHT FRONT MOUNT:

M/T:

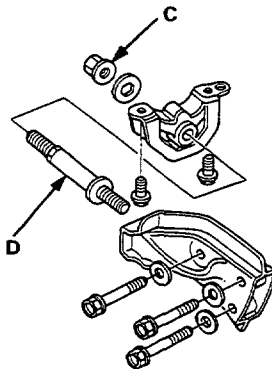

A/T:

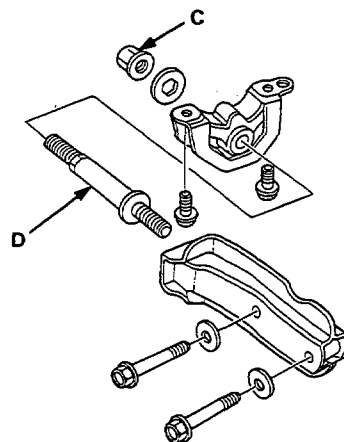

Torque Specifications:

- A: 10 x 1.25 mm
64 N·m (6.5 kgf·m, 47 lbf·ft)
- B: 12 x 1.25 mm
64 N·m (6.5 kgf·m, 47 lbf·ft)
- C: 12 x 1.25 mm
59 N·m (6.0 kgf·m, 43 lbf·ft)
Replace.
- D: 12 x 1.25 mm
83 N·m (8.5 kgf·m, 61 lbf·ft)