

Seat Belts

Front Seat Belt Replacement

CAUTION: Check the front seat belts for damage, and replace them if necessary. Be careful not to damage them during removal and installation.

Front seat belt removal:

1. Remove the following parts, and slide the front seat forward fully.
 - Front door sill molding (see page 20-55)
 - Rear door sill molding (see page 20-57)
 - Center pillar lower trim (see page 20-56)
 2. Remove all the anchor bolts, the retractor bolt and the retractor mounting bolt, then remove the front seat belt.
NOTE: When removing the anchor bolts and the retractor bolt, use a 17 mm socket or box-end wrench.
 3. Remove the center pillar upper trim (see page 20-56), then remove the shoulder anchor adjuster.
 4. Check that the retractor locking mechanism functions as described on page 20-74.
 5. Installation is the reverse of the removal procedure.
- NOTE:
- Make sure you assemble the washers and collars on the upper and lower anchor bolts (see page 20-71).
 - Before attaching the center pillar lower trim, make sure there are no twists or kinks in the front seat belt.

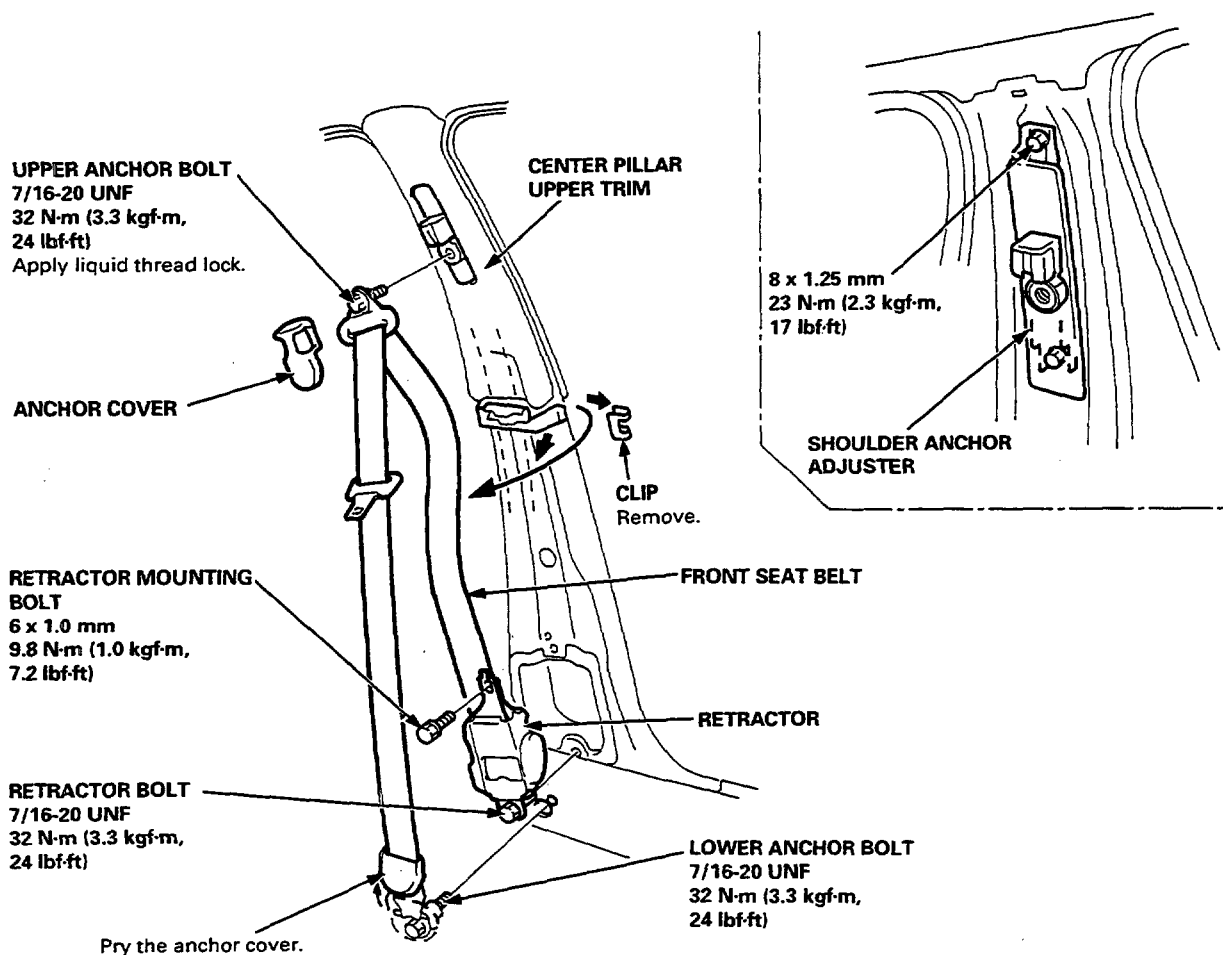



Seat belt buckle removal:

1. Remove the rear console (see page 20-77).
2. Slide the front seat until you can remove the center anchor bolt, then remove the seat belt buckle.
3. Installation is the reverse of the removal procedure.

NOTE: Make sure you assemble the washers and bearing on the center anchor bolt as shown.

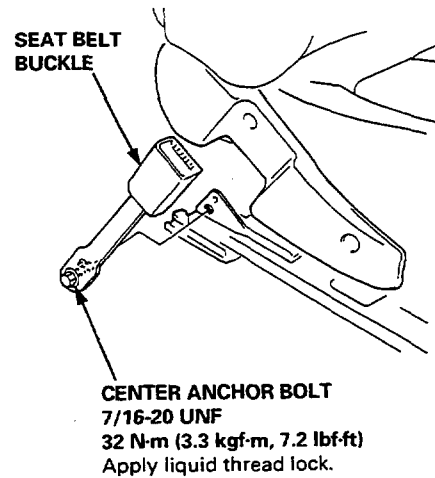

Upper and lower anchor bolt construction:

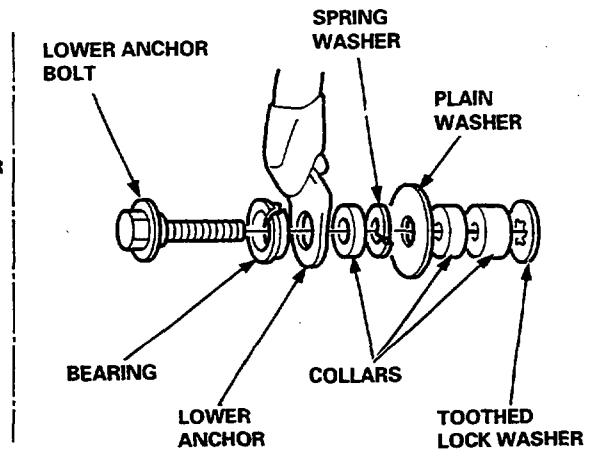
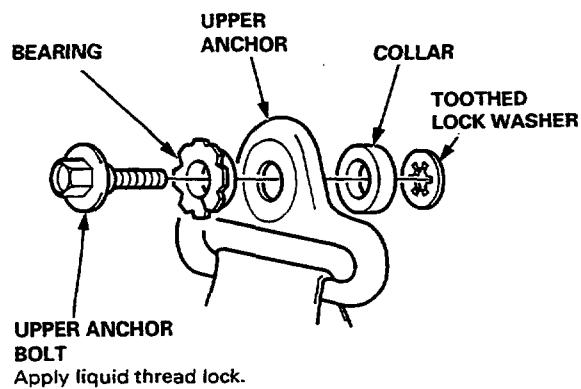

Center anchor bolt construction:

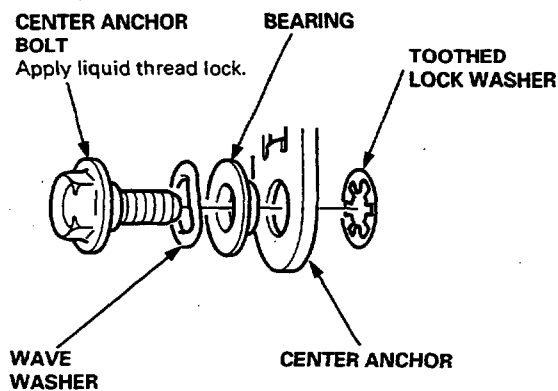

Retractor bolt construction:

