



Front Seat Linkage Disassembly

CAUTION: Wear gloves to remove and install the seat track and up-down adjuster.

1. Remove the front seat linkage from the front seat (see page 20-62).
2. Disassemble the front seat linkage as shown.

Slide adjustable:

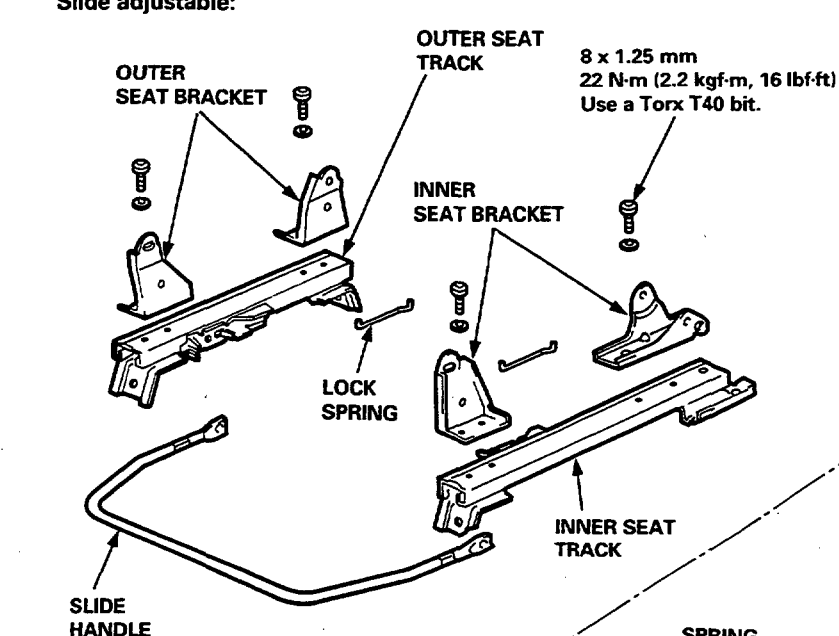

Slide/Up-down adjustable:

**UP-DOWN ADJUSTER/
SEAT BRACKETS**

8 x 1.25 mm
22 N-m (2.2 kgf-m, 16 lbf-ft)
Use a Torx T40 bit.

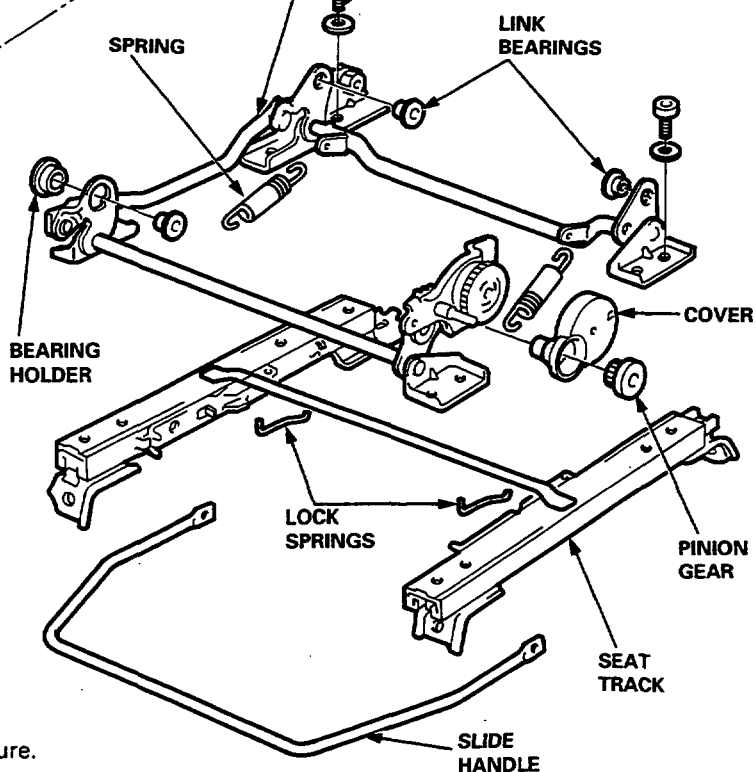
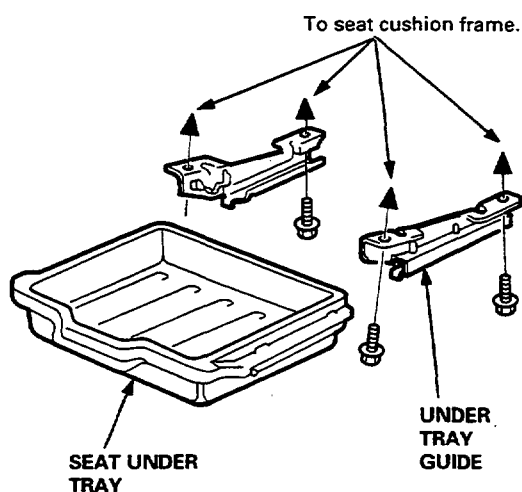

3. Installation is the reverse of the removal procedure.

NOTE:

- Apply grease (aeroshell grease 6) to the moving surface.
- Check the slide and height operations.