

Illustrated Index

Refer to the drawing below for the transmission disassembly/reassembly.
Clean all parts thoroughly in solvent and dry with compressed air.

 Lubricate all parts with oil before reassembly.

NOTE: This transmission uses no gaskets between the major housings; use liquid gasket (P/N 0Y740—99986). Assemble the housings within 20 minutes after applying the liquid gasket and allow it to cure at least 20 minutes after assembly before filling the transmission with oil. If 20 minutes have passed after applying liquid gasket, replace it.

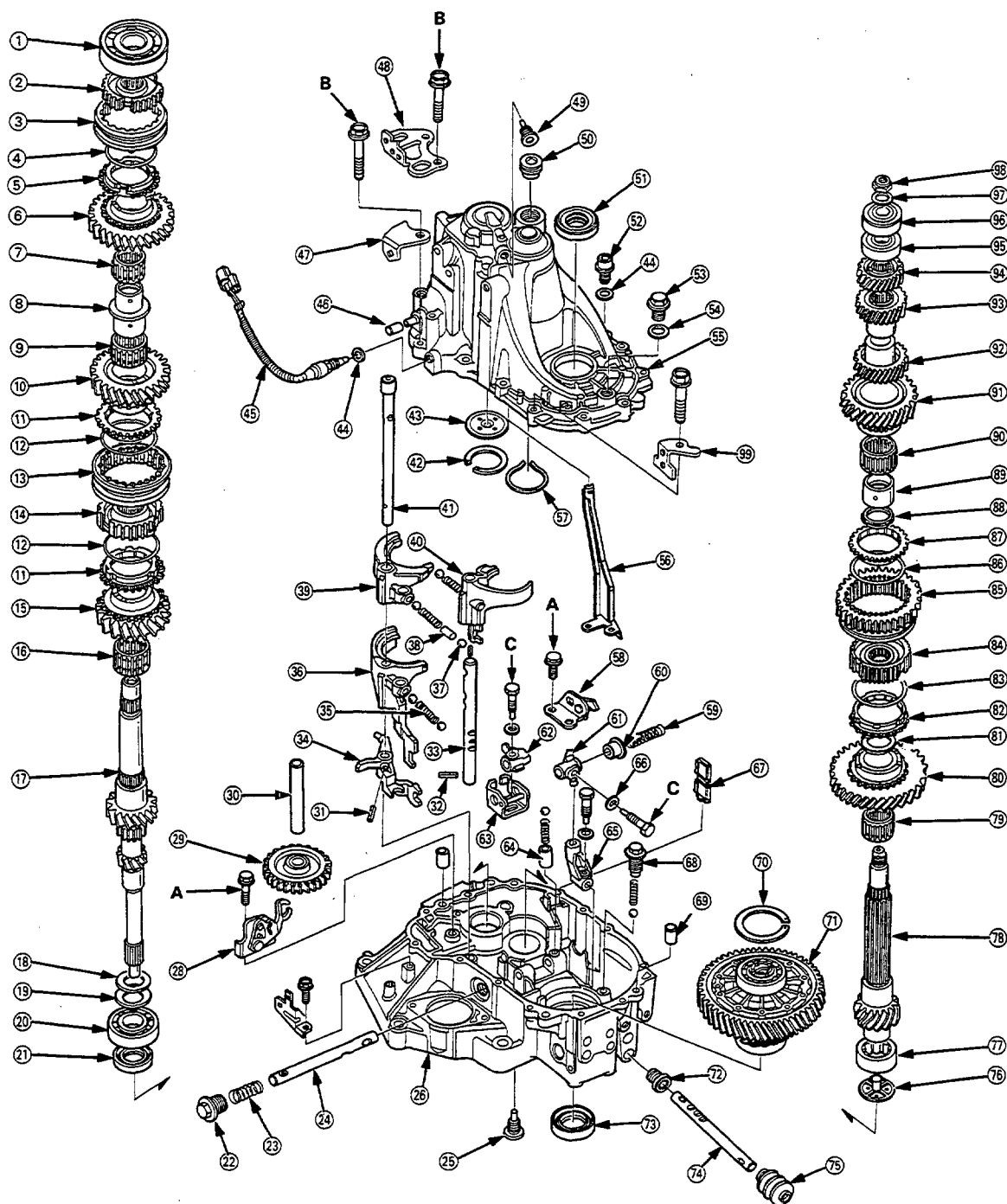



NOTE: Always clean the magnet ⑥7 whenever the transmission housing is disassembled.

Torque Value
A - 15 N·m (1.5 kgf·m, 11 lbf·ft)
B - 27 N·m (2.8 kgf·m, 20 lbf·ft)
C - 31 N·m (3.2 kgf·m, 23 lbf·ft)

- ① BALL BEARING
- ② 5TH SYNCHRO HUB
- ③ 5TH SYNCHRO SLEEVE
- ④ SYNCHRO SPRING
- ⑤ SYNCHRO RING
- ⑥ 5TH GEAR
- ⑦ 32 x 37 x 23.5 mm
NEEDLE BEARING
- ⑧ SPACER COLLAR
- ⑨ 34 x 39 x 23 mm
NEEDLE BEARING
- ⑩ 4TH GEAR
- ⑪ SYNCHRO RING
- ⑫ SYNCHRO SPRING
- ⑬ 3RD/4TH SYNCHRO SLEEVE
- ⑭ 3RD/4TH SYNCHRO HUB
- ⑮ 3RD GEAR
- ⑯ 34 x 39 x 27.5 mm
NEEDLE BEARING
- ⑰ MAINSHAFT
- ⑱ WASHER
- ⑲ SPRING WASHER
- ⑳ BALL BEARING
Check for wear and
operation.
- ㉑ 26 x 42 x 7 mm OIL SEAL
Replece.
- ㉒ 28 mm PLUG BOLT
54 N·m (5.5 kgf·m 40 lbf·ft)
- ㉓ 1ST/2ND SELECT SPRING
L. 36.26 mm (1.428 in)
- ㉔ SHIFT ARM SHAFT
- ㉕ INTERLOCK GUIDE BOLT
39 N·m (4.0 kgf·m, 29 lbf·ft)
- ㉖ CLUTCH HOUSING
- ㉗ REVERSE SHIFT HOLDER
- ㉘ REVERSE IDLER GEAR
- ㉙ REVERSE IDLER GEAR SHAFT
- ㉚ 5 x 22 mm SPRING PIN
Replece.
- ㉛ 3 x 12 mm SPRING PIN
Replece.
- ㉜ 1ST/2ND SHIFT FORK SHAFT
- ㉝ 5TH/REVERSE SHIFT PIECE
- ㉞ SPRING L. 17.3 mm (0.68 in)

- ㉟ 3RD/4TH SHIFT FORK
- ㊱ STEEL BALL (5/16 in)
- ㊲ 5 x 10 mm ROLLER
- ㊳ 5TH SHIFT FORK
- ㊴ 1ST/2ND SHIFT FORK
- ㊵ 5TH/REVERSE SHIFT FORK
SHAFT
- ㊶ 65 mm THRUST SHIM (*1)
- ㊷ 70 mm THRUST SHIM (*2)
Selection, page 13-30
- ㊸ OIL GUIDE PLATE
- ㊹ WASHER Replece.
- ㊺ BACK-UP LIGHT SWITCH
25 N·m (2.5 kgf·m, 18 lbf·ft)
- ㊻ BREATHER CAP
- ㊼ BACK-UP LIGHT
SWITCH HARNESS STAY
- ㊽ TRANSMISSION HANGER
- ㊾ 10 mm SEALING BOLT
9.8 N·m (1.0 kgf·m, 7.2 lbf·ft)
- ㊿ 32 mm SEALING BOLT
25 N·m (2.5 kgf·m, 18 lbf·ft)
- ① OIL SEAL
Replece.
- ② OIL DRAIN PLUG
39 N·m (4.0 kgf·m, 29 lbf·ft)
- ③ OIL FILLER PLUG
44 N·m (4.5 kgf·m, 33 lbf·ft)
- ④ WASHER Replece.
- ⑤ TRANSMISSION HOUSING
- ⑥ OIL GUTTER PLATE
- ⑦ 52 mm SNAP RING
- ⑧ REVERSE LOCK CAM
- ⑨ REVERSE SELECT SPRING
L. 63.4 mm (2.496 in)
- ⑩ REVERSE SELECT RETAINER
- ⑪ SHIFT ARM C
- ⑫ SHIFT ARM B
- ⑬ INTERLOCK
- ⑭ COLLAR
- ⑮ SHIFT ARM A
- ⑯ SPRING WASHER
- ⑰ MAGNET
- ⑱ SET BALL SPRING BOLT
22 N·m (2.2 kgf·m, 16 lbf·ft)

- ⑲ 14 x 20 mm DOWEL PIN
- ㉑ 72 mm THRUST SHIM (*1)
- ㉒ 80 mm THRUST SHIM (*2)
Selection, see section 15
- ㉓ DIFFERENTIAL ASSEMBLY
See section 15
- ㉔ 14 x 25 x 17.5 mm OIL SEAL
Replece.
- ㉕ 35 x 56 x 8 mm OIL SEAL
Replece.
- ㉖ SHIFT ROD
- ㉗ BOOT
- ㉘ OIL GUIDE PLATE
- ㉙ 30 x 47 x 21 mm
NEEDLE BEARING (*1)
- ㉚ 30 x 55 x 21 mm
NEEDLE BEARING (*2)
- ㉛ COUNTERSHAFT
- ㉜ 36 x 41 x 25.5 mm
NEEDLE BEARING
Check for wear and
operation.
- ㉝ 1ST GEAR
- ㉞ FRINCTION DAMPER
- ㉟ SYNCHRO RING
- ㊱ SYNCHRO SPRING
- ㊲ 1ST/2ND SYNCHRO HUB
- ㊳ REVERSE GEAR
- ㊴ SYNCHRO SPRING
- ㊵ SYNCHRO RING
- ㊶ FRICTION DAMPER
- ㊷ SPACER
- ㊸ 39 x 44 x 27 mm
NEEDLE BEARING
- ㊹ 2ND GEAR
- ㊿ 3RD GEAR
- ① 4TH GEAR
- ② 5TH GEAR
- ③ BALL BEARING (*1)
- ④ NEEDLE BEARING (*2)
- ⑤ BALL BEARING
- ⑥ SPRING WASHER
- ⑦ LOCKNUT
108-0-108 N·m
11.0-0-11.0 kgf·m,
79.6-0-79.6 lbf·ft
- ⑧ RELEASE PIPE STAY

*1: D14A2, D15Z3 engines

*2: D16Y2, D16Y3 engines