

# WRX WRX STI

## 2017 Quick Reference Guide



**SUBARU**

*Confidence in Motion*



**For detailed operating and safety information, please refer to your Owner's Manual.**

## BASIC OPERATION

### Lock/Unlock doors

#### Remote keyless entry system

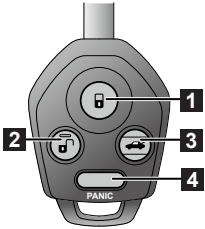

**Remote transmitter key (if equipped)**

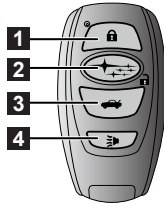

**Access key (if equipped)**

- 1** All doors will be locked.
- 2** The driver's door will be unlocked. (To unlock all doors, briefly press the button a second time within 5 seconds.)
- 3** Trunk lid will be opened.
- 4** The horn will sound and the hazard warning flashes will flash.

#### Keyless access function (if equipped)

All doors and trunk will be locked/unlocked by the following procedures carrying the access key on your person. (The driver should always carry the access key.)

##### Side door (front door handles only):

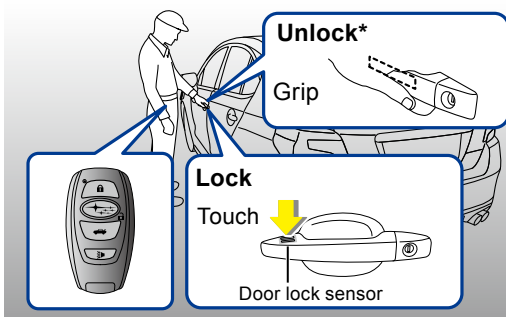

##### Opening trunk:

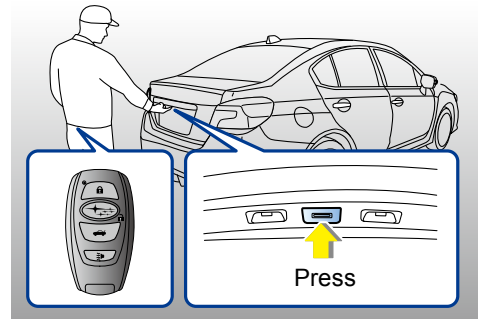

\*Grip the driver's door handle to unlock the driver's door. Grip the front passenger's door handle to unlock all doors.

## Adjust each component

### Front seat

Power seat (driver's seat - if equipped):

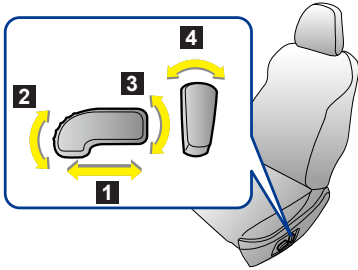

- 1 Forward and backward adjustment
- 2 Seat cushion angle adjustment
- 3 Seat height adjustment
- 4 Seatback reclining adjustment

Manual seat (if equipped):

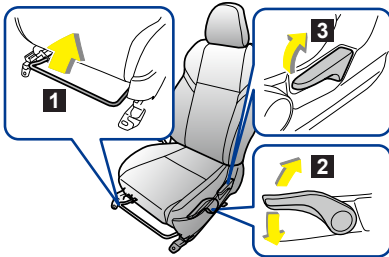

- 1 Forward and backward adjustment
- 2 Seat height adjustment (driver's seat only)
- 3 Seatback reclining adjustment

### Tilt/telescopic steering wheel

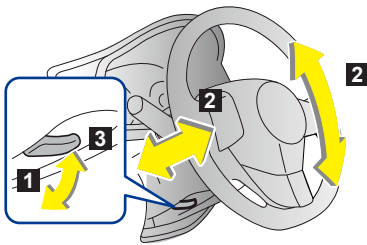

- 1 Adjust the seat position and pull the tilt/telescopic lock lever down.
- 2 Move the steering wheel to the desired level.
- 3 Pull the lever up to lock the steering wheel in place.

Make sure that the steering wheel is securely locked by moving it up and down, and forward and backward.

### Remote control mirror switch

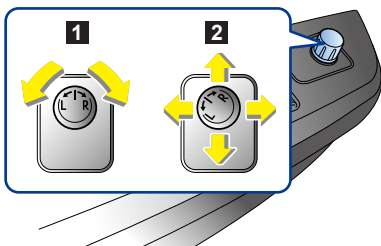

Ignition switch must be in **ACC** or **ON** position.

- 1 Select side to adjust.
- 2 To adjust the mirror, move the switch in direction of desired movement.

## Start/Stop engine

### Push-button ignition switch (if equipped)

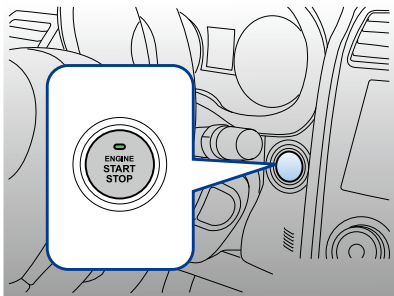

#### To start engine:

- STEP1:** Carry the access key, and sit in the driver's seat.
- STEP2:** Apply the parking brake.
- STEP3:** Shift the select lever in the **P** position (CVT models) or shift lever in neutral (MT models).
- STEP4:** Depress the brake pedal (CVT models) or brake pedal and clutch pedal (MT models) until the indicator on the push-button ignition switch turns green.
- STEP5:** While depressing the brake pedal (CVT models) or brake pedal and clutch pedal (MT models), press the push-button ignition switch.

#### To stop engine:

- STEP1:** Stop the vehicle completely.
- STEP2:** Move the select lever to the **P** position (CVT models) or shift lever in neutral (MT models).
- STEP3:** Apply the parking brake.
- STEP4:** Press the push-button ignition switch.

#### Change of the power supply (Without starting engine)

Every time the button is pressed without depressing the brake pedal (CVT models) or the clutch pedal (MT models), the power is switched in the sequence of **OFF→ACC→ON→OFF**.

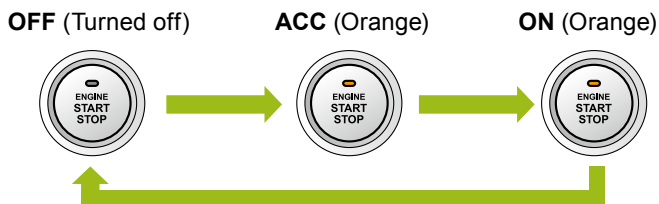

## Operate Select lever/Shift lever

### Continuously variable transmission (if equipped)

Select lever button

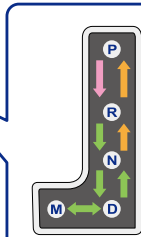
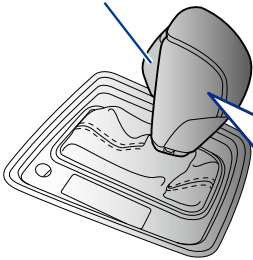

- With the brake pedal depressed, shift while pressing the button in
- Shift while pressing the button in
- Shift without pressing the button

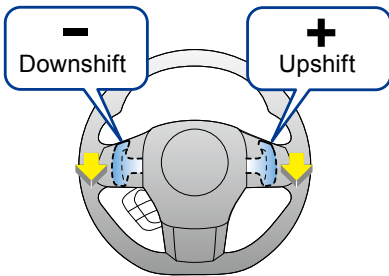

#### M = Manual mode:

With the vehicle either moving or stationary, move the select lever from the **D** position to the **M** position to select the manual mode.

#### Shift paddle:

Gearshifts can be performed using the shift paddle behind the steering wheel.

### Manual transmission (if equipped)

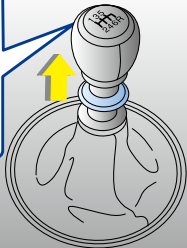
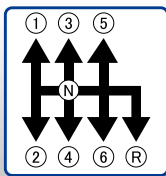

You must raise the slider and hold it in that position before you can move the shift lever to the **R** position. To change gears, fully depress the clutch pedal, move the shift lever, and gradually let up on the clutch pedal.

# MAIN PARTS AND OPERATION

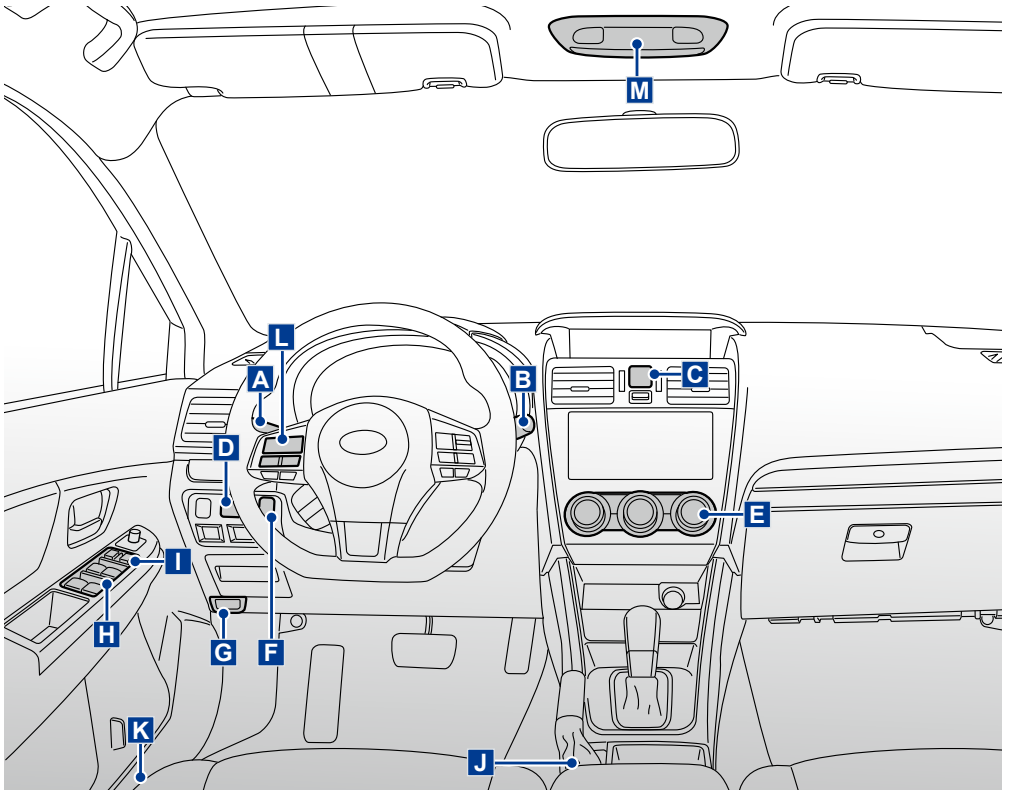

## A Headlights/Turn signal/Fog lights (if equipped)

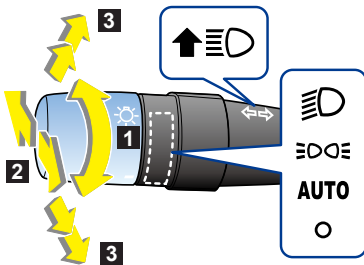

- 1** Headlights
- 2** Headlight flasher, High/Low beam change
- 3** Turn signal

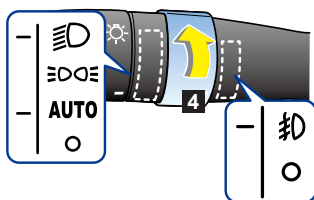

### **4** Fog lights (if equipped):

To turn on, rotate dial to .

Front fog lights operate only when headlight switch is in...

-  position.
- **AUTO** position and the headlights are on.

## B Windshield wiper and washer

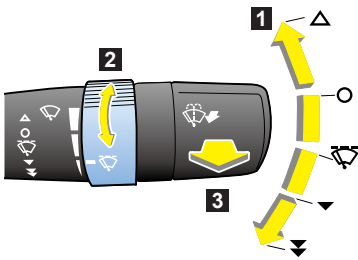

### 1 Wiper:

- △ : Mist (for a single wipe)
- : Off
- ⏏ : Intermittent
- ▼ : Low speed
- ⏏▼ : High speed

### 2 Intermittent interval

### 3 Washer

## C Hazard warning flasher

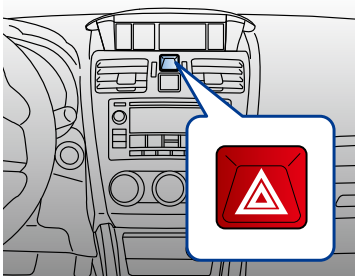

To turn on, press the button.  
Use in emergency conditions.

## D Illumination brightness control

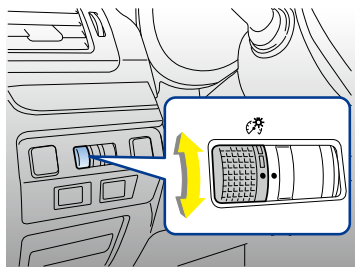

To adjust the illumination brightness of the combination meter, the climate control panel, etc., turn the dial.

- To brighten, turn the dial upward.
- To darken, turn the dial downward.

## E Defroster button/Rear window defogger button

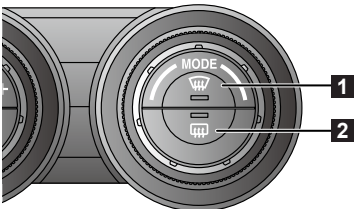

### 1 Defroster button:

Press this button to defrost windshield.

### 2 Rear window defogger button:

Press the button to turn on rear window defogger, outside mirror defogger and wiper deicer. The function will automatically shut off after approximately 15 min.

\*The illustration of the print is Type A.

## F Trunk lid opener switch

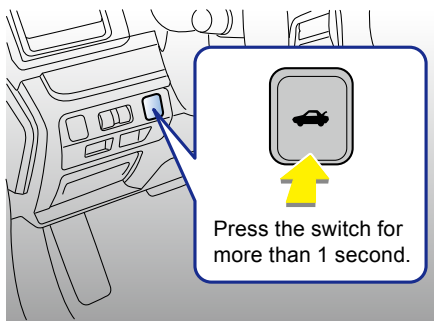

## G Hood release knob

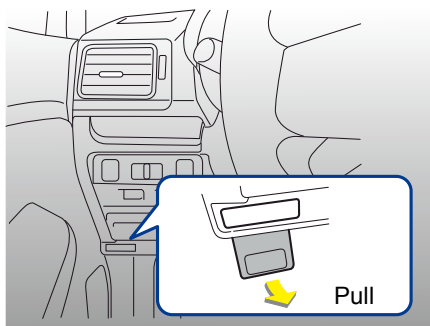

## H Power windows

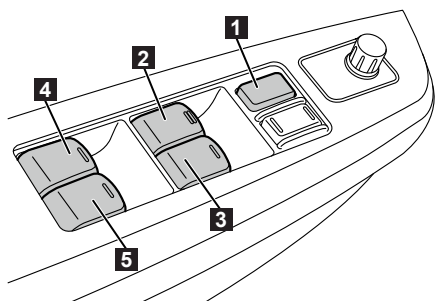

- 1 Lock switch
- 2 For driver's window
- 3 For front passenger's window
- 4 For rear left window
- 5 For rear right window

## I Power door locking switch

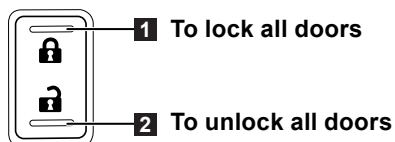



## J Seat heater (if equipped)

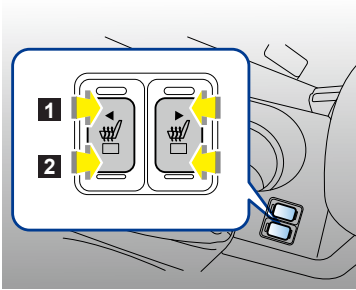

Type A

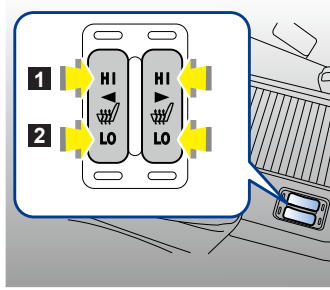

Type B

- 1 HIGH (HI):**  
Rapid heating
- 2 LOW (LO):**  
Normal heating

## K Fuel filler lid release lever

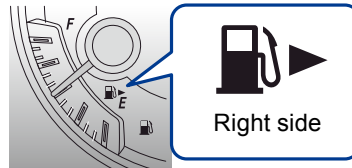
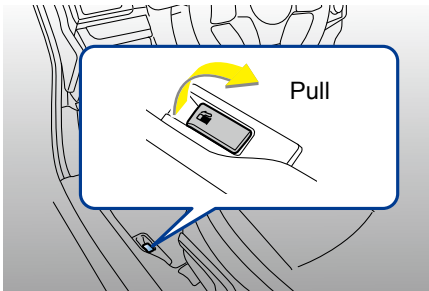

This indicates that the fuel filler door (lid) is located on the right side of the vehicle.

## L Audio control buttons

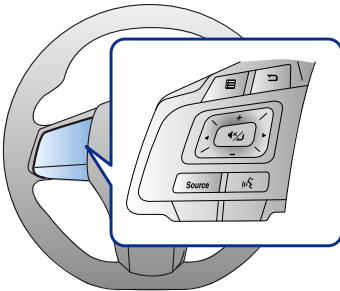

These buttons allow the driver to control audio functions without taking his/her hands off the steering wheel.

## M Moonroof switch (if equipped)

### Tilting

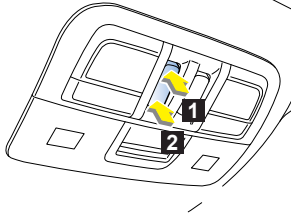

- 1 Raise
- 2 Lower

### Sliding

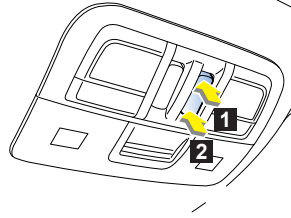

- 1 Open
- 2 Close

## Child safety locks

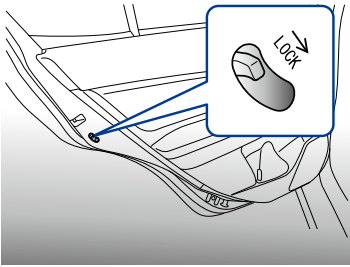

Located on the edge of the rear doors.

While the lever is in the lock position, rear door cannot be opened from the inside.

## Front seat shoulder belt anchor height

### To lower

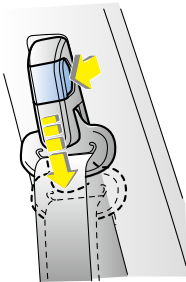

Pull the upper part of the anchor and slide the anchor down.

### To raise

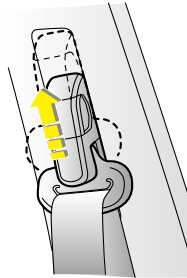

Slide the anchor up.

# FUNCTION FOR MORE COMFORTABLE DRIVE

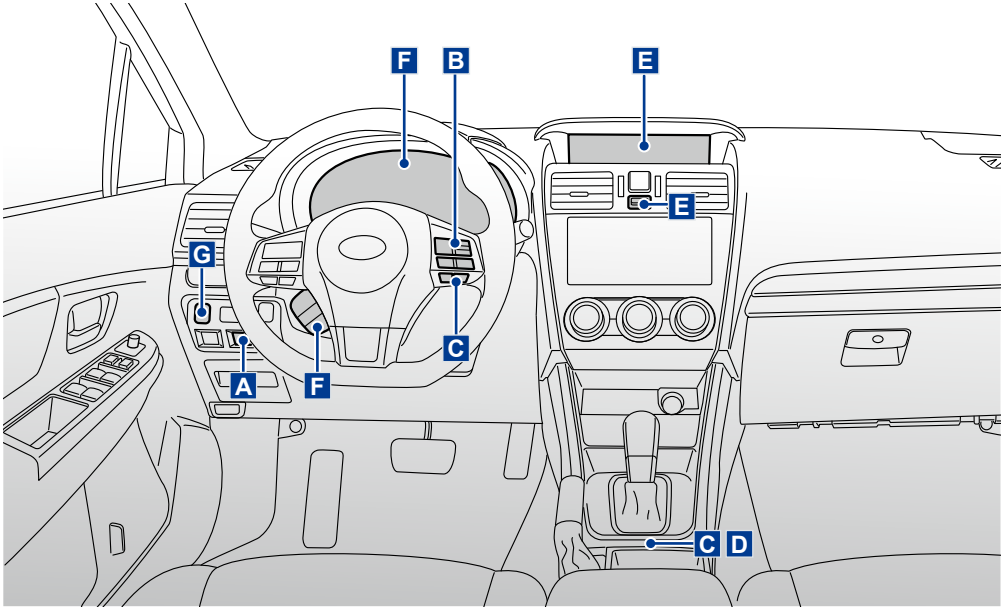

## A Vehicle Dynamics Control OFF switch

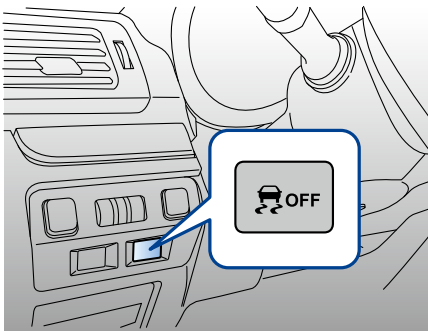

### Indicator lights on the combination meter



Vehicle Dynamics Control mode



Vehicle Dynamics Control OFF mode



Traction mode

Press the switch to deactivate the Vehicle Dynamics Control system. It may be useful to briefly deactivate the Vehicle Dynamics Control system to facilitate the following operations.

- a standing start on a steeply sloping road with a snowy, gravel-covered, or otherwise slippery surface
- extrication of the vehicle when its wheels are stuck in mud or deep snow

Do not deactivate the system except when absolutely necessary.

## B Cruise control

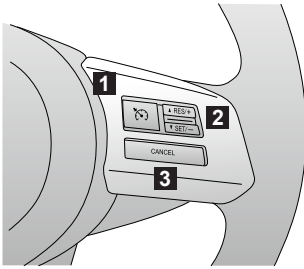

Cruise control enables you to maintain a constant vehicle speed without holding your foot on the accelerator pedal and it is operative when the vehicle speed is 40 km/h (25 mph) or more.

- 1 Cruise control main button :**  
To activate and deactivate
- 2 RES/SET switch :**
  - ▲ RES/+ side: To increase the speed
  - ▼ SET/- side : To set speed/To decrease the speed
- 3 CANCELbutton : To temporarily cancel**



### Cruise control indicator

The cruise control main button is pressed to activate the cruise control function.



### Cruise control set indicator

The vehicle speed has been set to use the cruise control function.

## C SI-DRIVE switches (if equipped)

This system consists of three modes: Intelligent (I), Sport (S), and Sport Sharp (S#). By operating the SI-DRIVE switches & selector, the character of the power unit changes.

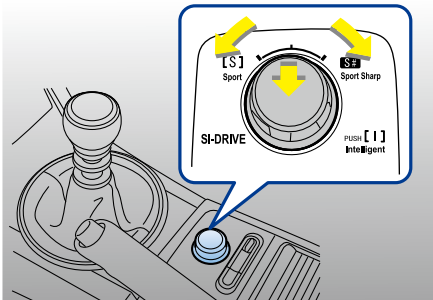

SI-DRIVE selector (STI models)

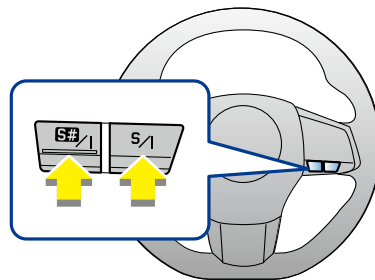

SI-DRIVE switches (except STI)

- Intelligent (I) mode** : This mode is ideal for normal driving usage.
- Sport (S) mode** : This mode is ideal for the run of an expressway and an uphill slope.
- Sport Sharp (S#) mode** : This mode is ideal for tackling twisting roads and for merging or overtaking other vehicles on the freeway with confidence.

## D Driver's Control Center Differential (DCCD) (STI models)

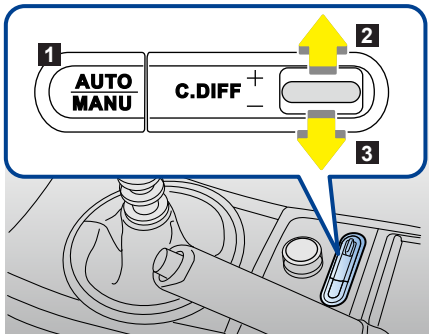

### DCCD indicator

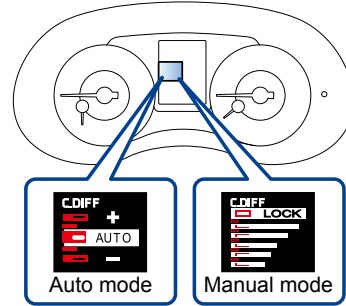

The driver's control center differential allows you to freely change the degree of limitation of the differential action (limited slip differential (LSD) torque) of the vehicle's center differential.

**1 AUTO-MANU switch** : Press the switch from auto mode to manual mode or vice versa.

#### Auto mode:

**2 AUTO[+]mode** : Push the control switch forward.

**3 AUTO[-] mode** : Pull the control switch rearward.

#### Manual mode:

When the **LOCK** indicator light illuminates, the initial LSD torque setting is maximum.

**2 To increase the initial LSD torque**: Push the control switch forward.

**3 To reduce the initial LSD torque** : Pull the control switch rearward.

## E Multi function display

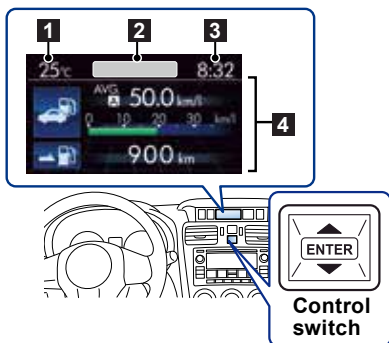

- 1 Outside temperature indicator
- 2 Top display
- 3 Clock
- 4 Driving information display

**Control switch:** By operating ▲ or ▼ of the control switch, the screens and selection items can be switched. When the **ENTER** button is pushed and held, the item can be selected and set.

## F Multi information display

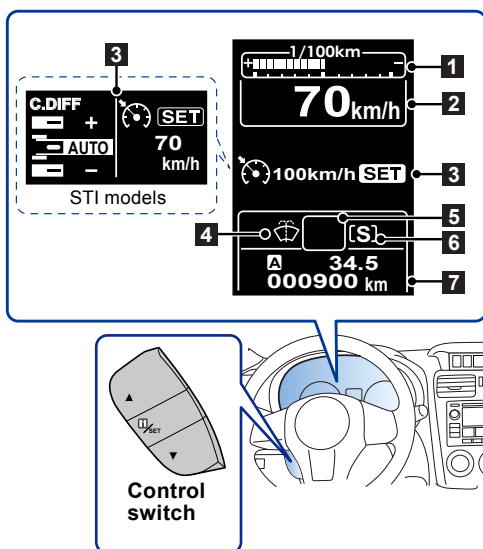

- 1 ECO gauge
- 2 Warning screen/Basic screen
- 3 Cruise control information/DCCD indicator (STI models)
- 4 Warning indicator
- 5 Select lever/gear position indicator
- 6 SI-DRIVE indicator light
- 7 Odometer/double trip meter

**Control switch:** By operating ▲ or ▼ of the control switch, the screens and selection items can be switched. When the **i/SET** switch is pulled toward you, the item can be selected and set.

## **G** BSD/RCTA OFF switch (if equipped)

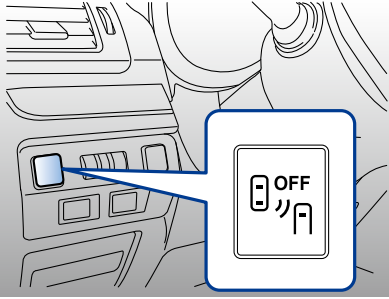

If the BSD/RCTA OFF switch is pressed, the BSD/RCTA warning indicator and BSD/RCTA OFF indicator are displayed on the multi information display of the combination meter, and the BSD/RCTA is deactivated.

### **BSD/RCTA**

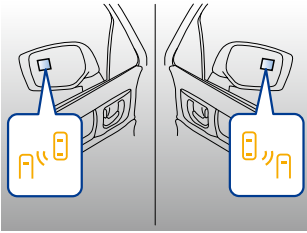

The BSD/RCTA consists of rear radar with Blind Spot Detection, Lane Change Assist and Rear Cross Traffic Alert.

The system notifies the driver when vehicles in the blind area are approaching from behind in the neighboring lanes.

# MAIN WARNING AND INDICATOR LIGHTS

Some warning/indicator lights illuminate for a few seconds in order to check themselves when the ignition switch is turned ON.

## Warning lights

Refer to your Owner's Manual for countermeasures when each warning light comes on. If necessary, consult your authorized SUBARU dealer.

### Seatbelt warning



Remind the driver to fasten seatbelt.

### Front passenger's seatbelt warning



Remind the front passenger to fasten seatbelt. Location: next to multi function display.

### Malfunction indicator (Check Engine)



Engine/Emission control system malfunction.

### Charge warning



Charging system malfunction.

### Oil pressure warning



Engine oil pressure is too low.

### Engine oil level warning (except STI)



The engine oil level decreases to the lower limit.

### Power steering warning (except STI)



The electric power steering system malfunction.

### SRS airbag system warning



SRS airbag system and/or seatbelt pretensioners malfunction.

### Rear differential oil temperature warning (STI)



Rear differential oil temperature is too hot.

### AT OIL TEMP warning (CVT models)



Transmission fluid temperature is too hot/Transmission control system malfunction.

### Door open warning



Door or trunk lid is ajar.

### Low fuel warning



Fuel level low. Refill fuel immediately.

### Brake system warning



Parking brake on/Low fluid level/EBD System malfunction (Anti-lock brake system warning light illuminates simultaneously)/Vacuum pump system malfunction (except STI)



### All-wheel drive warning



All-Wheel Drive disengaged/tires of different diameter fitted.

### Windshield washer fluid warning



The fluid level in the windshield washer fluid tank decreases to the lower limit.

### Access key warning



The access key is not inside the vehicle. For other situations, refer to your Owner's Manual.

### LED headlight warning



The LED headlights malfunction.

### Automatic headlight beam leveler warning



This light illuminates when the automatic headlight beam leveler does not operate normally.

### ABS warning



Anti-lock Brake System malfunction/EBD System malfunction (Brake System warning light illuminates simultaneously).

### Vehicle Dynamics Control warning/Vehicle Dynamics Control operation indicator



**Warning** : Vehicle Dynamics Control system malfunction.

**Indicator** : Flashes during activation of the skid suppression function and the traction control function.

### BSD/RCTA warning



Blind Spot Detection/Rear Cross Traffic Alert (BSD/RCTA) malfunction.

### Hill start assist warning/Hill start assist OFF indicator

















**Warning** : Hill start assist system malfunction.

**Indicator** : Hill start assist system OFF.

## Indicator lights

The following indicators show the current status of your car. Refer to your Owner's Manual for more information.

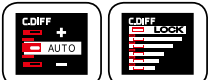
	<b>Turn signal indicator</b>		<b>Headlight indicator</b>		<b>High beam indicator</b>
	<b>Front fog light indicator</b>		<b>Security indicator</b>		<b>Traction mode indicator</b>
	<b>BSD/RCTA OFF indicator</b>		<b>Cruise control indicator</b>		<b>Cruise control set indicator</b>
	<b>Front passenger's frontal airbag ON/OFF indicator</b>		<b>Vehicle Dynamics Control OFF indicator</b>		
	<b>REV indicator (STI)</b>		<b>Shift up indicator (STI)</b>		
	<b>SI-DRIVE mode indicator</b>		<b>DCCD indicator (STI)</b>		



subaru.ca

All illustrations, specifications, features and photographs contained in this brochure are based on product information available at the time of its printing, and may not be completely accurate following its publication. Colours shown may vary due to reproduction variations in the printing process, and some vehicle parts cannot be shown in certain photographs. Subaru Canada, Inc. reserves the right to discontinue or make changes at any time, without notice or incurring obligations, to colours, materials, equipment, accessories, features, specifications and models, or to change their prices. Please visit our Web site for the latest information and specifications. For detailed operating and safety information, please consult your Owner's Manual. For complete details on product updates, warranties or the Subaru C.A.R.E. program, please contact your Subaru dealer. WRX, WRX STI and Subaru are registered trademarks. Printed in Canada. © 2016 Subaru Canada, Inc. 2017 model year.



**Environmental Management System (EMS)**  
**ISO 14001:2004 certified by SGS**  
[www.subaru-earth.com](http://www.subaru-earth.com)

SUBARU CANADA, INC. / FUJI HEAVY INDUSTRIES LTD.