

IMPREZA

2016 Quick Reference Guide



SUBARU

Confidence in Motion



For detailed operating and safety information, please refer to your Owner's Manual.

BASIC OPERATION

Lock/ Unlock doors

Remote keyless entry system

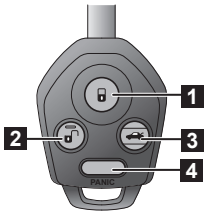

Remote transmitter key (if equipped)

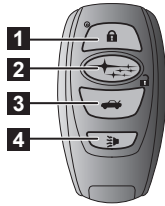

Access key (if equipped)

- 1** All doors and the rear gate (5-door) will be locked.
- 2** The driver's door will be unlocked. (To unlock all doors and the rear gate (5-door), briefly press the button a second time within 5 seconds.)
- 3** Press and hold to open the trunk lid (4-door)/ Press the button to open the rear gate (5-door).
- 4** The horn will sound and the hazard warning flashes will flash.

Keyless access function (if equipped)

All doors and the rear gate (5-door) will be locked/ unlocked by the following procedures carrying the access key on your person. (The driver should always carry the access key.)

Side door (front door handles only):

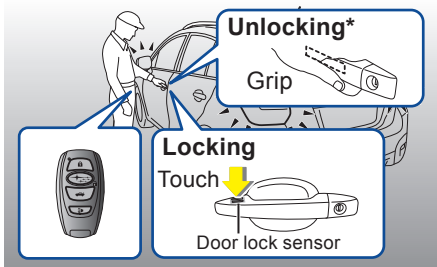

*Grip the driver's door handle to unlock the driver's door. Grip the front passenger's door handle to unlock all doors and the rear gate (5-door).

Opening trunk (4-door):

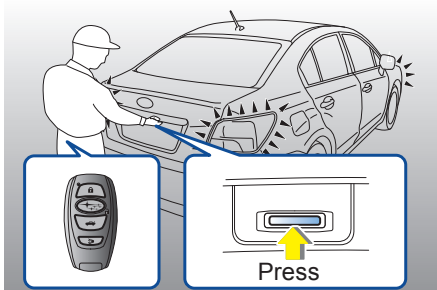

Rear gate (5-door):

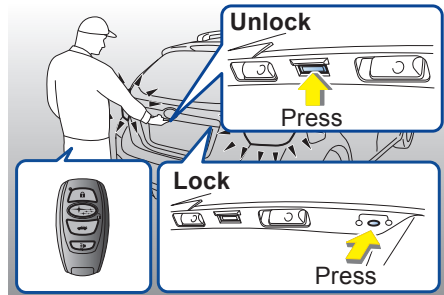

Adjustable components

Front seat

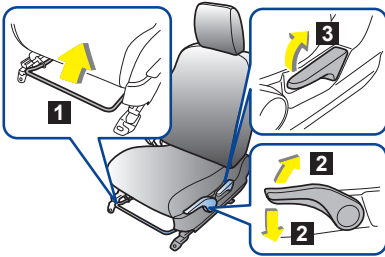

- 1 Forward and backward adjustment
- 2 Seat cushion height adjustment (Driver's seat only)
- 3 Seatback reclining adjustment

Tilt/ telescopic steering wheel

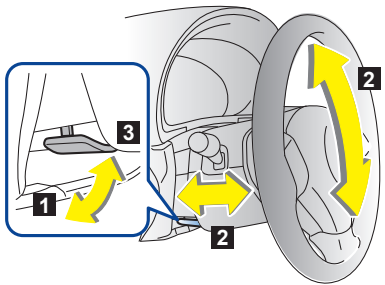

- 1 Adjust the seat position and pull the tilt/ telescopic lock lever down.
- 2 Move the steering wheel to the desired level.
- 3 Pull the lever up to lock the steering wheel in place.

Make sure that the steering wheel is securely locked by moving it up and down, and forward and backward.

Remote control mirror switch

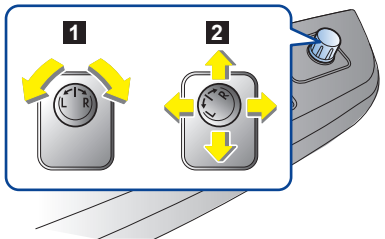

Ignition switch must be in **ACC** or **ON** position.

- 1 Select side to adjust.
- 2 To adjust the mirror, move the switch in the direction of your desired position.

Start/ Stop engine

Push-button ignition switch (if equipped)

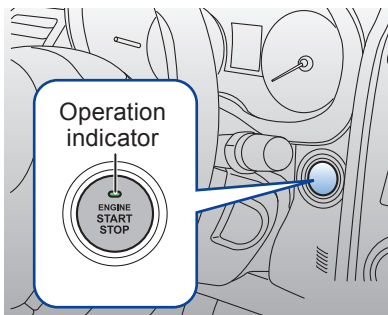

To start engine:

1. Carry the access key, and sit in the driver's seat.
2. Apply the parking brake.
3. Shift the select lever into the **P** position.
4. Depress the brake pedal until the indicator on the push-button ignition switch turns green.
5. While depressing the brake pedal, press the push-button ignition switch.

To stop engine:

1. Stop the vehicle completely.
2. Move the select lever to the **P** position .
3. Press the push-button ignition switch.

Change of the power supply (Without starting engine)

Every time the button is pressed without depressing the brake pedal, the power is switched in the sequence of **OFF**→**ACC**→**ON**→**OFF**.

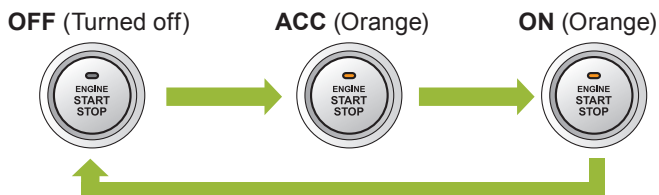

Ignition switch (if equipped)

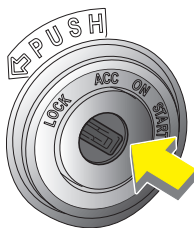

The key can be turned from **ACC** to **LOCK** only when the key is pushed in while turning it (all models) and the select lever is in the **P** position (CVT models).

Operate Select lever/ Shift lever

Continuously variable transmission (if equipped)

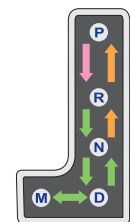
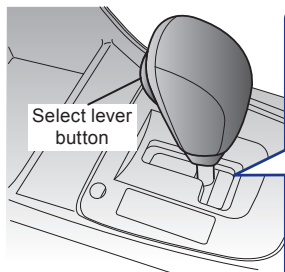

Models with manual mode

- With the brake pedal depressed, shift while pressing the Select lever button in.
- Shift while pressing the Select lever button in.
- Shift without pressing the Select lever button.

M = Manual mode

With the vehicle either moving or stationary, move the select lever from the **D** position to the **M** position to select the manual mode.

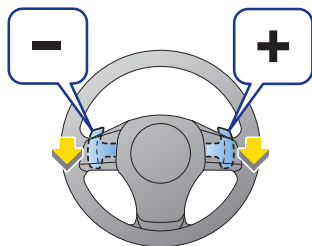

Gearshifts can be performed using the shift paddle behind the steering wheel.

To upshift to the next higher gear position, pull the shift paddle that has **+** indicated on it. To downshift to the next lower gear position, pull the shift paddle that has **-** indicated on it.

Rear view camera

When the ignition switch is **ON** and the select lever is set to **R**, the rear view camera automatically displays the rear view image behind the vehicle.

Manual transmission (if equipped)

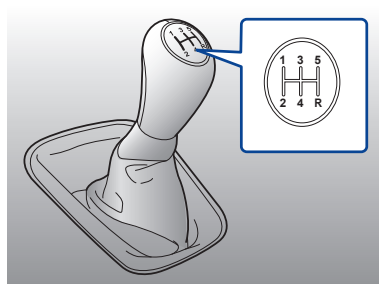

To change gears, fully depress the clutch pedal, move the shift lever, and gradually let up on the clutch pedal.

DRIVER'S AREA

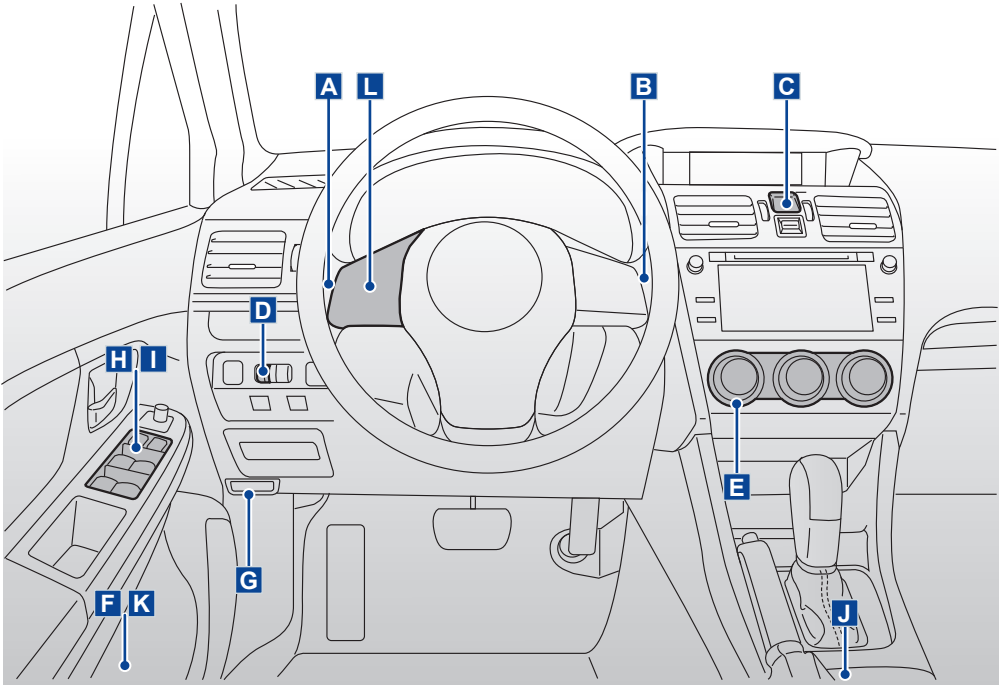

A Headlight switch/ Turn signal lever/ Front fog light switch (if equipped)

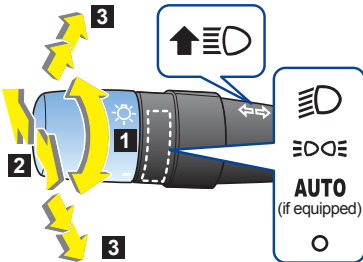

- 1 Headlights
- 2 Headlight flasher, High/Low beam change
- 3 Turn signal

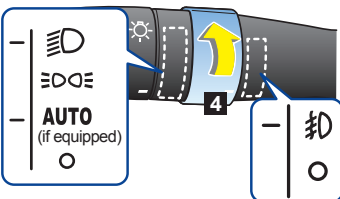

4 Front fog lights (if equipped)

To turn on the front fog lights, rotate dial to .

Front fog lights operate only when headlight switch is in:

-  position.
- **AUTO** position and the headlights are on.

B Wiper and washer switch

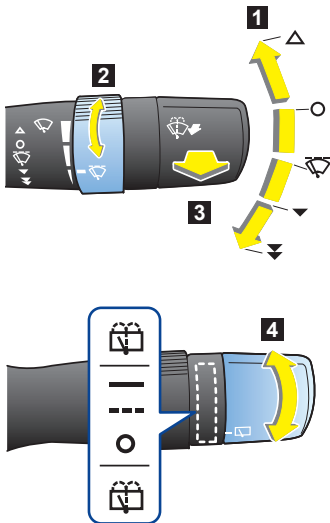

1 Windshield wiper

To operate the wiper, rotate knob to;

- △ : Mist (for a single wipe)
- : Off
- 🚧 : Intermittent
- ▼ : Low speed
- ▼ : High speed

2 Wiper intermittent time control

3 Windshield washer

4 Rear window wiper and washer (5-door)

To operate the wiper, rotate knob to;

- : Continuous
- - - : Intermittent
- : Off
- 🚧 : Washer

Rotate knob to 🚧. The washer fluid sprays and the wiper operates.

C Hazard warning flasher switch

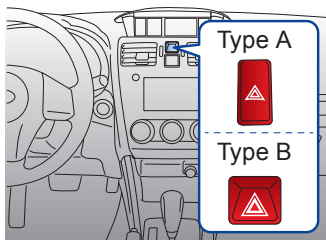

To turn on the hazard warning flasher, push the button. Use the hazard warning flasher when you have to park under emergency conditions.

D Illumination brightness control dial

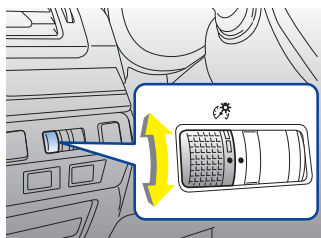

Turn the dial to adjust the illumination brightness of the instrument panel.

To brighten, turn the control dial upward.

To darken, turn the control dial downward.

When the control dial is turned fully upward, the illumination brightness becomes the maximum and the automatic dimming function does not work at all.

*The design may be slightly different from the illustration depending on the models.

E Defroster button/ Rear window defogger button

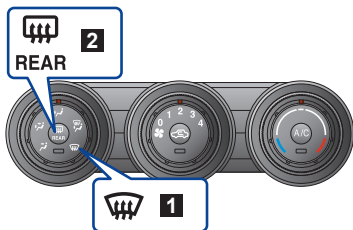

1  **Defroster button:**
Press the button to defrost the windshield.

2  **Rear window defogger button:**
Press the button to turn on rear window defogger, outside mirror defogger or windshield wiper deicer (if equipped). The function will automatically shut off after approximately 15 minutes.

*The illustration of the print is Type A.

F Trunk lid release lever (4-door)

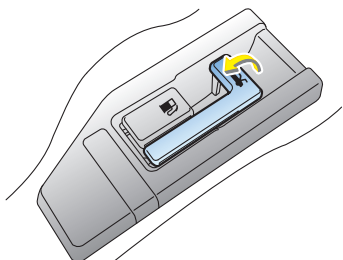

To open the trunk lid, pull the lever upward.

Internal trunk lid release handle

To open the trunk lid from inside the trunk, pull the handle upward.

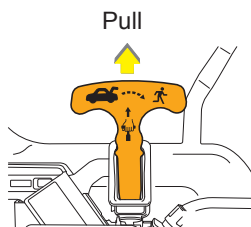

G Hood lock release knob

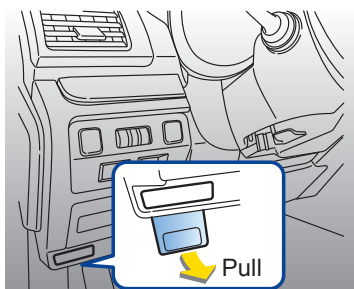

H Power window switches

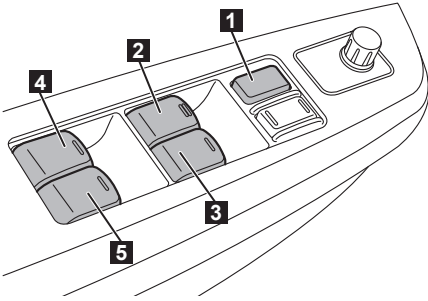

- 1** Lock switch
- 2** For driver's window (with one-touch auto up and down feature)
- 3** For front passenger's window
- 4** For rear left window
- 5** For rear right window

I Power door locking switch



To lock all doors and the rear gate (5-door)

To unlock all doors and the rear gate (5-door)

J Seat heater (if equipped)

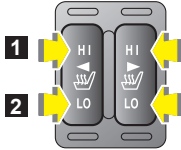

- 1** HI : Rapid heating
- 2** LO : Normal heating

K Fuel filler lid release lever

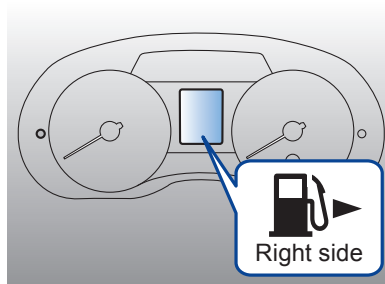
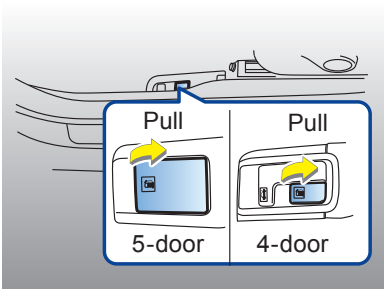

This indicates that the fuel filler door (lid) is located on the right side of the vehicle.

L Audio control buttons

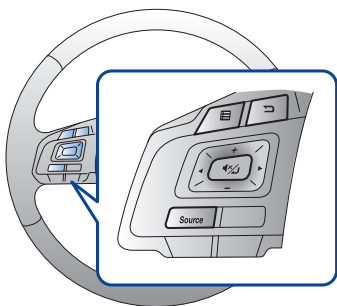

These buttons allow the driver to control audio functions without taking his/ her hands off the steering wheel.

Moonroof switches (if equipped)

Tilting

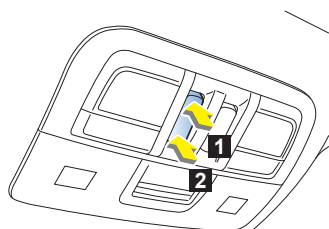

- 1 Raise
- 2 Lower

Sliding

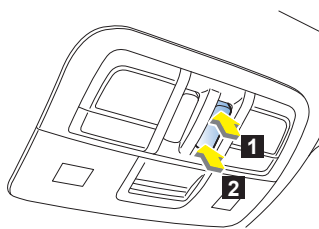

- 1 Open
- 2 Close

Child safety locks

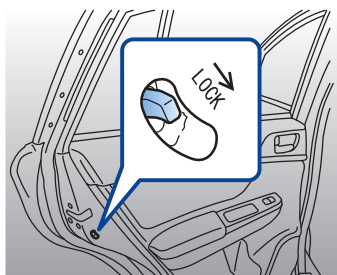

Located on the edge of each rear door. When the lever is in the **LOCK** position, the rear door cannot be opened from the inside.

Front seat shoulder belt anchor height

To lower

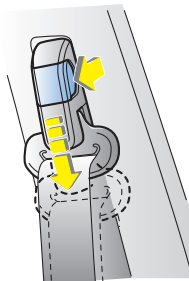

Pull the upper part of the anchor and slide the anchor down.

To raise

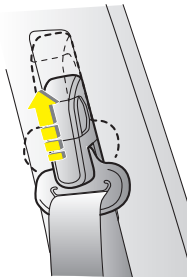

Slide the anchor up.

VEHICLE PERFORMANCE FUNCTIONS

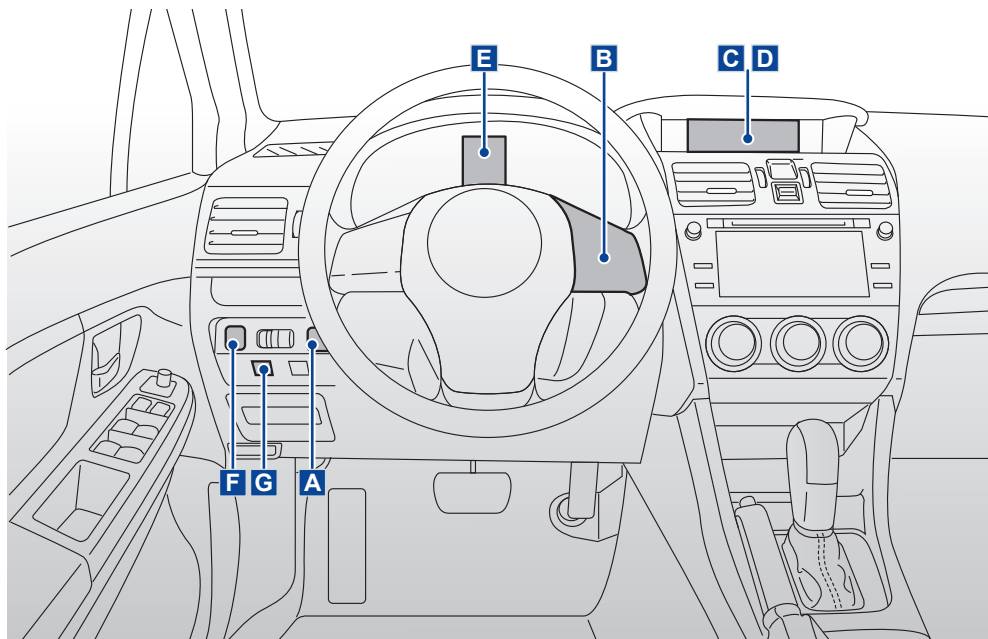

A Vehicle Dynamics Control OFF switch

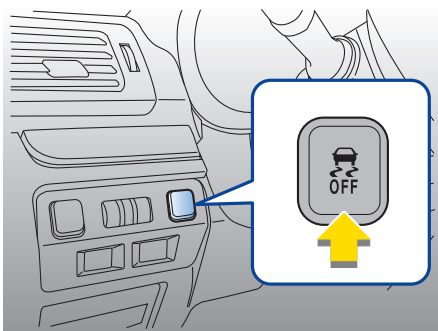

Indicator lights on the combination meter



Vehicle Dynamics Control mode



Vehicle Dynamics Control OFF mode

Press the switch to deactivate the Vehicle Dynamics Control system. It may be useful to briefly deactivate the Vehicle Dynamics Control system to facilitate the following operations.

- a standing start on a steeply sloping road with a snowy, gravel-covered, or otherwise slippery surface
- extrication of the vehicle when its wheels are stuck in mud or deep snow

Do not deactivate the system except when absolutely necessary.

B Cruise control buttons (if equipped)

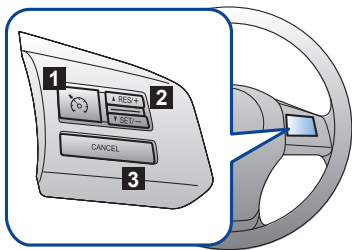

Cruise control enables you to maintain a constant vehicle speed without holding your foot on the accelerator pedal and it is operative when the vehicle speed is 40 km/h (25 mph) or more.

1 Cruise control main button: To activate and deactivate

2 RES/ SET switch

▲ RES/+ side: To increase the speed/ To resume

▼ SET/- side: To set speed/ To decrease the speed

3 CANCEL button: To temporarily cancel

C Information display (if equipped)

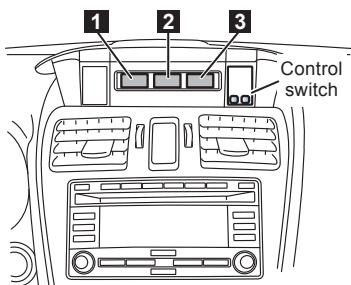

1 Outside temperature indicator

2 Driving information display

3 Clock

Control switch: To adjust the time shown by the clock, press the + button or the - button.

D Multi function display (if equipped)

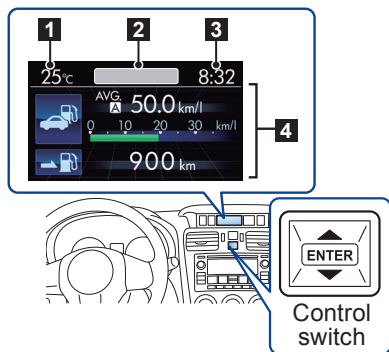

- 1 Outside temperature indicator
- 2 Top display
- 3 Clock
- 4 Driving information display

Control switch: By operating ▲ or ▼ of the control switch, the screens and selection items can be switched. When the **ENTER** button is pushed, the item can be selected and set.

E Multi information display (if equipped)

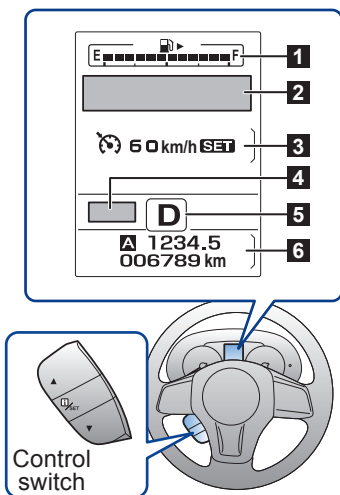

- 1 Fuel gauge
- 2 Warning screen/ Basic screen
- 3 Cruise control information display
- 4 Warning indicator
- 5 Select lever/ gear position indicator
- 6 Odometer/ double trip meter

Control switch: By operating ▲ or ▼ of the control switch, the screens and selection items can be switched. When the **i/SET** switch is pulled toward you, the item can be selected and set.

F Steering responsive fog lights OFF switch (if equipped)

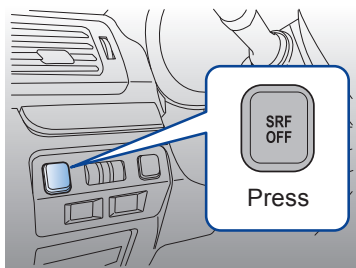

If the steering responsive fog lights OFF switch is pressed, the steering responsive fog lights OFF indicator is displayed on the Multi information display of the combination meter, and the steering responsive fog lights system is deactivated.

Steering responsive fog lights system

The steering responsive fog lights system automatically turns the front fog light on and off based on the steering angle and vehicle speed when entering a curve or driving on curved roads.

The system is intended to help prevent accidents by enabling better visibility of curves ahead and early recognition of any disabled vehicles or other obstacles.

G BSD/ RCTA OFF switch (if equipped)

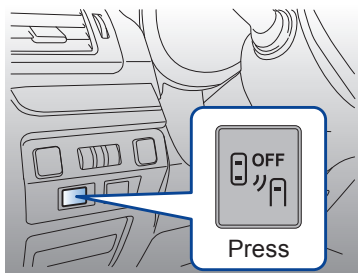

If the BSD/ RCTA OFF switch is pressed, the BSD/ RCTA warning indicator and BSD/ RCTA OFF indicator are displayed on the multi information display of the combination meter, and the BSD/ RCTA is deactivated.

BSD/ RCTA

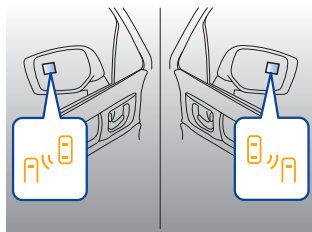

The BSD/ RCTA consists of rear radar with Blind Spot Detection, Lane Change Assist and Rear Cross Traffic Alert.

The system notifies the driver when vehicles in the blind area are approaching from behind in the neighboring lanes.

MAIN WARNING AND INDICATOR LIGHTS

Some warning/ indicator lights illuminate for a few seconds in order to check themselves when the ignition switch is turned ON.

Warning lights

Refer to your Owner's Manual for countermeasures when each warning light comes on. If necessary, consult your authorized SUBARU dealer.

Seatbelt warning



Remind the driver to fasten seatbelt.

Charge warning



Charging system malfunction.

Front passenger's seatbelt warning



Remind the front passenger to fasten seatbelt.

Location: next to Information display/Multi function display.

CHECK ENGINE warning/ Malfunction indicator



Engine/Emission control system malfunction.

Oil pressure warning



The engine oil pressure is too low.

Engine low oil level warning



The engine oil level decreases to the lower limit.

All-wheel Drive warning (CVT models)



Tires of different diameter fitted/ air pressure excessively low.

SRS airbag system warning



SRS airbag system and/ or seatbelt pretensioners malfunction.

Power steering warning



The electric power steering system malfunction.

AT OIL TEMP warning (CVT models)



Transmission fluid temperature is too hot./Transmission control system malfunction.

Door open warning



Any door or the rear gate (5-door) is not fully closed.

Low fuel warning



Fuel tank is nearly empty. Refill fuel immediately.

Brake system warning



Parking brake on/Low brake fluid level/ EBD System malfunction. (Anti-lock Brake System warning light illuminates simultaneously)

Windshield washer fluid warning



The fluid level in the windshield washer fluid tank decreases to the lower limit.

Access key warning



The access key is not inside the vehicle. For other situations, refer to your Owner's Manual.

Automatic headlight beam leveler warning



Automatic headlight beam leveler malfunction.

ABS warning



Anti-lock Brake System malfunction/EBD System malfunction (Brake System warning light illuminates simultaneously).

BSD/ RCTA warning



Blind Spot Detection/Rear Cross Traffic Alert (BSD/ RCTA) malfunction.

Hill start assist warning/ Hill start assist OFF indicator



Warning : Hill start assist system malfunction.
Indicator : Hill start assist system OFF.

Vehicle Dynamics Control warning/ Vehicle Dynamics Control operation indicator



Warning : Vehicle Dynamics Control system malfunction.
Indicator : Flashes during activation of the skid suppression function and the traction control function.

Steering responsive fog lights warning/ Steering responsive fog lights OFF indicator



Warning : The steering responsive fog lights system malfunction.
Indicator : The steering responsive fog lights system is deactivated.











Coolant temperature low indicator/ Coolant temperature high warning



Illumination in BLUE : Insufficient warming up of the engine.
Illumination/blinking in RED : Engine overheating/ almost overheating.
Blinking in RED and BLUE alternately : Electrical system malfunction.

Indicator lights

The following indicators show the current status of your car. Refer to your Owner's Manual for more information.

 Turn signal indicator	 Headlight indicator	 High beam indicator
 Front fog light indicator	 Security indicator	 BSD/RCTA OFF indicator
 Front passenger's frontal airbag ON/OFF indicators	 Vehicle Dynamics Control OFF indicator	
 Cruise control indicator	 Cruise control set indicator	

subaru.ca

All illustrations, specifications, features and photographs contained in this brochure are based on product information available at the time of its printing, and may not be completely accurate following its publication. Colours shown may vary due to reproduction variations in the printing process, and some vehicle parts cannot be shown in certain photographs. Subaru Canada, Inc. reserves the right to discontinue or make changes at any time, without notice or incurring obligations, to colours, materials, equipment, accessories, features, specifications and models, or to change their prices. Please visit our Web site for the latest information and specifications. For detailed operating and safety information, please consult your Owner's Manual. For complete details on product updates, warranties or the Subaru C.A.R.E. program, please contact your Subaru dealer. Impreza and Subaru are registered trademarks. Printed in Canada. © 2015 Subaru Canada, Inc. 2016 model year.



Environmental Management System (EMS)
ISO 14001:2004 certified by SGS
www.subaru-earth.com

SUBARU CANADA, INC. / FUJI HEAVY INDUSTRIES LTD.