

Pressure Control Solenoid Valve

EMISSION CONTROL (AUX. EMISSION CONTROL DEVICES)

12. Pressure Control Solenoid Valve

A: REMOVAL

- 1) Set the vehicle on a lift.
- 2) Disconnect the ground cable from the battery.

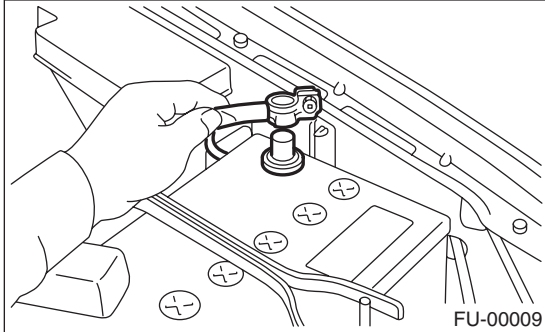

- 3) Lift-up the vehicle.
- 4) Remove the canisters. <Ref. to EC (H4DOTC)-7, REMOVAL, Canister.>
- 5) Remove the bolt which installs the pressure control solenoid valve holding bracket to the body.

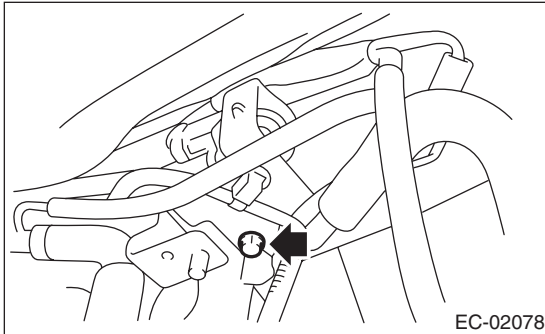

- 6) Disconnect the connector from the pressure control solenoid valve.

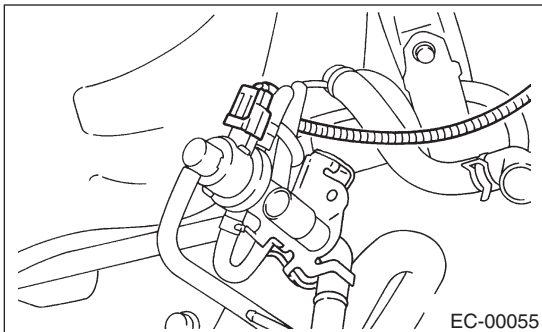

- 7) Disconnect the two evaporation hoses from the pressure control solenoid valve.

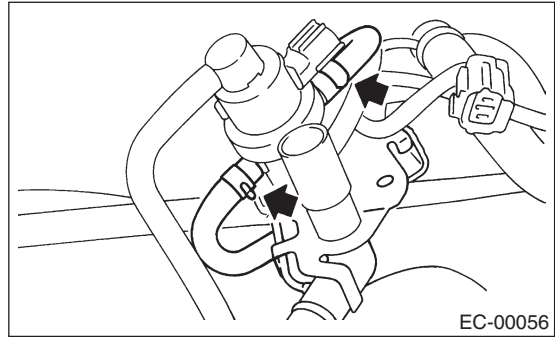

- 8) Remove the pressure control solenoid valve from the bracket.

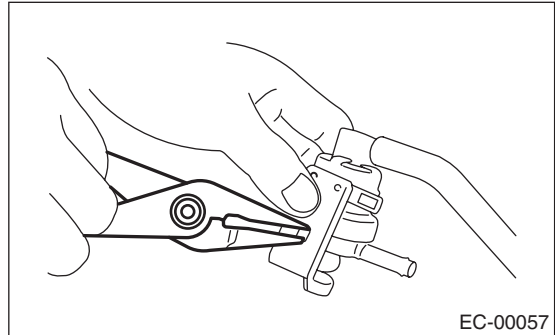

- 9) Disconnect the hose from the pressure control solenoid valve.

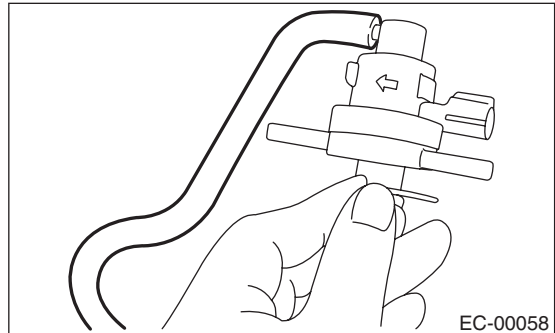

Pressure Control Solenoid Valve

EMISSION CONTROL (AUX. EMISSION CONTROL DEVICES)

B: INSTALLATION

Install in the reverse order of removal.

Tightening torque:

25 N·m (2.5 kgf-m, 18.4 ft-lb)

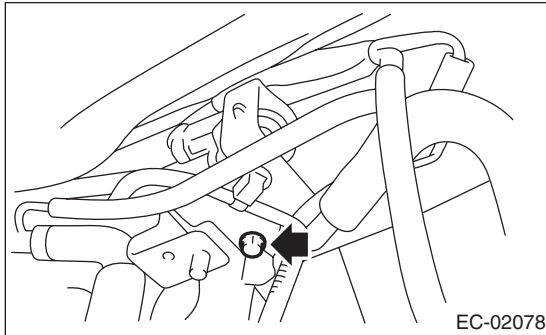

C: INSPECTION

Make sure the hoses are not cracked or loose.