

# Secondary Air Combi Valve

EMISSION CONTROL (AUX. EMISSION CONTROL DEVICES)

## 7. Secondary Air Combi Valve

### A: REMOVAL

#### 1. SECONDARY AIR COMBINATION VALVE LH

1) Disconnect the ground cable from the battery.

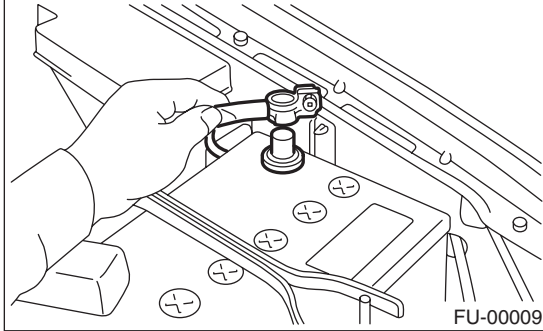

2) Remove the intercooler. <Ref. to IN(H4DOTC)-11, REMOVAL, Intercooler.>

3) Disconnect the connector from the secondary air combination valve LH.

4) Disconnect the air duct.

5) Disconnect the pipe LH.

6) Remove the secondary air combination valve LH.

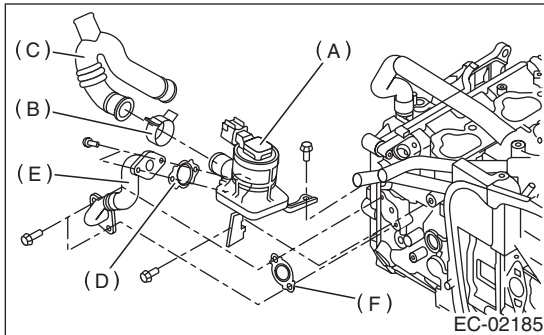

- (A) Secondary air combination valve LH
- (B) Clamp
- (C) Air duct
- (D) Gasket
- (E) Pipe LH
- (F) Gasket

#### 2. SECONDARY AIR COMBINATION VALVE RH

1) Disconnect the ground cable from the battery.

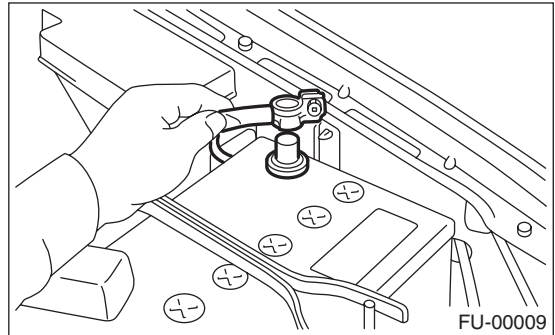

2) Remove the intercooler. <Ref. to IN(H4DOTC)-11, REMOVAL, Intercooler.>

3) Remove the secondary air combination valve LH. <Ref. to EC (H4DOTC)-10, SECONDARY AIR COMBINATION VALVE LH, REMOVAL, Secondary Air Combi Valve.>

4) Remove the intake manifold. <Ref. to FU(H4DOTC)-14, REMOVAL, Intake Manifold.>

5) Disconnect the connector from the secondary air combination valve RH.

6) Disconnect the pipe RH.

7) Remove the secondary air combination valve RH.

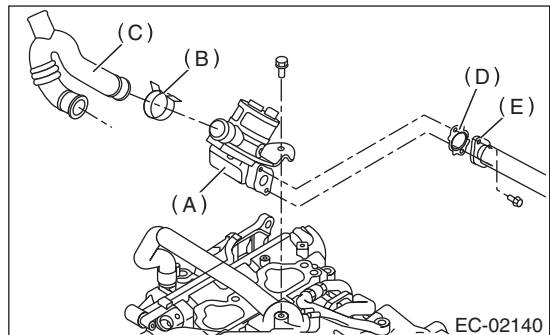

- (A) Secondary air combination valve RH
- (B) Clamp
- (C) Air duct
- (D) Gasket
- (E) Pipe RH

# Secondary Air Combi Valve

EMISSION CONTROL (AUX. EMISSION CONTROL DEVICES)

## B: INSTALLATION

### 1. SECONDARY AIR COMBINATION VALVE LH

Install in the reverse order of removal.

NOTE:

Use a new gasket.

**Tightening torque:**

**T1: 9 N·m (0.9 kgf-m, 6.6 ft-lb)**

**T2: 19 N·m (1.9 kgf-m, 13.7 ft-lb)**

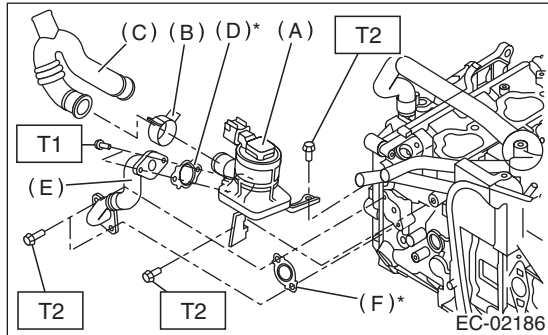

- (A) Secondary air combination valve LH
- (B) Clamp
- (C) Air duct
- (D) Gasket
- (E) Pipe LH
- (F) Gasket

### 2. SECONDARY AIR COMBINATION VALVE RH

Install in the reverse order of removal.

NOTE:

Use a new gasket.

**Tightening torque:**

**T1: 9 N·m (0.9 kgf-m, 6.6 ft-lb)**

**T2: 19 N·m (1.9 kgf-m, 13.7 ft-lb)**

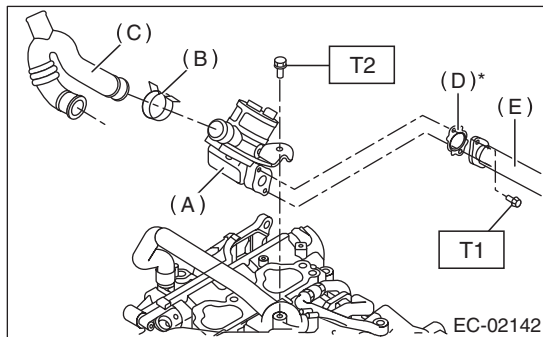

- (A) Secondary air combination valve RH
- (B) Clamp
- (C) Air duct
- (D) Gasket
- (E) Pipe RH

## C: INSPECTION

Check the air duct and pipe for looseness.