REAR AXLE

CONTENTS

GENERAL INFORMATION	2	Hub Axial Play Check	3
SERVICE SPECIFICATIONS	2	Rear Hub Rotary-Sliding Resistance Check	3
SPECIAL TOOLS	2	Hub Bolt Replacement	4
ON-VEHICLE SERVICE	3	REAR HUB ASSEMBLY	5
		KNUCKLE	7

GENERAL INFORMATION

The rear axle consists of a knuckle, rear hub, unit bearing and axle shaft. The unit bearing is press-fitted to the rear axle shaft and bolted to the knuckle. The unit bearing utilises the double row angular con-

tact ball bearing type. For ABS operation, a rotor is located on the rear axle shaft, and a speed sensor is located on the knuckle to detect vehicle speed.

SECTIONAL VIEW

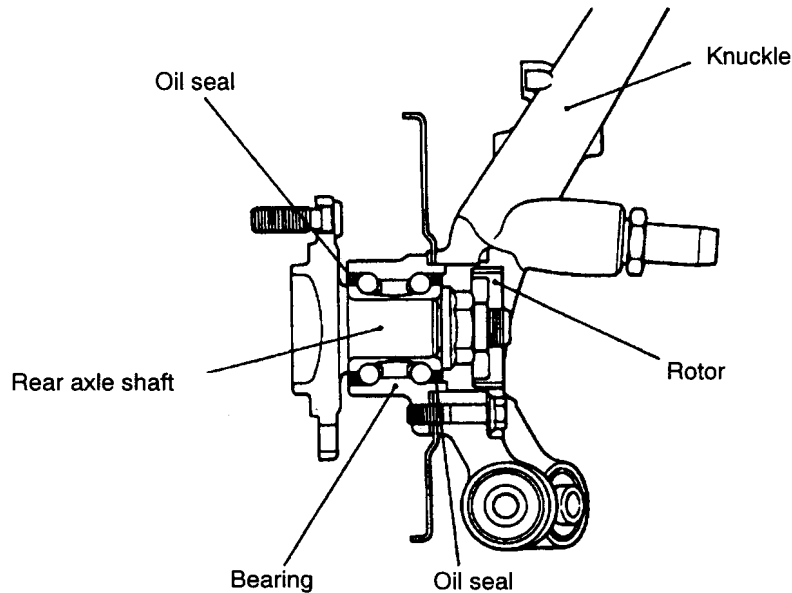

23TE001A

SERVICE SPECIFICATIONS

Items	Limit
Wheel bearing axial play mm	0.05
Wheel bearing rotary-sliding resistance N	18 or less

SPECIAL TOOLS

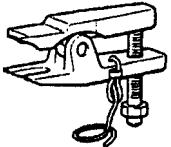
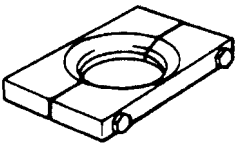
Tool	Number	Name	Use
	MB991113	Steering linkage puller	Toe control arm ball joint and knuckle removal
	MB991248	Inner shaft remover	ABS rotor removal

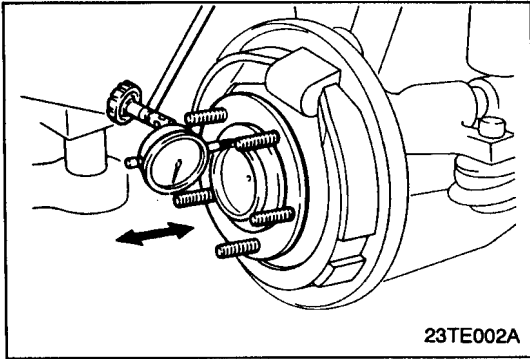

ON-VEHICLE SERVICE

HUB AXIAL PLAY CHECK

1. Remove the calliper assembly and the brake disc.
2. Check the hub axial play
Place a dial gauge against the hub surface; then move the hub in the axial direction and check whether or not there is axial play.

Limit: 0.05 mm

3. If the play exceeds the limit value, replace the rear hub assembly.

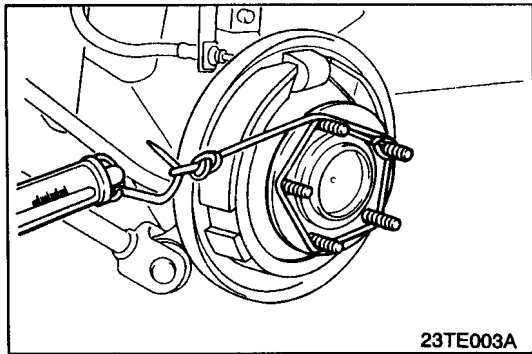

REAR HUB ROTARY-SLIDING RESISTANCE CHECK

1. Remove the calliper assembly and the brake disc.
2. After turning the hub a few times to seat the bearing, wind a cord around the hub bolt and turn the hub by pulling at a 90° angle with a spring balance. Measure to determine whether or not the rotary-sliding resistance of the rear hub is at the limit value.

Limit: 18 N or less

3. If the rotary-sliding resistance exceeds the limit value, replace the rear hub assembly.

HUB BOLT REPLACEMENT

1. Remove the calliper assembly and support it with wire so that it does not fall.
2. Remove the brake disc.
3. Remove the parking brake shoe and lining assembly.

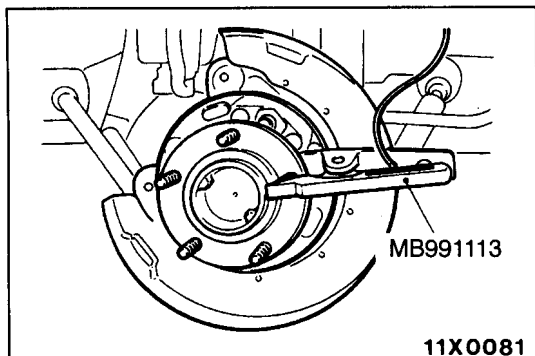

4. Pull the hub bolt out using the special tool.

Caution

The special tool should be suspended by a cord to prevent it from coming off.

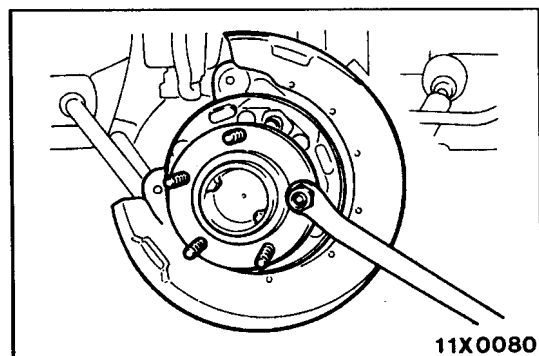

5. Use the wheel nuts to securely install the new hub bolts, ensuring they are seated correctly.

**REAR HUB ASSEMBLY
REMOVAL AND INSTALLATION**

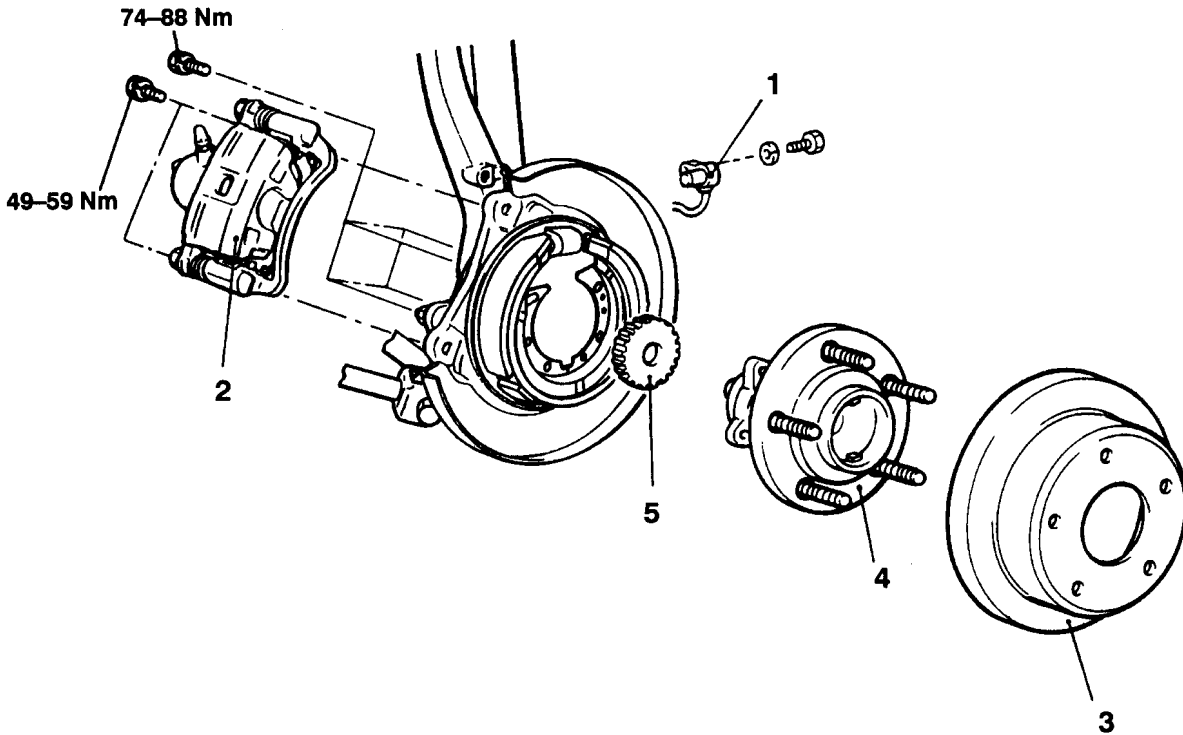

23TE004A

Removal steps

1. Rear speed sensor (Refer to GROUP 35B – Wheel Speed Sensor.)
2. Calliper assembly
3. Brake disc



4. Rear hub assembly
5. Rotor

Caution

The rear hub assembly should not be disassembled.

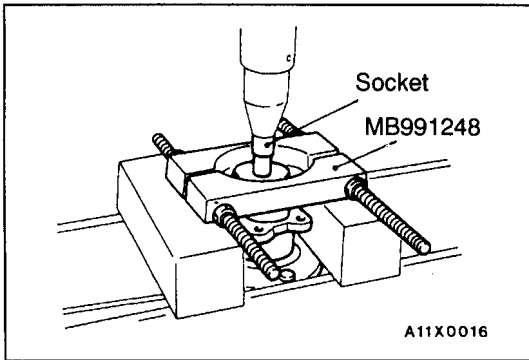
**REMOVAL SERVICE POINTS****◀A▶ CALLIPER ASSEMBLY REMOVAL**

Remove the calliper assembly and suspend it with wire to an adjacent part to ensure no load is placed on the brake hose.

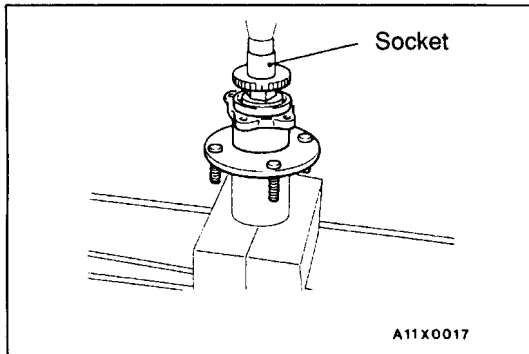
◀B▶ ROTOR REMOVAL**INSTALLATION SERVICE POINT****▶A◀ ROTOR INSTALLATION****INSPECTION**

- Check the oil seal for crack or damage.
- Check the rear rotor for chipped teeth.

KNUCKLE

REMOVAL AND INSTALLATION

Pre-removal and Post-installation Operation
 (1) Rear Speed sensor Removal and Installation
 (Refer to GROUP 35B – Wheel Speed Sensor.)
 (2) Rear Hub Assembly Removal and Installation
 <Refer to P. 27-5.>

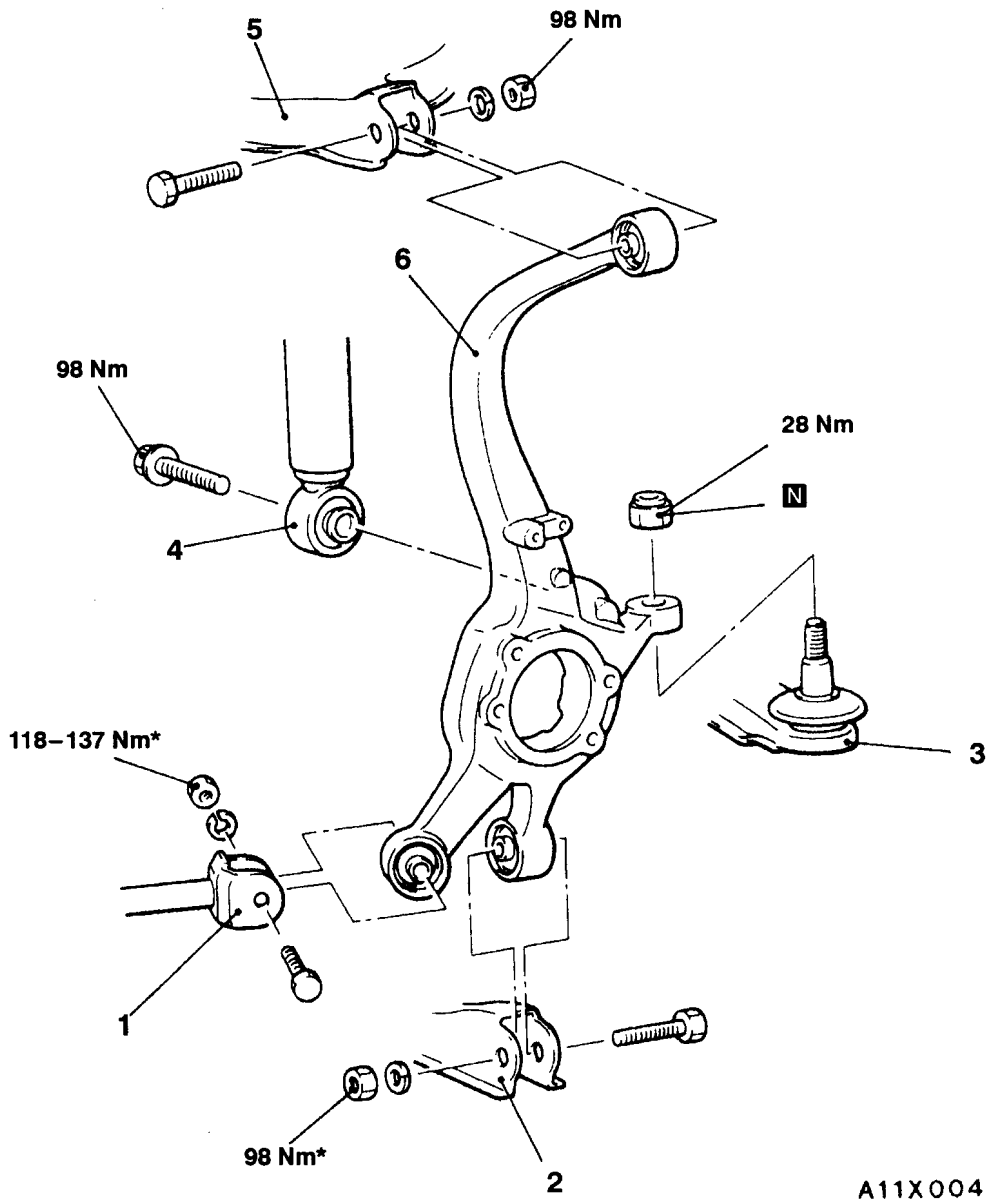

A11X0042

Removal steps

1. Connection for trailing arm
2. Connection for lower arm
3. Connection for toe control arm
4. Connection for shock absorber
5. Connection for upper arm

6. Knuckle

Caution

*: Indicates parts which should be temporarily tightened, and then fully tightened with the vehicle on the ground in the unladen condition.

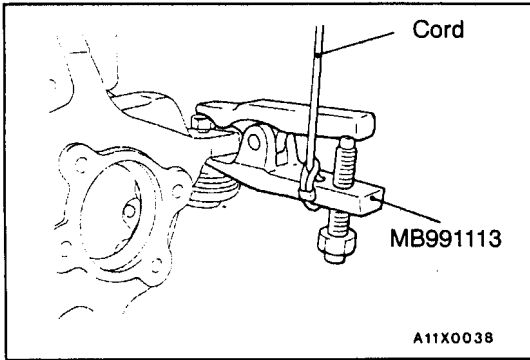

**REMOVAL SERVICE POINT****◀A▶ TOE CONTROL ARM REMOVAL****Caution**

1. Be sure to tie the cord of the special tool to the nearby part.
2. Loosen the nut but do not remove it.