

POWER PLANT MOUNT

CONTENTS

E32AA--

SPECIFICATIONS	2	ENGINE ROLL STOPPER AND ENGINE DAMPER	5
Service Specifications	2		
SPECIAL TOOLS	2	RIGHTMEMBER, LEFTMEMBER AND CROSSMEMBER*	6
ENGINE MOUNTING	3		
TRANSMISSION MOUNTING	4		

WARNINGS REGARDING SERVICING OF SUPPLEMENTAL RESTRAINT SYSTEM (SRS) EQUIPPED VEHICLES

WARNING!

- (1) Improper service or maintenance of any component of the SRS, or any SRS-related component, can lead to personal injury or death to service personnel (from inadvertent firing of the air bag) or to the driver and passenger (from rendering the SRS inoperative).
- (2) Service or maintenance of any SRS component or SRS-related component must be performed only at an authorized MITSUBISHI dealer.
- (3) MITSUBISHI dealer personnel must thoroughly review this manual, and especially its GROUP 52B – Supplemental Restraint System (SRS) before beginning any service or maintenance of any component of the SRS or any SRS-related component.

NOTE

The SRS includes the following components: impact sensors, SRS diagnosis unit, SRS warning lamp, air bag module, clock spring and interconnecting wiring. Other SRS-related components (that may have to be removed/installed in connection with SRS service or maintenance) are indicated in the table of contents by an asterisk (*).

SPECIFICATIONS

SERVICE SPECIFICATIONS

E32CB--

Items	Specifications
Standard Value	
No.1 crossmember	
Bushing (B) projection	mm (in.) 9.0±1.5 (0.35±0.06)
Crossmember	
Bushing (A) projection	mm (in.) 9.7 ^{+0.5} _{-2.5} (0.38 ^{+0.02} _{-0.1})
Bushing (B) projection	mm (in.) 9.0 ^{+0.5} _{-2.5} (0.35 ^{+0.02} _{-0.1})

SPECIAL TOOLS

E32DA--

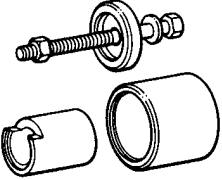
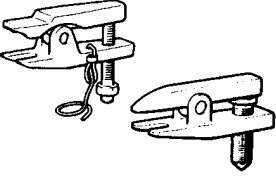
Tool	Number	Name	Use
	MB991045	Bushing remover and installer	Removal and installation of the crossmember bushing
	MB990635 or MB991113	Steering linkage puller	Removal of the ball joint

ENGINE MOUNTING

REMOVAL AND INSTALLATION

E32JA-

<SOHC>

Pre-removal Operation

- Jack up the engine transmission assembly so that the weight is taken off the engine mounts.

<DOHC>

01N0075

Removal steps

1. Reserve tank <Vehicles with ABS or headlamp washer>
2. Reserve tank bracket <Vehicles with ABS or headlamp washer>
3. Engine mount bracket attachment nut
4. Engine mount insulator mounting bolt attachment nut
5. Engine mount insulator mounting bolt
6. Engine mount bracket
7. Engine mount stopper
8. Dynamic damper

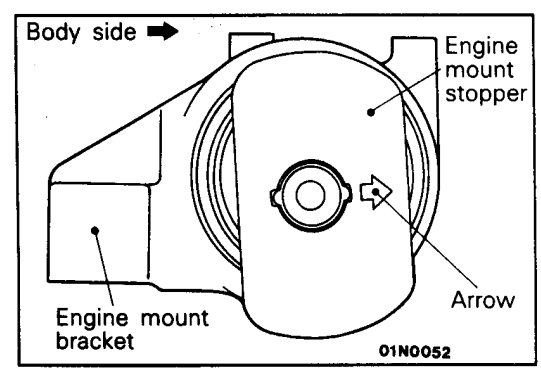

INSPECTION

E22JCAB

- Check each insulator for cracks or damage.
- Check each bracket for deformations or damage.

SERVICE POINTS OF INSTALLATION

E32JDCE

7. INSTALLATION OF ENGINE MOUNT STOPPER

Clamp the engine mount stopper so that the arrow points in the direction as shown in the diagram.

TRANSMISSION MOUNTING

REMOVAL AND INSTALLATION

E32KA--

Pre-removal Operation

- Jack up the engine transmission assembly so that the weight is taken off the engine mounts.
- Removal of the Air Cleaner

Post-installation Operation

- Installation of the Air Cleaner

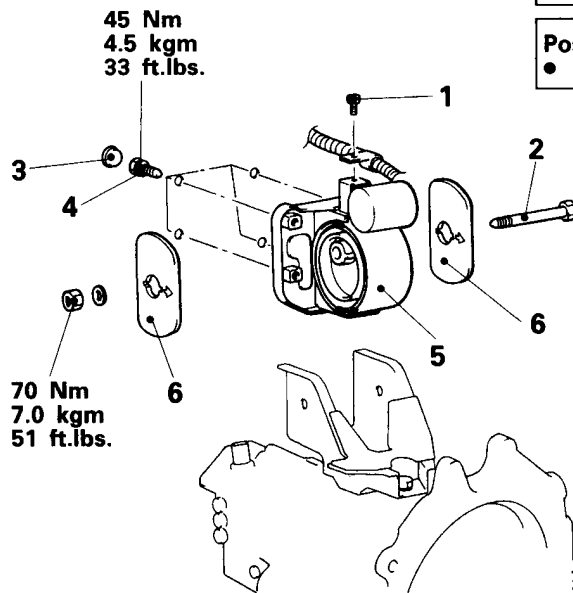

01N0039

Removal steps

1. Engine harness attachment bolt
2. Transmission mount insulator attachment bolt
3. Cap
4. Transmission mount attachment bolt
5. Transmission mount bracket
6. Transmission mount stopper

**SERVICE POINTS OF REMOVAL**

E32KBAC

4. REMOVAL OF TRANSMISSION MOUNT ATTACHMENT BOLT

Remove the transmission mount attachment bolt, making sure that it doesn't fall inside the fender shield.

INSPECTION

E32KCAB

- Check each insulator for cracks or damage.
- Check each bracket for deformation or damage.

SERVICE POINTS OF INSTALLATION

E32KDAC

6. INSTALLATION OF TRANSMISSION MOUNT STOPPER

Clamp the transmission mount stopper so that the arrow points in the direction as shown in the diagram.

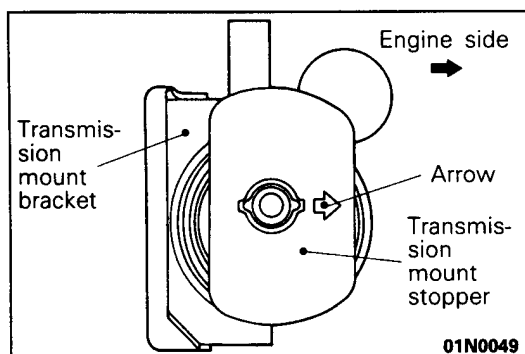

01N0049

ENGINE ROLL STOPPER AND ENGINE DAMPER

REMOVAL AND INSTALLATION

E32SA--

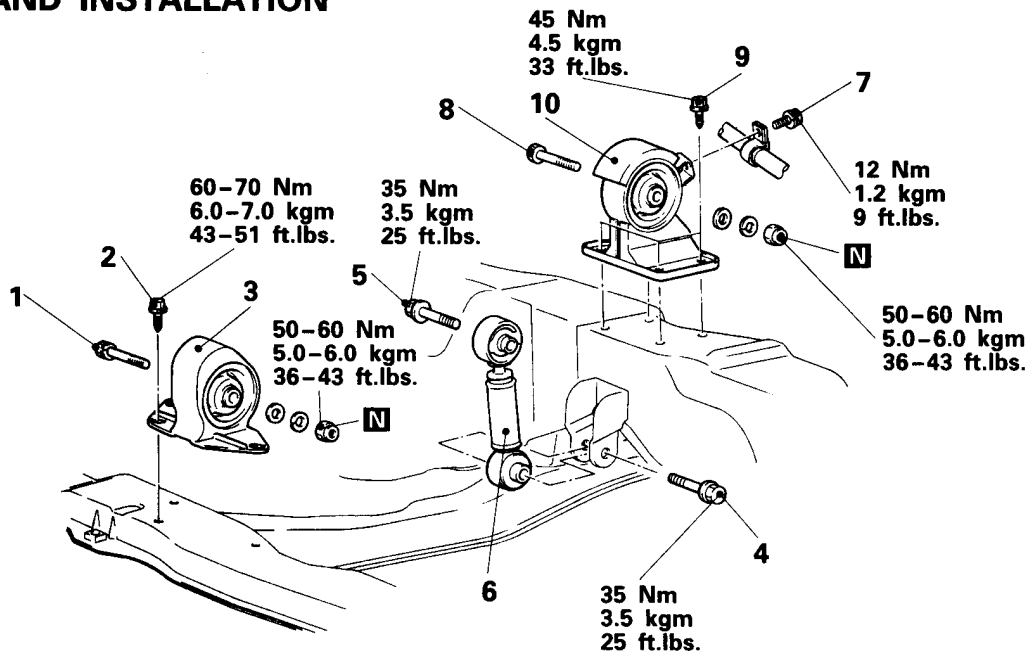

01N0037

Removal steps for front roll stopper

1. Front roll stopper attachment bolt (engine side)
2. Front roll stopper attachment bolt (No.1 crossmember side)
3. Front roll stopper

Removal steps for engine damper

4. Engine damper lower attachment bolt
5. Engine damper upper attachment bolt
6. Engine damper

Removal steps for rear roll stopper

7. Hose installation bolt
<R.H. drive vehicles and L.H. drive vehicles with 4WS>
8. Rear roll stopper attachment bolt (engine side)
9. Rear roll stopper attachment bolt (crossmember side)
10. Rear roll stopper

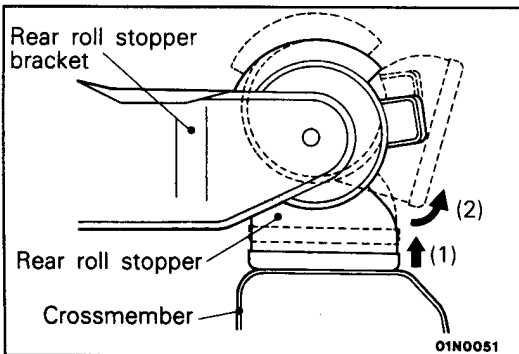

SERVICE POINTS OF REMOVAL

E32SBAA

10. REMOVAL OF REAR ROLL STOPPER

- (1) Lift the rear roll stopper slightly upwards.
- (2) Pull out the rear roll stopper by turning in the direction as shown in the diagram.

INSPECTION

E32SCAA

- Check each insulator for cracks or damage.
- Check each bracket for deformation or damage.
- Operation of the engine damper shock absorber.

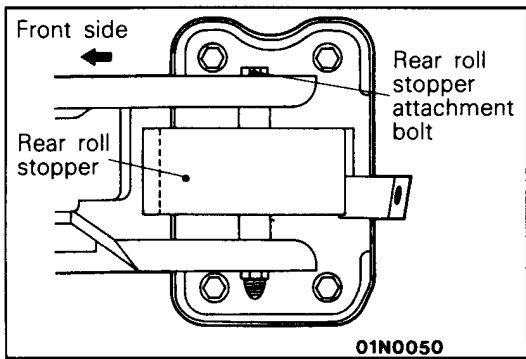

SERVICE POINTS OF INSTALLATION

E32SDAA

10. INSTALLATION OF REAR ROLL STOPPER/8. REAR ROLL STOPPER ATTACHMENT BOLT (ENGINE SIDE)

- (1) Install the rear roll stopper, facing as shown in the diagram.
- (2) Clamp the rear roll stopper installation bolt (engine side) in the direction as shown in the diagram.

**RIGHTMEMBER, LEFTMEMBER AND CROSSMEMBER
REMOVAL AND INSTALLATION**

E32TA--

Removal steps for No.1 crossmember, leftmember and rightmember

1. Cover attachment clip
2. Leftmember
3. Rightmember
4. Front roll stopper attachment bolt
5. No.1 crossmember attachment nut
6. Lower plate
7. No.1 crossmember
8. Stopper B
9. Bush B

Pre-removal Operation

- Removal of the Under Cover

Post-installation Operation

- Air Bleeding from Power Steering Fluid (Refer to GROUP 37A - Service Adjustment Procedures.)
- Checking of NORMAL Vehicle Height <Vehicles with ECS> (Refer to GROUP 33B - Service Adjustment Procedures.)
- Installation of the Under Cover

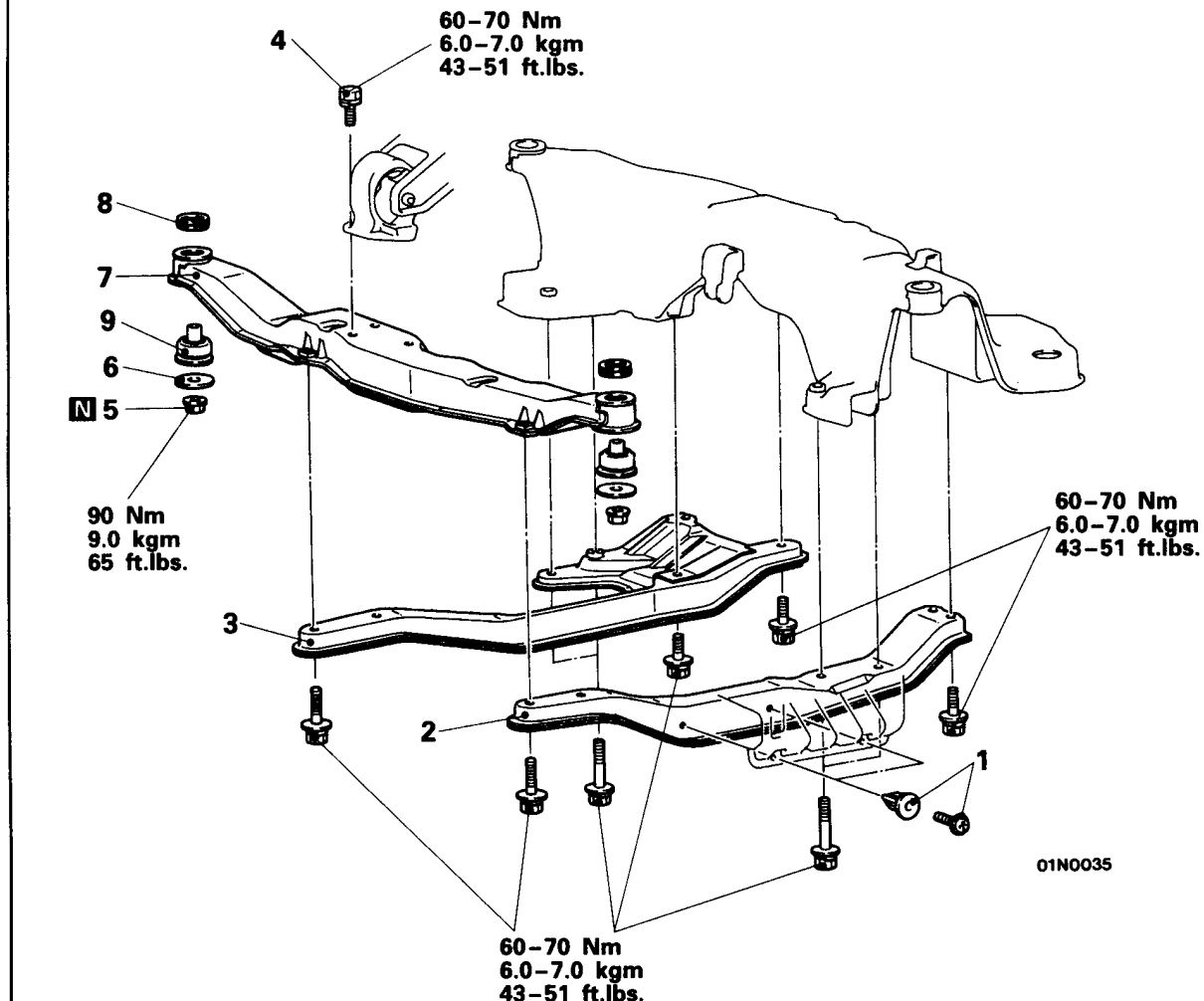

CAUTION: SRS

For vehicles with SRS, before removal of steering gear box, refer to GROUP 52B – SRS, center front wheels and remove ignition key. Failure to do so may damage SRS clock spring and render SRS system inoperative, risking serious driver injury.

Removal steps for crossmember

- Front exhaust pipe (Refer to GROUP 15 – Exhaust Pipe and Muffler)
- Front height sensor <Vehicles with ECS> (Refer to GROUP 33B – Front and Rear Height Sensors)
- Stabilizer bar (Refer to GROUP 33A – Stabilizer Bar)
- Steering gear box (Refer to GROUP 37A – Power Steering Gear and Linkage)
- 10. Clamp attachment nut
- 11. Clamp attachment bolt (small)
- 12. Clamp attachment bolt (large)
- 13. Clamp
- 14. Lower arm shaft
- 15. Stopper
- 16. Rear roll stopper lower attachment bolt
- 17. Engine damper lower attachment bolt
- 18. Crossmember attachment nut
- 19. Lower plate
- 20. Crossmember attachment nut
- 21. Lower plate
- 22. Crossmember
- 23. Stopper B
- 24. Stopper A
- 25. Bush B
- 26. Bush A

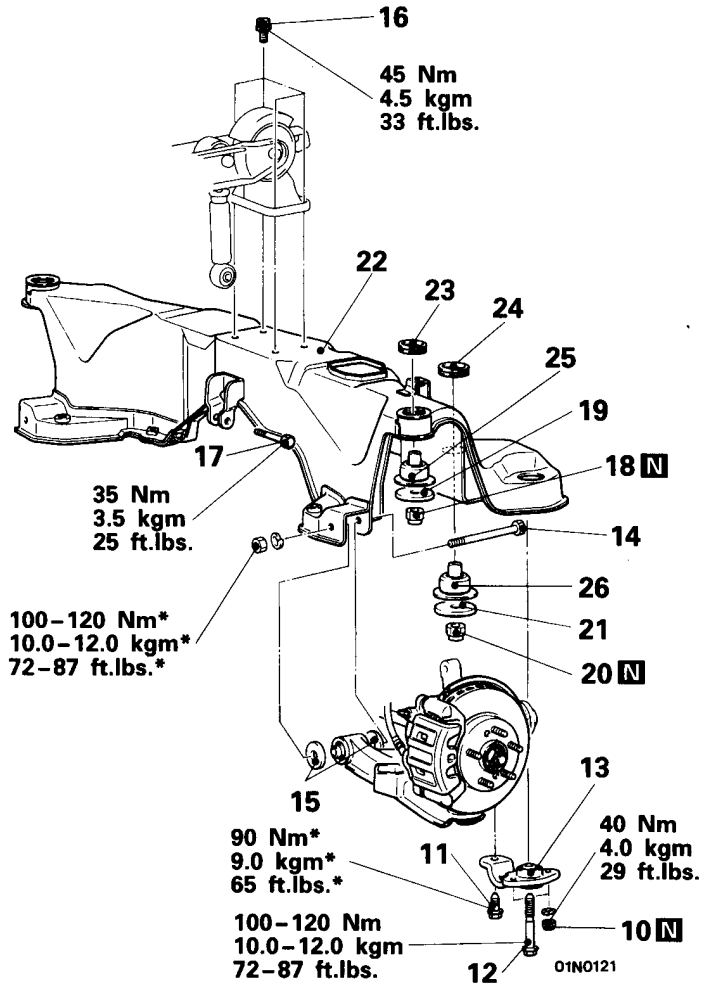

Caution

*: Indicates parts which should be temporarily tightened, and then fully tightened with the vehicle on the ground in the unladen condition.

32-8 POWER PLANT MOUNT – Rightmember, Leftmember and Crossmember

INSPECTION

E32TBAA

- Check the crossmember for cracks or deformation.
- Check the bushings for cracks or deterioration.
- Check the rightmember for cracks or deformation.
- Check the leftmember for cracks or deformation.

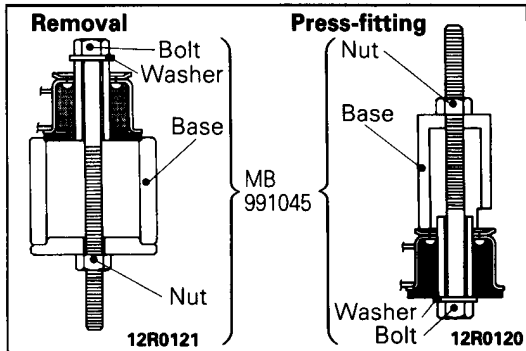

BUSHING REPLACEMENT

E32TCAA

- (1) Apply soapy water to the contact surface of the bush when press-fitting the bush.

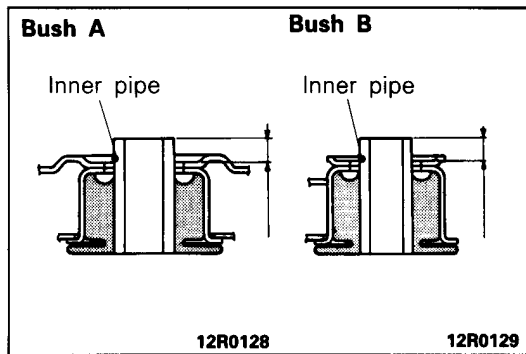

- (2) The bush should be press-fitted so that the inner pipe projection is at the standard length.

Standard values

No.1 crossmember

Bush B: 9.0 ± 1.5 mm (0.35 ± 0.06 in.)

Crossmember

Bush A: $9.7 \begin{smallmatrix} +0.5 \\ -2.5 \end{smallmatrix}$ mm ($0.38 \begin{smallmatrix} +0.02 \\ -0.1 \end{smallmatrix}$ in.)

Bush B: $9.0 \begin{smallmatrix} +0.5 \\ -2.5 \end{smallmatrix}$ mm ($0.35 \begin{smallmatrix} +0.02 \\ -0.1 \end{smallmatrix}$ in.)